

- PARKING LEGEND**
- ⊕ NUMBER OF STALLS IN ROW
 - c COMPACT STALL

The Village ARTwalk

The Village ARTwalk will feature numerous forms of art, sculpture and photography created by members of the Tukwila art community. The Village ARTwalk will be primarily displayed at the intersection of S 144th Street and Tukwila International Blvd. The ARTwalk will be a series of photographs that are unique to the various cultures represented in this community. This could include the Foster High School art program and other local or regional art programs such as King County's "Culture" programs. ARTwalk guide brochures can be produced for each new exhibit, illustrate the locations of the various art and sculpture work along with a description of the piece and a bio about the artist that created them. The ARTwalk work will be related on a schedule determined by the community management group. The work will be a combination of temporary and permanent installations.

The Owner has enlisted the services of SEEDMz (Southeast Effective Development) to assist in the implementation of the ARTwalk concept by generating thematic ideas and concepts for art elements, identifying potential site locations and features that would be appropriate for incorporation of art, and identifying potential local artists to create the various art works.



Issue Dates	Date	Desc.
Rev	05/28/13	010 REVISION
	06/10/13	PLAZA REVISION
	09/27/13	STAFF COMMENTS

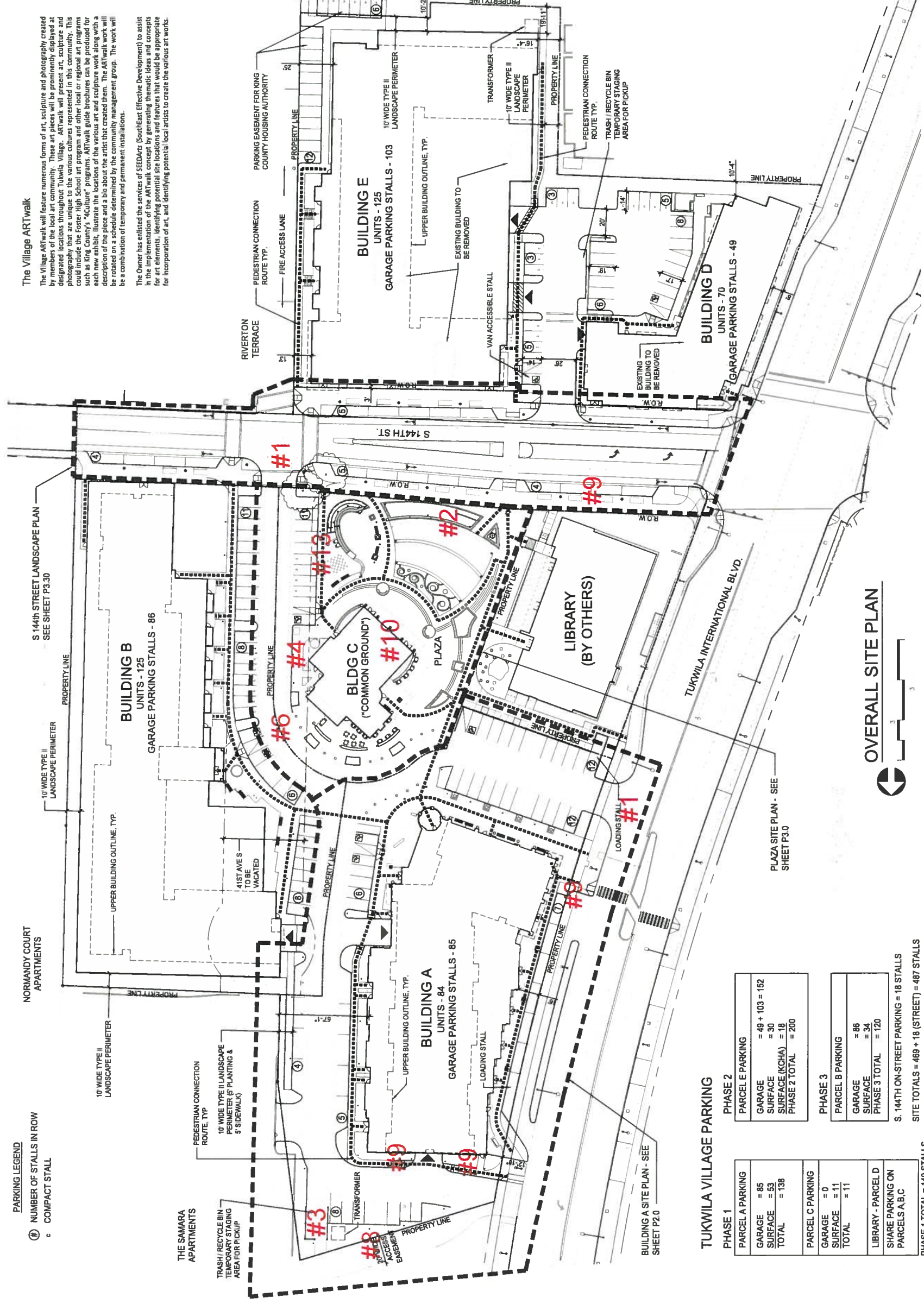

TUKWILA VILLAGE PARKING

PHASE 1	
PARCEL A PARKING	
GARAGE	= 85
SURFACE	= 53
TOTAL	= 138
PARCEL C PARKING	
GARAGE	= 0
SURFACE	= 11
TOTAL	= 11
LIBRARY - PARCEL D	
SHARE PARKING ON PARCELS A,B,C	
PHASE 1 TOTAL	= 149 STALLS

PHASE 2	
PARCEL E PARKING	
GARAGE	= 48 + 103 = 152
SURFACE	= 30
SURFACE (KCHA)	= 18
PHASE 2 TOTAL	= 200
PHASE 3	
PARCEL B PARKING	
GARAGE	= 86
SURFACE	= 34
PHASE 3 TOTAL	= 120

S. 144TH ON-STREET PARKING = 18 STALLS
 SITE TOTALS = 469 + 18 (STREET) = 487 STALLS

OVERALL SITE PLAN



TUKWILA VILLAGE
 TUKWILA INTERNATIONAL BOULEVARD & 144TH STREET,
 TUKWILA, WA
 OWNER APPLICANT:
 TUKWILA VILLAGE DEVELOPMENT ASSOCIATES, LLC
 201 - 27TH AVENUE SE, BUILDING A, SUITE 300
 FALLEN LEAF, WA 98148
 T (206) 231-5001 F (206) 231-5010
 WITHOUT THEIR WRITTEN CONSENT © 2013 The Last Studio, LLC
 COPYRIGHT: USE OF THIS DRAWING WITHOUT AUTHORIZATION OF THE LAST STUDIO, LLC IS PROHIBITED.

PROJECT # : LA-113
 FILE NAME : 113_010
 DRAWN BY : CPH/MB

OVERALL SITE PLAN

BAR SUBMITTAL

Site Plan showing location of conditions #5,7, 11 and 12 are not shown on this plan)