

ADDENDUM NO. 3

City of Tukwila, Washington S Boeing Access Road over Airport Way Bridge Seismic Retrofit Project

City Project No.: 91310407

DATE OF ADDENDUM ISSUE: March 31, 2020

DATE OF BID OPENING: April 7, 2020

NOTE TO ALL PLANHOLDERS:

This Addendum No. 3, containing the following revisions, additions, deletions, and/or clarifications, is hereby made a part of the Plans and Contract Provisions (Contract Documents) for the above-named project. Bidders shall take this Addendum into consideration when preparing and submitting their bids.

Bidders shall acknowledge receipt and acceptance of this Addendum No. 3 in the space provided on the Proposal Signature Sheet or by signing in the space provided below and submitting the signed addendum with the bid package. Failure to provide this written acknowledge may result in disqualification of the Bidder's submittal.

PROPOSAL

1. Proposal Page I-1: CALL FOR BIDS is replaced with the following:

NOTICE IS HEREBY GIVEN that clearly marked sealed bids shall be received no later than 9:30 a.m. on Tuesday, April 7, 2020. Due to issues associated with COVID-19 and social distancing, Tukwila City Hall is not open to the public. While bids can be mailed to Tukwila City Hall, a box will also be located outside the double doors at Tukwila City Hall near the flagpole for receipt of bids on the day of the bid opening. Bids will be picked up, with the last pickup being at exactly 9:31 a.m. on Tuesday, April 7, 2020 based on the Atomic Clock in the City Clerk's Office.

Proposals received later than the submittal deadline will not be accepted. The City will not be liable for delays in delivery of proposals due to handling by the U.S. Postal Service or any other type of delivery service. Faxed or e-mailed submittals will not be accepted. Per Addendum #2, the public will be able to hear the bids read aloud via Skype or telephone. To access the bid opening via Skype, please dial (253) 292-9750, Conference ID: 898726483#.

2. Proposal Page I-5, Section 11 is added as follows:

11. Limited Notice to Proceed (NTP)

A Limited Notice to Proceed (NTP) will be issued for this project. The intent of the Limited NTP is to accomplish two critical path items: (1) procurement of steel column jackets, including all associated field measurement work; and (2) construction of the approach slabs.

The purpose of the Limited NTP is to account for the long lead time for the steel column jacket procurement and to begin construction of the approach slabs quickly in order to take advantage of the potential light traffic conditions caused by the COVID-19 social distancing measures.

An NTP for the remaining work will be issued after completion of the work described in the Limited NTP.

SPECIAL PROVISIONS

1. Page SP-63: 1-08.6 Suspension of Work, add the following prior to Section 1-08.8 Extensions of Time:

(January 2, 2018 WSDOT GSP)

Supplement

Contract time may be suspended for procurement of critical materials (Procurement Suspension). In order to receive a Procurement Suspension, the Contractor shall within 21 calendar days after execution by the Contracting Agency, place purchase orders for all materials deemed critical by the Contracting Agency for physical completion of the contract. The Contractor shall provide copies of purchase orders for the critical materials. Such purchase orders shall disclose the purchase order date and estimated delivery dates for such critical material.

The Contractor shall show procurement of the materials listed below as activities in the Progress Schedule. If the approved Progress Schedule indicates that the materials procurement are critical activities, and if the Contractor has provided documentation that purchase orders are placed for the critical materials within the prescribed 21 calendar days, then contract time will be suspended upon physical completion of all critical work except that work dependent upon the below listed critical materials:

*** Steel column jackets ***

Charging of contract time will resume upon delivery of the critical materials to the Contractor or 120 calendar days after execution by the Contracting Agency, whichever occurs first.

2. Page SP-84: 6-02.4 Measurement, add the following prior to Section 6-02.5 Payment:

All costs associated with the work required for concrete column repair prior to steel column jacketing installation, including all costs associated with furnishing structural repair concrete, shall be considered incidental to the lump sum contract price for "Column Jacketing - _____".

PLANS

1. Plan Sheet 4 of 23:

DELETE Sheet 4 of 23 and REPLACE with the attached Sheet 4 of 23.

The following changes have been made:

- Note 19 added to General Notes.
- Construction Note 11 revised.

2. Plan Sheet 5 of 23:

DELETE Sheet 5 of 23 and REPLACE with the attached Sheet 5 of 23.

The following changes have been made:

- Additional detour signs added to Airport Way.
- Three PCMS signs added with coordinates for location.
- Arrow Board symbol added to the Legend.
- MOT contact list added.

3. Plan Sheet 7 of 23:

DELETE Sheet 7 of 23 and REPLACE with the attached Sheet 7 of 23.

The following changes have been made:

- Removed lane closure and associated devices east of Southbound I-5 Offramp in westbound lane.
- Revised distance in overhead sign add-on.

4. Plan Sheet 8 of 23:

DELETE Sheet 8 of 23 and REPLACE with the attached Sheet 8 of 23.

The following changes have been made:

- Removed lane closure and associated devices east of Southbound I-5 Offramp in westbound lane.

5. Plan Sheet 9 of 23:

DELETE Sheet 9 of 23 and REPLACE with the attached Sheet 9 of 23.

The following changes have been made:

- Added signs and devices for lane closure of westbound Airport Way ramp.

6. Plan Sheet 10 of 23:

DELETE Sheet 10 of 23 and REPLACE with the attached Sheet 10 of 23.

The following changes have been made:

- Removed sand barrel with sign.
- Revised Detail B to include beacon.

7. Plan Sheet 12 of 23:

DELETE Sheet 12 of 23 and REPLACE with the attached Sheet 12 of 23.

The following changes have been made:

- Revised Overhead Sign Patches Detail to correct lane closure distance.

8. Plan Sheet 13 of 23:

DELETE Sheet 13 of 23 and REPLACE with the attached Sheet 13 of 23.

The following changes have been made:

- Proposed limits of shoring and excavation added.

9. Plan Sheet 18 of 23:

DELETE Sheet 18 of 23 and REPLACE with the attached Sheet 18 of 23.

The following changes have been made:

- Note 7 added addressing concrete column repair.

ALL OTHER REQUIREMENTS OF THE CONTRACT DOCUMENTS REMAIN IN EFFECT.

Bidders shall acknowledge receipt and acceptance of this Addendum No. 3 in the space provided on the Proposal Signature Sheet or by signing in the space provided below and submitting the signed addendum with the bid package. Failure to provide this written acknowledge may result in disqualification of the Bidder's submittal.

Sincerely,



Hari Ponnekanti, P.E.
City of Tukwila
City Engineer

Receipt acknowledge, and conditions agreed to this _____ day of _____, 2020

Bidder _____
Signature

ljensen 03/30/20 8:48pm - P:\2018\2018029 - Tukwila BAR_Airport Way Bridge Seismic Project\000 CAD\010 Drawing\C-Structural SheetC1.dwg

GENERAL NOTES:

1. A PROTECTIVE VEHICLE IS RECOMMENDED. IF A TRUCK MOUNTED ATTENUATOR (TMA) IS NOT AVAILABLE; A WORK VEHICLE MAY BE USED. WHEN NO TMA IS USED, THE PROTECTIVE VEHICLE SHALL BE STRATEGICALLY LOCATED TO SHIELD WORKERS, WITH MINIMUM REQUIRED ROLL-AHEAD DISTANCE.
2. DEVICES SHALL NOT ENCROACH INTO ADJACENT LANE.
3. FOR SIGNS REFER TO MANUAL ON UNIFORM TRAFFIC CONTROL DEVICES (MUTCD) AND WSDOT SIGN FABRICATION MANUAL W55-05.
4. ALL ADDITIONAL TRAFFIC CONTROL FOR THE PROJECT WHICH INCLUDES, BUT IS NOT LIMITED TO, LANE CLOSURES, FLAGGING OPERATIONS, INTERSECTION CLOSURES, DETOUR PLANS, LANE SHIFTS, AND SHOULDER CLOSURES, SHALL BE SUBMITTED TO THE CITY AND THE ENGINEER FOR APPROVAL 10 DAYS IN ADVANCE OF IMPLEMENTATION.
5. PCMS LOCATIONS ARE APPROXIMATE AND MAY BE ADJUSTED.
6. CONFLICTING PAVEMENT MARKINGS NO LONGER APPLICABLE MUST BE REMOVED OR OBLITERATED AS SOON AS POSSIBLE.
7. STEADY BURN WARNING LIGHTS (TYPE C. MUTCD) SHOULD BE USED ON CHANNELIZING DEVICES AT NIGHT FOR DELINEATION.
8. CONTRACTORS SHALL MAINTAIN DRIVEWAY ACCESS TO ADJACENT PROPERTY OWNERS WHERE TRAFFIC MUST ENTER AND EXIT AT DESIGNATED DRIVEWAYS FOR BUSINESS ACCESS, SUCH AS DRIVE THRU'S. THE CONTRACTOR SHALL KEEP ALL DRIVEWAYS OPEN TO TRAFFIC.
9. INSTALL TYPE III BARRICADE AND SIGN(S) PER WSDOT STANDARDS AND DETAIL B ON SHEET C7.
10. COVER EXISTING SIGNS IN PART OR COMPLETE AS SHOWN ON TRAFFIC CONTROL PLANS.
11. W-SERIES SIGNS WILL BE 36"x 36" UNLESS OTHERWISE NOTED.
12. BUSINESS ACCESS SIGNS WILL BE 12"x 24" AND BLACK ON WHITE.
13. M-SERIES SIGNS WILL BE 24"x 30" UNLESS OTHERWISE NOTED.
14. ALL SIGNS WILL BE BLACK ON ORANGE UNLESS OTHERWISE NOTED.
15. ALL SIDEWALK CLOSED SIGNS WILL BE BLACK ON WHITE 12"x 24".
16. FINAL TCP TO BE DETRMINED BY CONTRACTOR AND SUBMITTED TO CM FOR APPROVAL.
17. CONTRACTOR SHALL PROVIDE 11' OR 12' TRAFFIC CONTROL LANES, EXCEPT WHERE OTHERWISE APPROVED BY ENGINEER.
18. PRIOR TO CONSTRUCTION THE CONTRACTOR WILL PLAN AND COORDINATE ACTIVITIES WITH THE CITY. THE TCS WILL COORDINATE WITH THE BUSINESSES ADJACENT TO CONSTRUCTION.
19. WHERE APPROPRIATE, THE CONTRACTOR WILL COORDINATE WITH CITY AND WSDOT.

CHANNELIZING DEVICE SPACING

POSTED SPEED (MPH)	IN TAPER (FEET)	IN TANGENT (FEET)
50 / 60	40	80
35 / 45	30	60
25 / 30	20	40

SIGN SPACING = X (1)

RURAL HIGHWAYS	50 / 65 MPH 800'±
RURAL ROADS	45 / 55 MPH 500'±
RURAL ROADS & URBAN ARTERIALS	35 / 40 MPH 350'±
RURAL ROADS & URBAN ARTERIALS RESIDENTIAL & BUSINESS DISTRICTS	25 / 30 MPH 200'±
URBAN STREETS 25 MPH OR LESS 100'± (2)	
ALL SIGNS ARE BLACK ON ORANGE	

1. ALL SIGN SPACING MAY BE ADJUSTED TO ACCOMMODATE INTERCHANGE RAMPS, AT-GRADE INTERSECTIONS, DRIVEWAYS.
2. THIS SIGN SPACING MAY BE REDUCED IN URBAN AREAS TO FIT ROADWAY CONDITIONS.

CONSTRUCTION NOTES

	TIMEFRAME
1. INSTALL ORANGE FLEXIBLE 4' HIGH SAFETY FENCING WHERE SHOWN. FOLLOW DETAIL "OFF SYSTEM", SHEET C7.	ALL STAGES
2. PEDESTRIAN ACCESS UNDER AND ACROSS THE STRUCTURE SHALL BE MAINTAINED 24/7 DURING CONSTRUCTION EXCEPT FOR ONE HOUR INTERRUPTIONS BETWEEN MIDNIGHT AND 5 AM.	ALL STAGES
3. ORANGE FLEXIBLE FENCING SHALL OVERLAP WITH CENTER MOUNTED SUPPORTS UNBOLTED TO PERMIT CONSTRUCTION ACCESS.	ALL STAGES
4. CONTRACTOR SHALL BE RESPONSIBLE DURING HOURS OF WORK TO PROVIDE ACCESS ON THE WORKSITE ONLY TO AUTHORIZED PERSONNEL.	ALL STAGES
5. INSTALL SIGN(S) ON 4 IN X 4 IN WOOD POST, PER WSDOT STANDARD PLAN G-22.10-04.	ALL STAGES
6. INSTALL AND RELOCATE OR REMOVE AS REQUIRED TYPE II BARRICADES AND SIGN(S) PER WSDOT STANDARDS AND DETAIL B, SHEET C7.	AS REQUIRED
7. INSTALL AND OPERATE PCMS SIGNS WHERE SHOWN PER PLAN SHEET C2 DURING PROJECT.	ALL STAGES
8. INSTALL SIGNS ON TYPE II BARRICADE PER WSDOT STANDARDS.	ALL STAGES
9. UNISTRUT MOUNT SIGNS ON 1' X 1' STEEL PLATE USING 4 EPOXY INSERTS IN EXISTING CONCRETE.	ALL STAGES
10. ALTERNATELY USE 4 IN X 6 IN WOOD POST IN 4' EMBEDMENT OF EARTH PER WSDOT STD. PLAN G-22.10-04	ALL STAGES
11. MOUNT DETAIL B WITH SUPPORTS AND SAND BAGS WHERE NOTED ON PLANS.	ALL STAGES
12. COVER SIGNS UNTIL 1/2 HOUR PRIOR TO BEGINNING OF DETOUR ANY STAGE. RE-COVER SIGN FOLLOWING THE END OF EACH RESPECTIVE DETOUR. COVER ALL PERMANENT SIGNS NOT IN CONFORMITY WITH EACH RESPECTIVE DETOUR STAGE.	ALL STAGES
13. AGENCY TO ADJUST SIGNAL TIMING AT BEGINNING AND END OF EACH STAGE AS REQUIRED. WSDOT TO ADJUST TIMING WITH ADVANCE NOTICE OF 30 DAYS.	ALL STAGES
14. INSTALL TEMPORARY REFLECTIVE STRIPING FOR PURPOSES OF TRAFFIC CONTROL WHERE REQUIRED AND AS NEEDED. INSTALL REQUIRED ATTENUATORS.	AS REQUIRED
15. REPLACE PERMANENT STRIPING WHERE REMOVED ON EXISTING BRIDGE AND APPROACHES AFTER TEMPORARY STRIPING IS REMOVED.	AS REQUIRED
16. EXISTING BRIDGE OVER RR HAS BICYCLE/PEDESTRIAN PATH ON S SIDE OF STRUCTURE.	ALL STAGES
17. WB BICYCLISTS SHALL DETOUR N ON AIRPORT WAY, W ON NORFOLK STREET AND S ON E MARGINAL WAY.	ALL STAGES
18. INSTALL OVERHEAD MAGNETIC SIGN PATCHES DURING STAGE 1 AND STAGE 2 COMPATIBLE WITH TC OPERATIONS.	STAGES 1&2 ONLY
19. PEDESTRIANS AND BICYCLISTS ARE TO USE THE N SIDE OF BOEING ACCESS ROAD EAST OF THE I-5 SB OFF RAMP SIGNAL SYSTEM. EB BICYCLISTS ARE TO USE THE S SIDE OF BOEING ACCESS ROAD WEST OF THE SB OFF RAMP SIGNAL SYSTEM.	ALL STAGES
20. INSTALL TEMPORARY GANG PLANKS WITH RAILINGS TO SPAN APPROACH SLAB VOID EXCEPT DURING SLAB REMOVAL AND INSTALLATION.	STAGES 1&2 ONLY

BUFFER DATA

LONGITUDINAL BUFFER SPACE = B										
SPEED (MPH)	25	30	35	40	45	50	55	60	65	70
LENGTH (FEET)	155	200	250	305	360	425	495	570	645	730
TRANSPORTABLE ATTENUATOR ROLL AHEAD DISTANCE = R										
HOST VEHICLE WEIGHT 9,900 TO 22,000 LBS					HOST VEHICLE WEIGHT > 22,000 LBS					
< 45 MPH	45-55 MPH		> 55 MPH		< 45 MPH	45-55 MPH		> 55 MPH		
155	155		155		155	155		155		
PROTECTIVE VEHICLE (WORK VEHICLE) = R										
NO SPECIFIED DISTANCE REQUIRED										

MINIMUM TAPER LENGTH = L (FEET)

LANE WIDTH (FEET)	25	30	35	40	45	50	55	60
10	105	150	205	270	450	500	550	-
11	115	165	225	294	495	550	605	660
12	125	180	245	320	540	600	650	720

SHEET INDEX TRAFFIC CONTROL PLANS

STAGE	LABEL	DESCRIPTION
PREP	C1	SEQUENCE NOTES, CONSTRUCTION NOTES, GENERAL NOTES, MOT NOTES, TABLES AND LEGEND
ADVANCE SIGNAGE	C2	AREA DETOUR SIGNS, EB AND WB PEDESTRIAN DETOURS,BICYCLE WB DETOUR SIGNS, SIGNAL SYSTEM CONTACTS, MAP AND LEGEND
ALL STAGES	C3	LANE CLOSURES-PACIFIC HWY S, E MARGINAL WAY S; LEGEND
1A	C4	STAGE 1A CLOSE WB LANES OF BRIDGE (TWO N. LANES)
		STAGE 1 INCLUDES SETUP SIGNING, UNCOVER DETOUR ALIGNMENT SIGNS AND TRAFFIC CONTROL PREPARATIONS FOR CLOSURE OF THE WB LANES WITH DIVERSION OF SINGLE LANE MOVEMENTS TO THE S HALF OF THE BRIDGE. WORK TO INCLUDE REPAIR OF SIDEWALK AND UTILITY CONDUITS, INSTALLATION OF CORBEL, PARTIAL FILL OF VOIDS WITH CDF, RE-INSTALLATION OF STRIPING AFTER CONSTRUCTION OF NEW N APPROACH SLAB. REFERENCE C1, C2, C3 & C5.
1B	C4	STAGE 1B OPEN WB LANES OF BRIDGE (TWO N. LANES)
		RE-COVER DETOUR SIGNS, OPEN THE WB LANES, AND PREPARE ALL SIGNING FOR CLOSURE OF THE EB LANES. REVISE PEDESTRIAN DETOURS FOR SIDEWALK RESTRICTIONS ON S HALF OF BRIDGE-C1, C2, C3, AND C5.
2A	C5	STAGE 2A CLOSE EB LANES OF BRIDGE (TWO S. LANES)
		STAGE 2 INCLUDES SETUP SIGNING, UNCOVER DETOUR ALIGNMENT SIGNS AND TRAFFIC CONTROL PREPARATIONS FOR CLOSURE OF THE EB LANES WITH DIVERSION OF SINGLE LANE MOVEMENTS TO THE N HALF OF THE BRIDGE. WORK TO INCLUDE REPAIR OF SIDEWALK AND UTILITY CONDUITS, INSTALLATION OF CORBEL, PARTIAL FILL OF VOIDS WITH CDF, RE-NSTALLATION OF STRIPING AFTER CONSTRUCTION OF NEW S APPROACH SLAB. REFERENCE C1, C2, C3 & C5.
2B	C5	STAGE 2B OPEN EB LANES OF BRIDGE (TWO S. LANES)
		RE-COVER DETOUR SIGNS, OPEN THE WB LANES WITH TEMPORARY LANE MARKINGS, AND PREPARE ALL SIGNING FOR PERMANENT RESTORATION OF PAVEMENT MARKINGS.
AIRPORT WAY STAGES	C6	STAGES A AND B - AIRPORT WAY LANES UNDER BRIDGE TO COMPLETE CENTERLINE COLUMNS.
		IMPLEMENT STAGES A AND B PEDESTRIAN AND BICYCLE DETOURS. SETUP ADVANCE NOTICE SIGNING, DETOUR SIGNING AND TRAFFIC CONTROL PREPARATIONS FOR TRAFFIC STAGES A AND B ACTIVITIES. INSTALL JERSEY BARRIER EACH SIDE OF CENTER SUPPORTS.
AIRPORT WAY STAGE A	C6	STAGE A POSITION AIRPORT WAY LANES UNDER BRIDGE TO COMPLETE CENTERLINE COLUMNS.
		IMPLEMENT STAGE 1 PEDESTRIAN AND BICYCLE DETOURS. SETUP ADVANCE NOTICE SIGNING, DETOUR SIGNING AND TRAFFIC CONTROL PREPARATIONS FOR AIRPORT WAY STAGE A ACTIVITIES. INSTALL JERSEY BARRIER EACH SIDE OF CENTER SUPPORTS.
AIRPORT WAY STAGE B	C6	STAGE 1B RE-POSITION AIRPORT WAY JERSEY BARRIER UNDER BRIDGE TO COMPLETE PIERS 2 AND 4 COLUMNS.
		MAINTAIN STAGE 1 PEDESTRIAN AND BICYCLE DETOURS. ADJUST TRAFFIC CONTROL SIGNING, DETOUR SIGNING AND TRAFFIC CONTROL PREPARATIONS FOR AIRPORT WAY STAGE B ACTIVITIES. RE-POSITION JERSEY BARRIER TO PROTECT PIERS 2 AND 4 SUPPORTS.
ALL STAGES	C7	SPECIAL DETAILS FOR 'OFF', BARRICADES, SIGNS, SHARROWS
		PEDESTRIAN PROTECTION DETAILS, BARREL MOUNTED SIGNS, BARRICADES, AND PAVEMENT MARKING.
RESTORATION STAGING	C8	FINAL RESTORATION AND INSTALLATION OF PERMANENT PAVEMENT MARKING AND STRIPING.
RESTORATION STAGING	C9	OVERHEAD SIGN PATCHES AND DATA; PORTABLE SIGNAL SCHEDULE OF OPERATIONS; ELECTRICAL CONSTRUCTION NOTES
		POST PROJECT COMPLETION AS GENERAL TRAFFIC ADVISORY, REMOVE ALL COVERED SIGNS, RESTORE ALL PERMANENT STRIPING, LANE MARKING.

BUFFER DATA

TYPICAL PROTECTIVE VEHICLE WITH TMA (SEE NOTE 1)	
VEHICLE TYPE	LOADED WEIGHT
4 YARD DUMP TRUCK, SERVICE TRUCK, FLAT BED, ETC.	MINIMUM WEIGHT 15,000 LBS. (MAXIMUM WEIGHT SHALL BE IN ACCORDANCE WITH MANUFACTURER RECOMMENDATIONS
1	ROLL-AHEAD STOPPING DISTANCE = 30 FEET MIN. (DRY PAVEMENT ASSUMED)

CALL 48 HOURS BEFORE YOU DIG
COMMON GROUND ALLIANCE
811

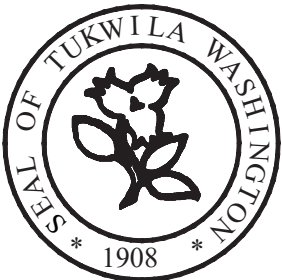

PUBLIC WORKS DEPT.

*ENGINEERING*STREETS*WATER*SEWER*PARKS*BUILDING*

	By	Date
Designed	JDK	
Drawn	DJJ	
Checked		
Proj Eng		
Proj Dir		
Field Bk #		



365 118th Ave. SE, Suite 100
Bellevue, Washington 98005
Phone: 425.453.5545



S. BAR OVER AIRPORT WAY
BRIDGE SEISMIC RETROFIT

TRAFFIC NOTES, TABLES AND LEGEND

3	3/31/20	ADDENDUM # 3
No.	Date	Revisions

C1
4 of 23

File No. C1.dwg
Scale NTS
Date DEC. 2019

d:\jensen\03\30\20\8-50pm - P\2018\2018029 - Tukwila BAR_Airport Way Bridge Seismic Project\000 CAD\010 Drawing\C-Structural Sheet\C2.dwg

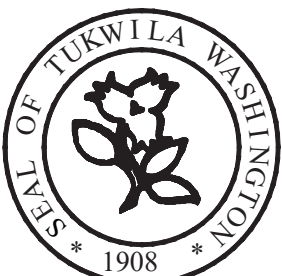
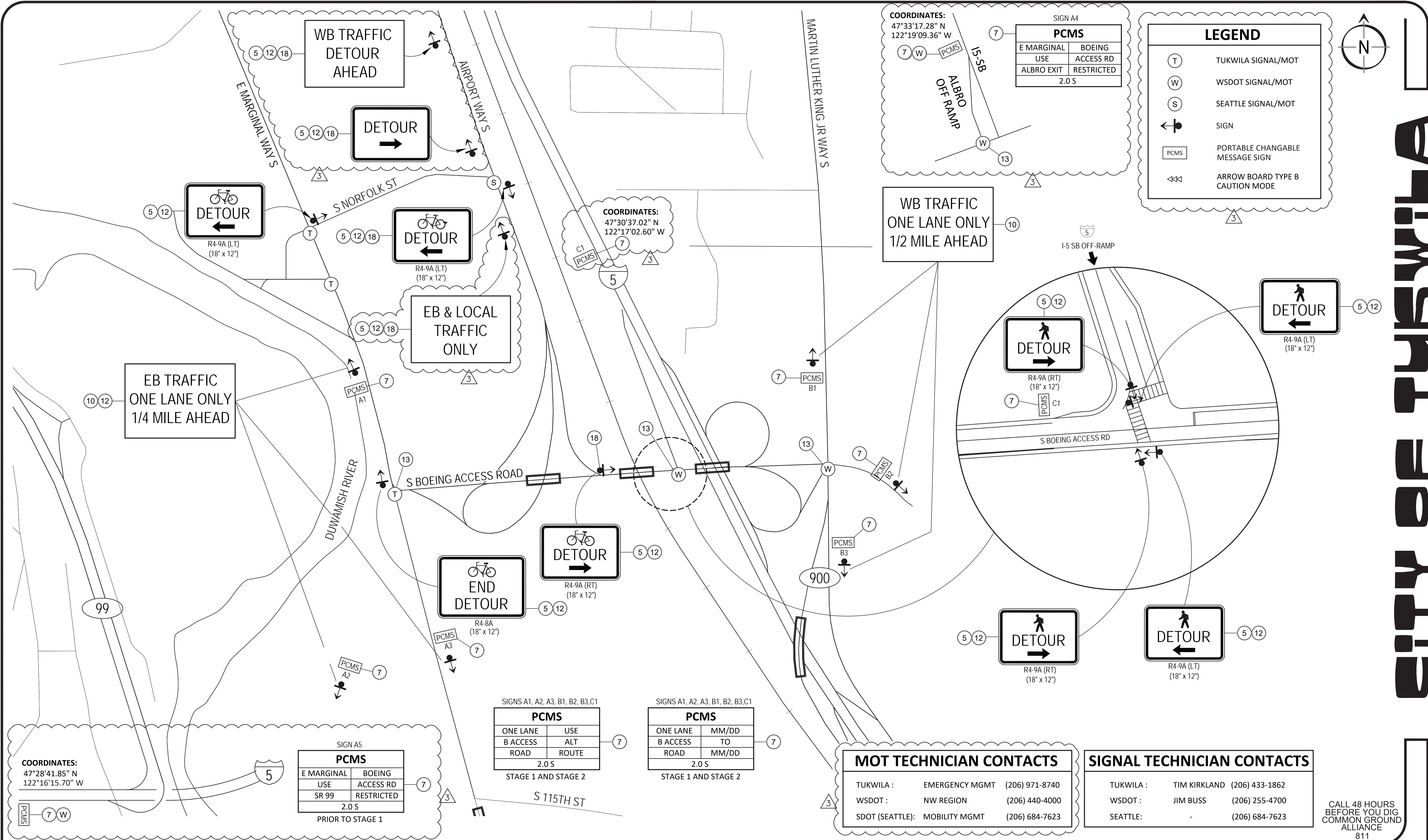

PUBLIC WORKS DEPT.

*ENGINEERING*STREETS*WATER*SEWER*PARKS*BUILDING*

	By	Date
Designed	JDK	
Drawn	DJJ	
Checked		
Proj Eng		
Proj Dir		
Field Bk #		

TRANTECH
Engineering LLC

365 118th Ave. SE, Suite 100
Bellevue, Washington 98005
Phone: 425.453.5545

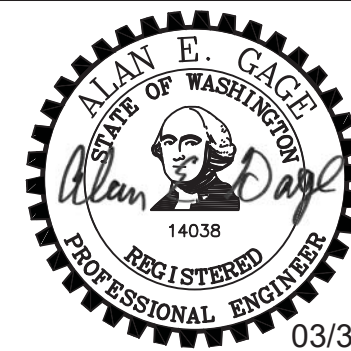

03/31/20

S. BAR OVER AIRPORT WAY BRIDGE SEISMIC RETROFIT AREA DETOUR SIGNS

3	3/31/20	ADDENDUM # 3
No.	Date	Revisions

C2

5 of 23

File No. C2.dwg

Scale NTS

Date DEC. 2019

03/30/20 9:10pm - P:\2018\2018029 - Tukwila BAR_Airport Way Bridge Seismic Project\000 CAD\010 Drawing\C-Structural Sheet\C4&C5&C7&C8.dwg

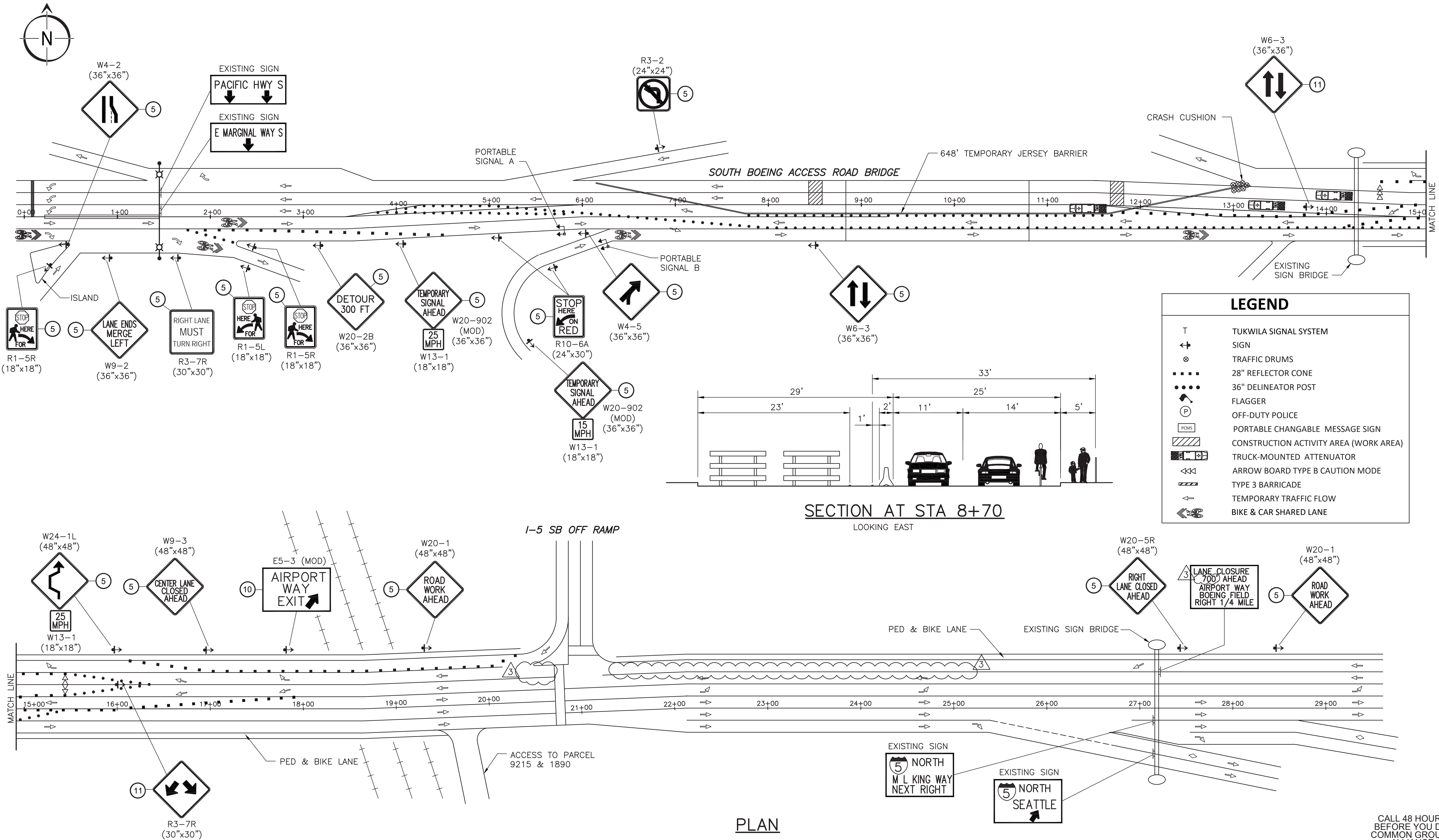

PLAN

SECTION AT STA 8+70
LOOKING EAST

CALL 48 HOURS
BEFORE YOU DIG
COMMON GROUND
ALLIANCE
811



PUBLIC WORKS DEPT.

*ENGINEERING*STREETS*WATER*SEWER*PARKS*BUILDING*

	By	Date
Designed	JDK	
Drawn	DJJ	
Checked		
Proj Eng		
Proj Dir		
Field Bk #		

TRANTECH
Engineering LLC
365 118th Ave. SE, Suite 100
Bellevue, Washington 98005
Phone: 425.453.5545

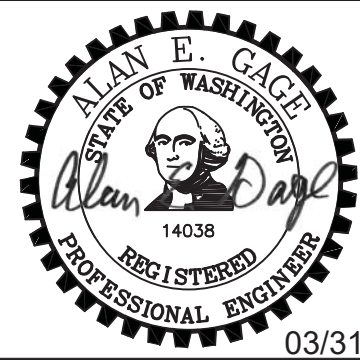

**S. BAR OVER AIRPORT WAY
BRIDGE SEISMIC RETROFIT
STAGE 1 - NORTH HALF BRIDGE CLOSURE**

3	3/31/20	ADDENDUM # 3
No.	Date	Revisions

C4
7 of 23
File No. C4&C5&C7&C8.dwg
Scale NTS
Date DEC. 2019

03/30/20 9:09pm - P:\2018\2018029 - Tukwila BAR_Airport Way Bridge Seismic Project\000 CAD\010 Drawing\C-Structural Sheet\CA4&C5&C7&C8.dwg

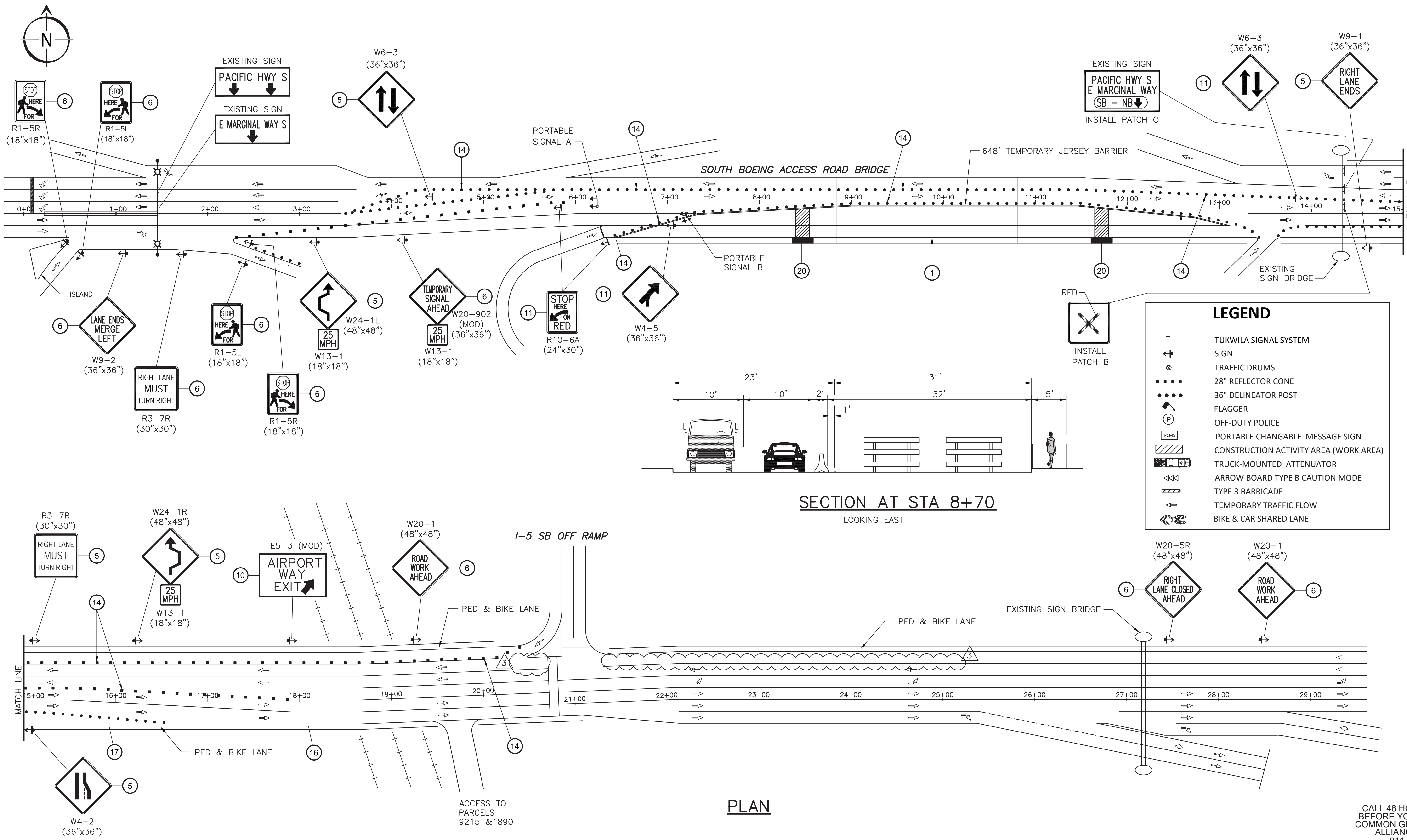

PUBLIC WORKS DEPT.

*ENGINEERING*STREETS*WATER*SEWER*PARKS*BUILDING*

	By	Date
Designed	JDK	
Drawn	DJJ	
Checked		
Proj Eng		
Proj Dir		
Field Bk #		

TRANTECH
Engineering LLC
365 118th Ave. SE, Suite 100
Bellevue, Washington 98005
Phone: 425.453.5545

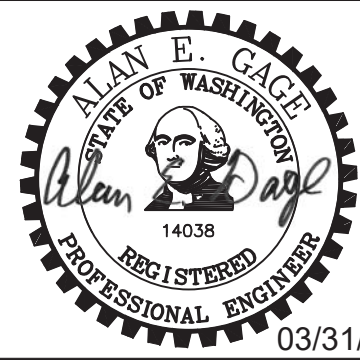

**S. BAR OVER AIRPORT WAY
BRIDGE SEISMIC RETROFIT
STAGE 2 - SOUTH HALF BRIDGE CLOSURE**

3	3/31/20	ADDENDUM # 3
No.	Date	Revisions

CALL 48 HOURS
BEFORE YOU DIG
COMMON GROUND
ALLIANCE
811

C5
8 of 23

File No. C4&C5&C7&C8.dwg
Scale NTS
Date DEC. 2019

CITY OF TUKWILA

03/31/20 12:12:19pm - P:\2018\2018029 - Tukwila BAR Airport Way Bridge Seismic Project\000 CAD\010 Drawing\010 Structural Sheet\C6.dwg

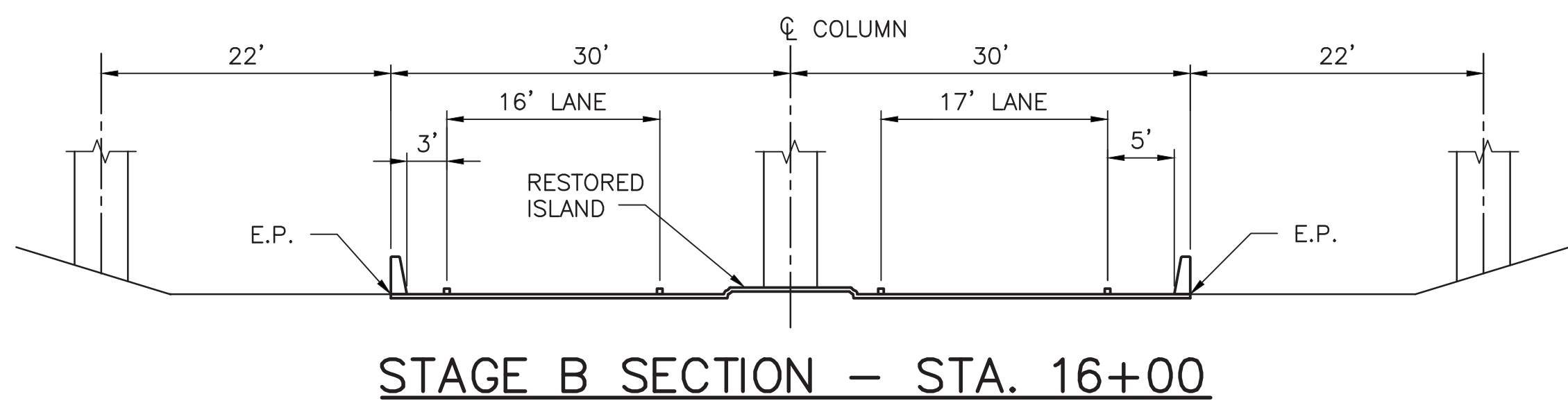
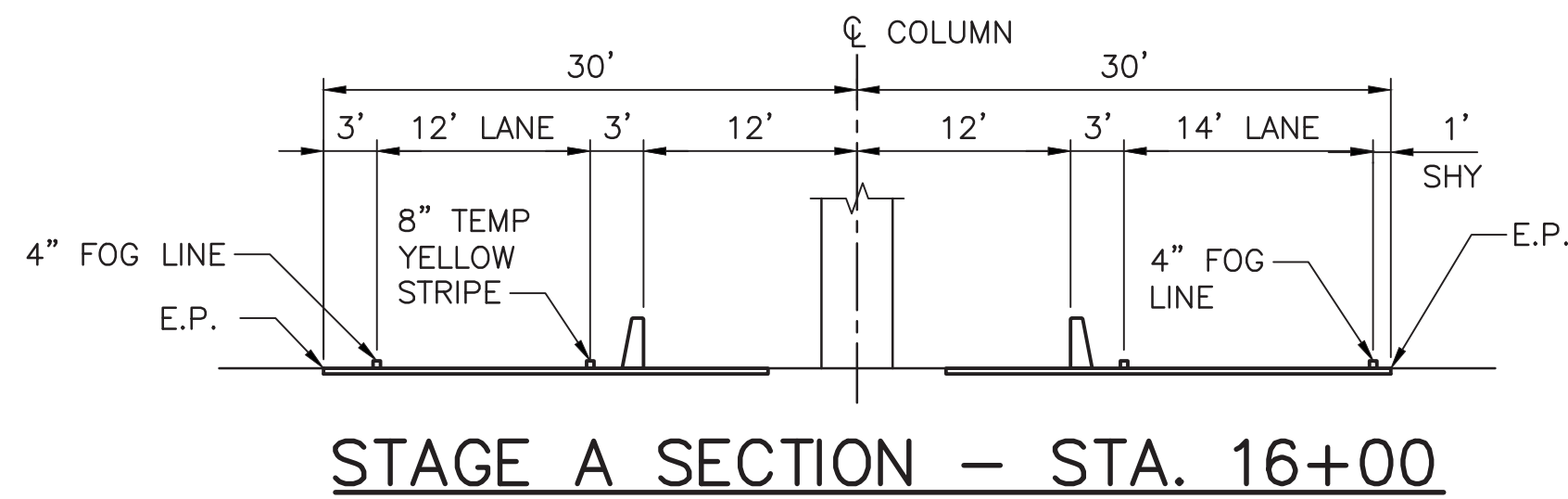
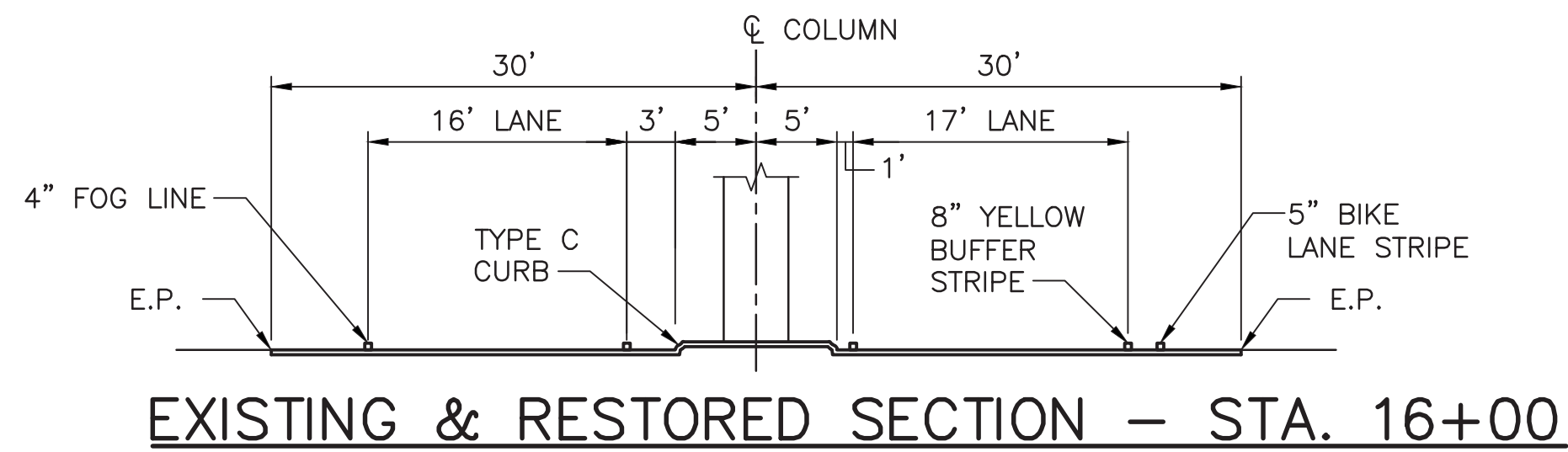

GENERAL NOTES:

1. STAGE IIIA SHALL BE COMPLETED AND ISLAND RESTORED PRIOR TO IMPLEMENTING STAGE B
2. TEMPORARY STRIPING SHALL BE RE-IMPLEMENTED UNTIL COMPLETION OF STAGE B.
3. TEMPORARY JERSEY BARRIER SHALL BE INSTALLED FOR EACH STAGE WITH ATTENUATOR IN PLACE AND CLEARANCES MAINTAINED.
4. AFTER COMPLETION OF STAGE A WESTBOUND, PERMANENT CHANNELIZATION AND STRIPING SHALL BE RESTORED OR REPLACED.

LEGEND

T	TUKWILA SIGNAL SYSTEM
+	SIGN
⊗	TRAFFIC DRUMS
○	SAND BARREL
•••••	28" REFLECTOR CONE
•••••	36" DELINEATOR POST
⚠	FLAGGER
P	OFF-DUTY POLICE
PCMS	PORTABLE CHANGABLE MESSAGE SIGN
▨	CONSTRUCTION ACTIVITY AREA (WORK AREA)
▩	TRUCK-MOUNTED ATTENUATOR
↔	ARROW BOARD TYPE B CAUTION MODE
▬	TYPE 3 BARRICADE
→	TEMPORARY TRAFFIC FLOW
↔	BIKE & CAR SHARED LANE

REFERENCE NOTES:

A	FOR 'OFF' DETAIL, BARREL MOUNTED SIGNS, SHARROW DETAIL, AND BARRICADE DETAIL, SEE SHEET C7.
B	FOR SIGN INSTALLATION SEE DETAIL A, SHEET C7.
C	FOR GENERAL NOTES, DEVICE SPACING, TAPER DATA, CONSTRUCTION NOTES AND SHEET INDEX SEE SHEET C1.
D	FOR PCMS SIGNS, WB BICYCLE DETOUR AND SIGNAL SYSTEM REFERENCES SEE SHEET C2.
E	FOR EB AND WB PEDESTRIAN DETOUR SEE SHEET C2.
F	FOR AIRPORT WAY STAGE A AND B DETOUR SEE SHEET C6.
G	FOR BOEING ACCESS ROAD STAGING SEE SHEETS C4 AND C5.
H	FOR FINISH STRIPING AND PAVEMENT MARKING SEE C8.
I	FOR OVERHEAD SIGNING LEGENDS SEE SHEETS C4 AND C5.
J	FOR OVERHEAD SIGNING PATCH PANELS SEE SHEET C9.
K	FOR LANE CLOSURES AT BAR AND EMW SEE SHEET C3.

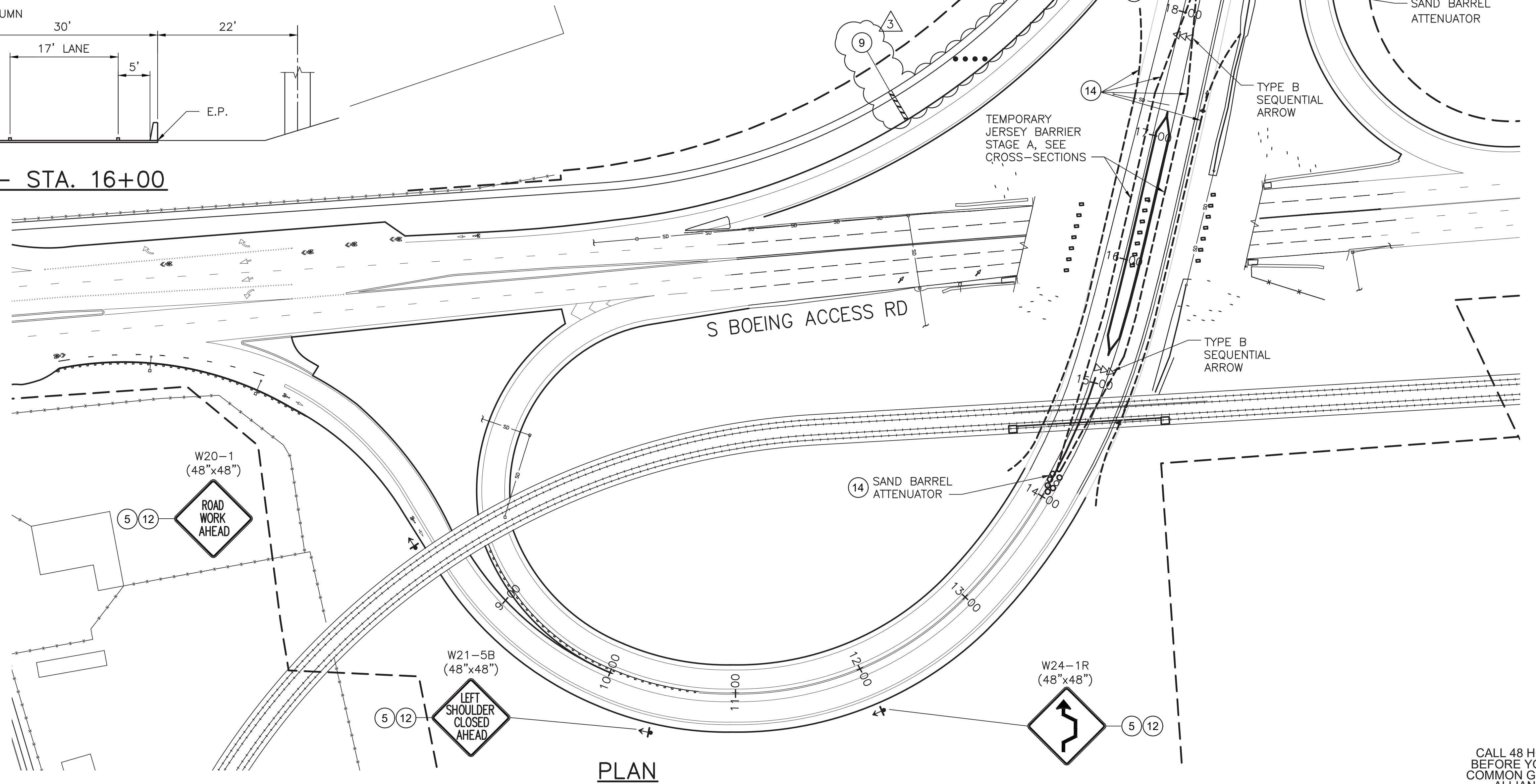

CALL 48 HOURS BEFORE YOU DIG
COMMON GROUND ALLIANCE
811



PUBLIC WORKS DEPT.

*ENGINEERING*STREETS*WATER*SEWER*PARKS*BUILDING*

By	JDK
Drawn	DJJ
Checked	
Proj Eng	
Proj Dir	
Field Bk #	

TRANTECH
Engineering LLC
365 118th Ave. SE, Suite 100
Bellevue, Washington 98005
Phone: 425.453.5545

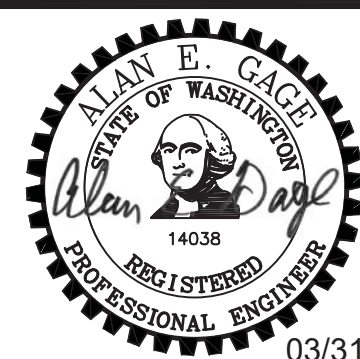

**S. BAR OVER AIRPORT WAY
BRIDGE SEISMIC RETROFIT
STAGES A AND B - AIRPORT WAY**

3	3/31/20	ADDENDUM # 3
No.	Date	Revisions

C6
9 of 23
File No. C6.dwg
Scale NTS
Date DEC. 2019

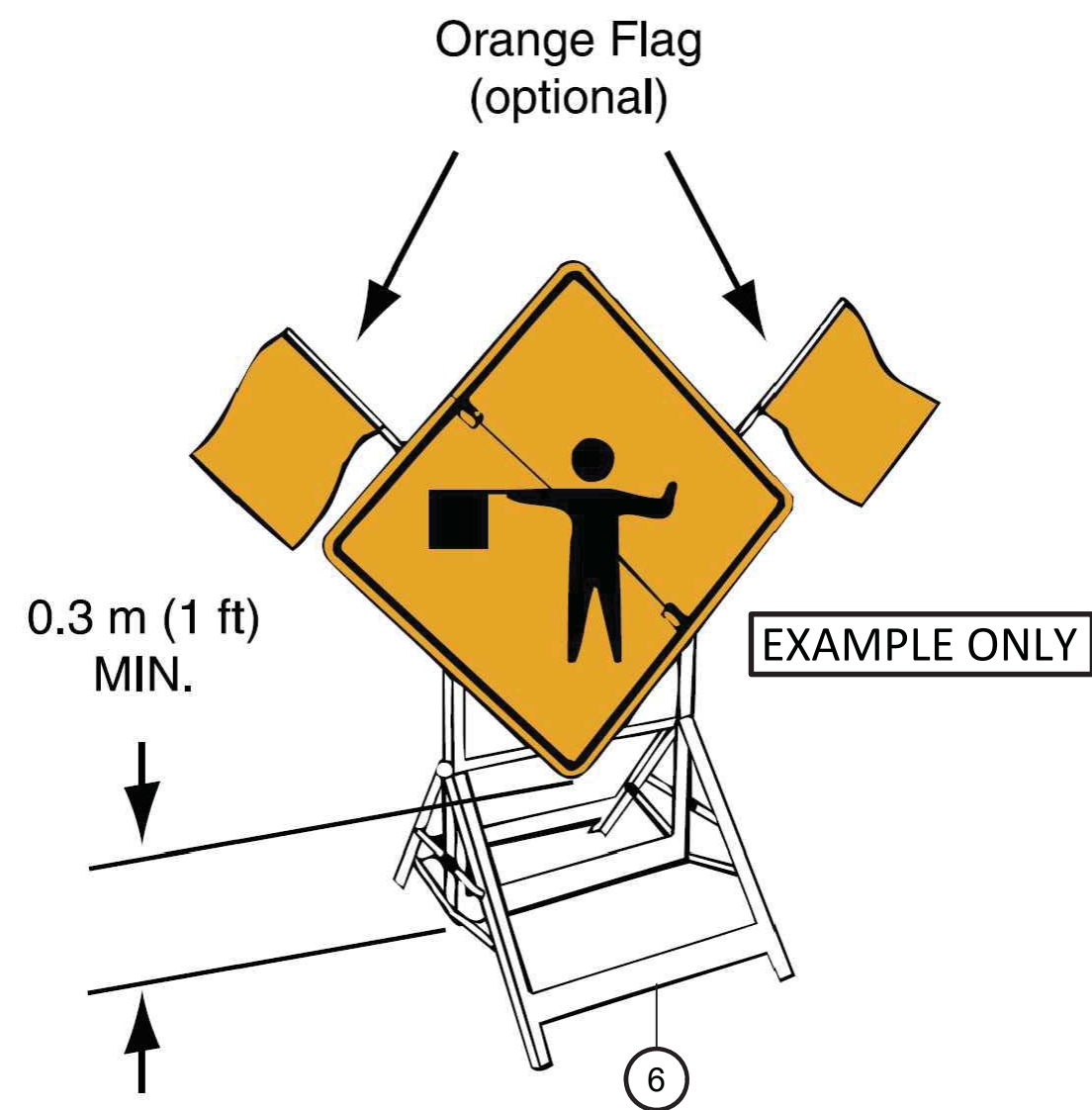

DETAIL A

PORTABLE SIGN MOUNTING —
SANDBAGS OPTIONAL, AS REQUIRED.
SEE CONSTRUCTION NOTE 6.

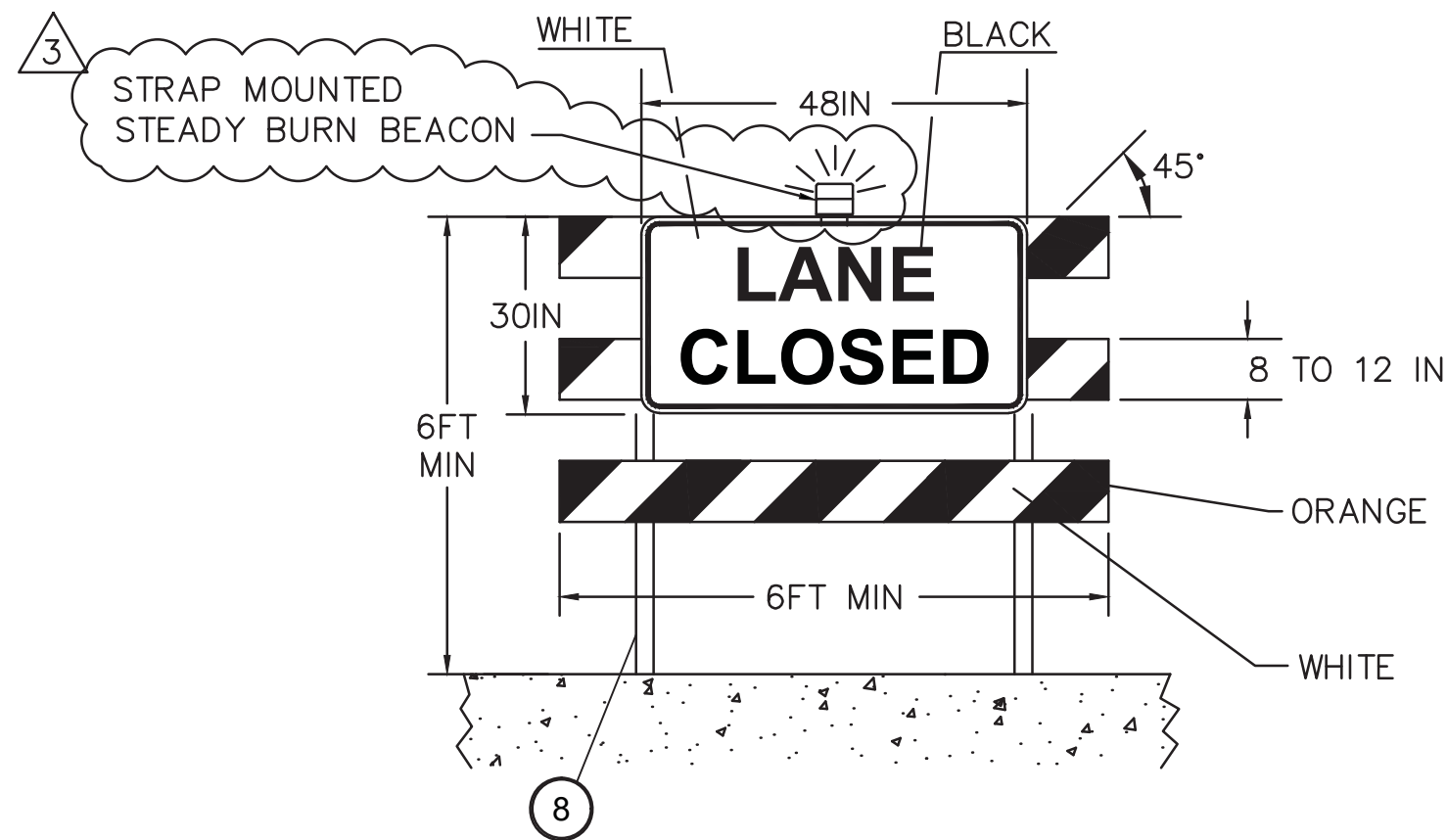

DETAIL B

TYPE III BARRICADE

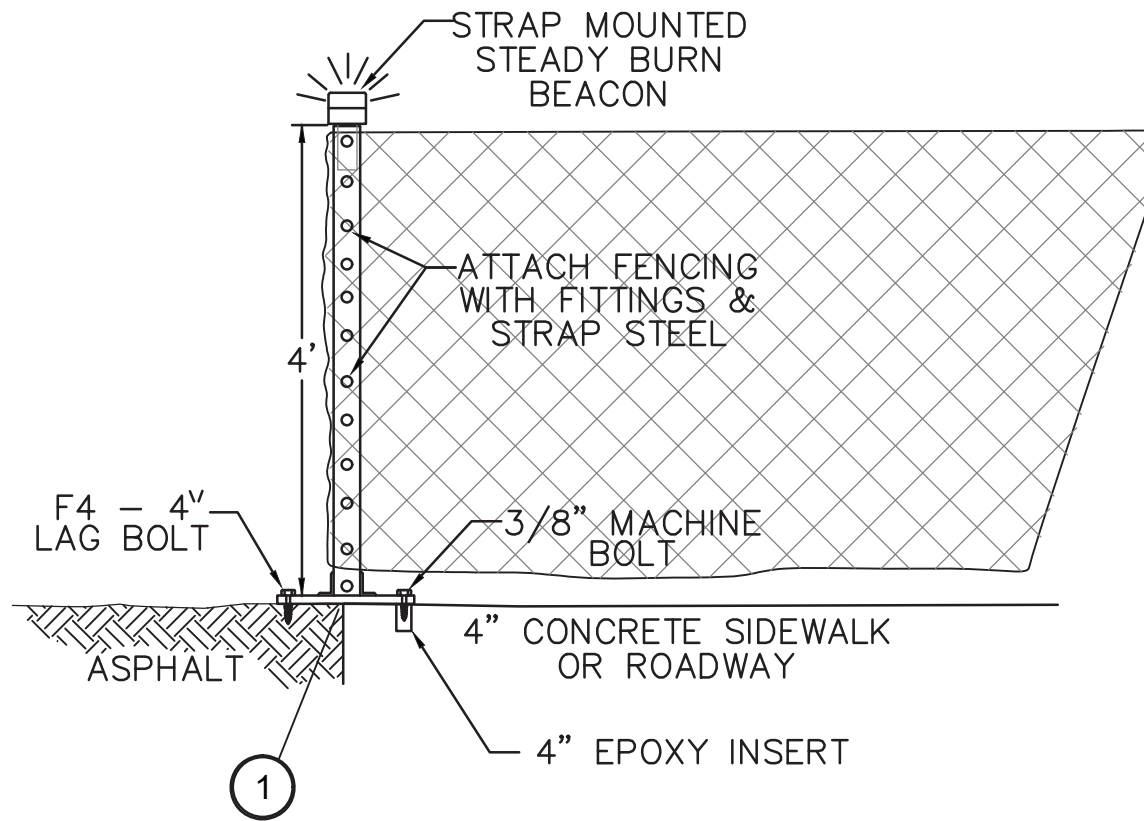

"OFF SYSTEM" DETAIL
(ORANGE FLEXIBLE FENCING)

REFERENCE NOTES

A	FOR 'OFF' DETAIL, BARREL MOUNTED SIGNS, SHARROW DETAIL, AND BARRICADE DETAIL, SEE SHEET C7.
B	FOR SIGN INSTALLATION SEE DETAIL A, SHEET C7.
C	FOR GENERAL NOTES, DEVICE SPACING, TAPER DATA, CONSTRUCTION NOTES AND SHEET INDEX SEE SHEET C1.
D	FOR PCMS SIGNS, WB BICYCLE DETOUR AND SIGNAL SYSTEM REFERENCES SEE SHEET C2.
E	FOR EB AND WB PEDESTRIAN DETOUR SEE SHEET C2.
F	FOR AIRPORT WAY STAGE A AND B DETOUR SEE SHEET C6.
G	FOR BOEING ACCESS ROAD STAGING SEE SHEETS C4 AND C5.
H	FOR FINISH STRIPING AND PAVEMENT MARKING SEE C8.
I	FOR OVERHEAD SIGNING LEGENDS SEE SHEETS C4 AND C5.
J	FOR OVERHEAD SIGNING PATCH PANELS SEE SHEET C9.
K	FOR LANE CLOSURES AT BAR AND EMW SEE SHEET C3.

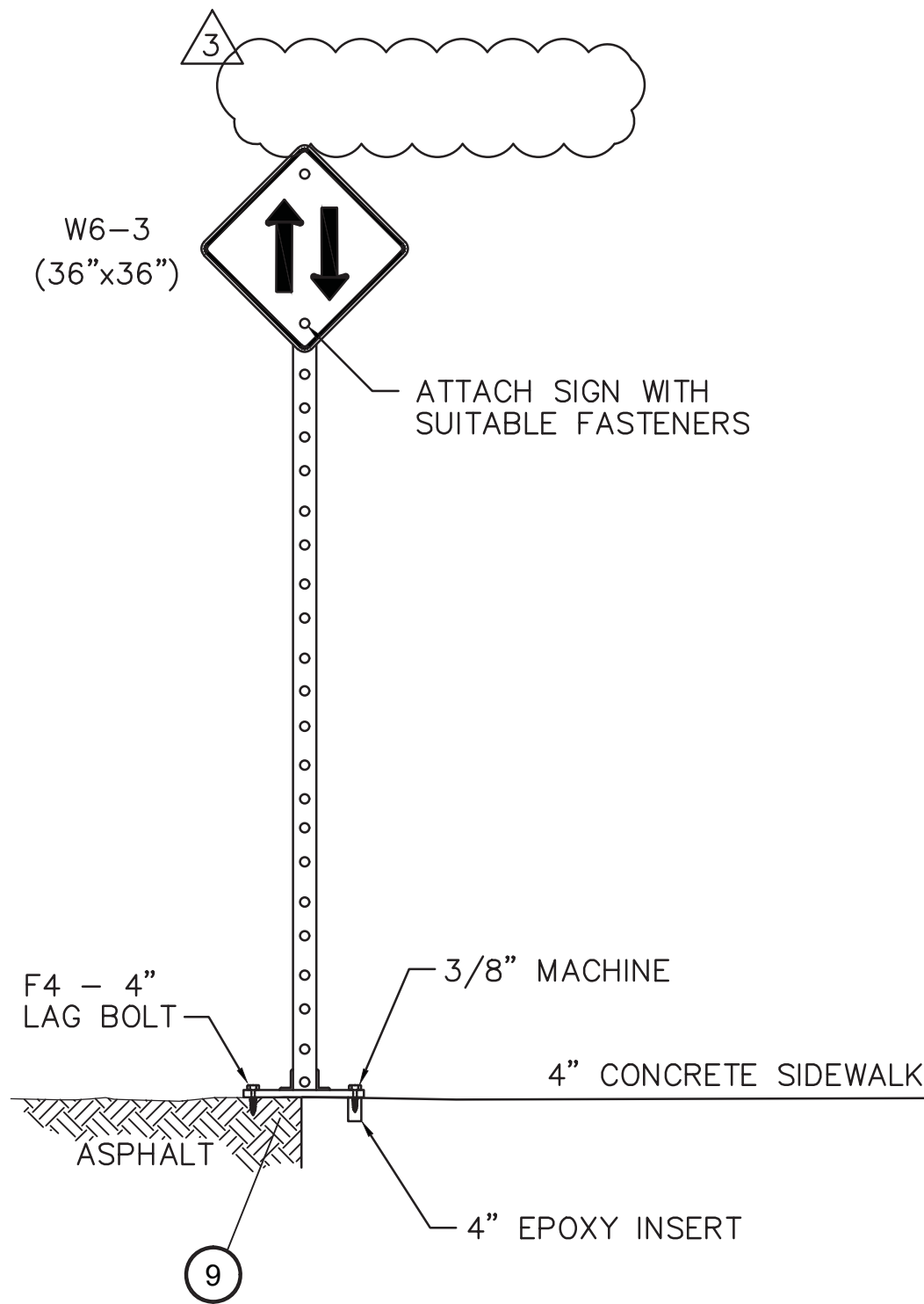
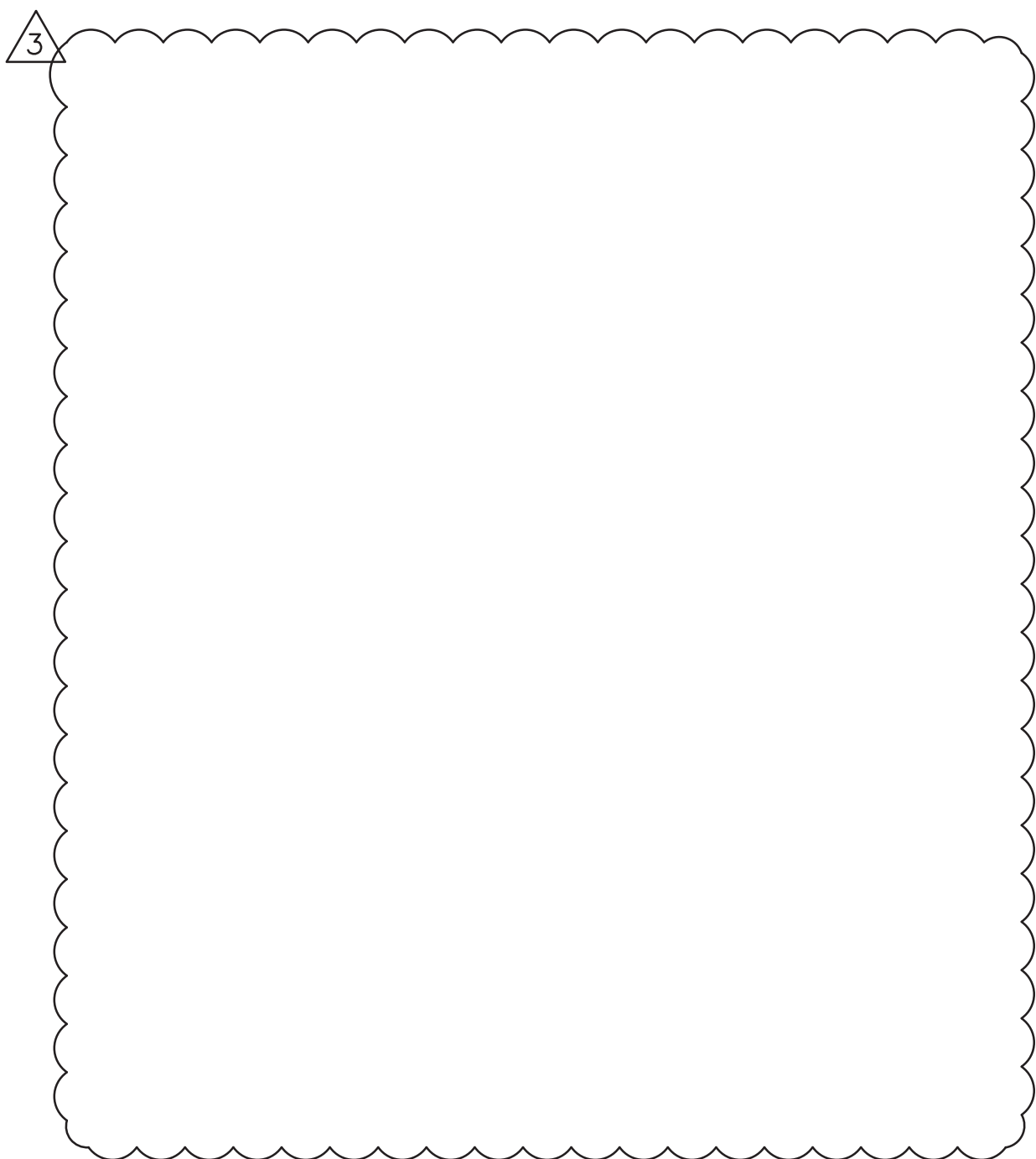

MODIFIED SIGN MOUNT DETAIL

CALL 48 HOURS
BEFORE YOU DIG
COMMON GROUND
ALLIANCE
811

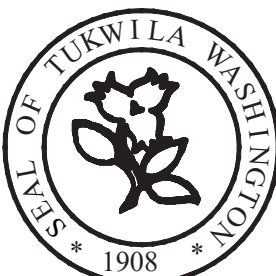

PUBLIC WORKS DEPT.

*ENGINEERING*STREETS*WATER*SEWER*PARKS*BUILDING*

	By	Date
Designed	JDK	
Drawn	DJJ	
Checked		
Proj Eng		
Proj Dir		
Field Bk #		

TRANTECH
Engineering LLC

365 118th Ave. SE, Suite 100
Bellevue, Washington 98005
Phone: 425.453.5545



**S. BAR OVER AIRPORT WAY
BRIDGE SEISMIC RETROFIT**
TRAFFIC CONTROL DETAILS

3	3/31/20	ADDENDUM # 3
No.	Date	Revisions

C7

10 of 23

File No. C4&C5&C7&C8.dwg

Scale NTS

Date DEC. 2019

ljensen 03/30/20 8:46pm - P:\2018\2018029 - Tukwila BAR_Airport Way Bridge Seismic Project\000 CAD\010 Drawing\C-Structural Sheet\C3 & C9.dwg

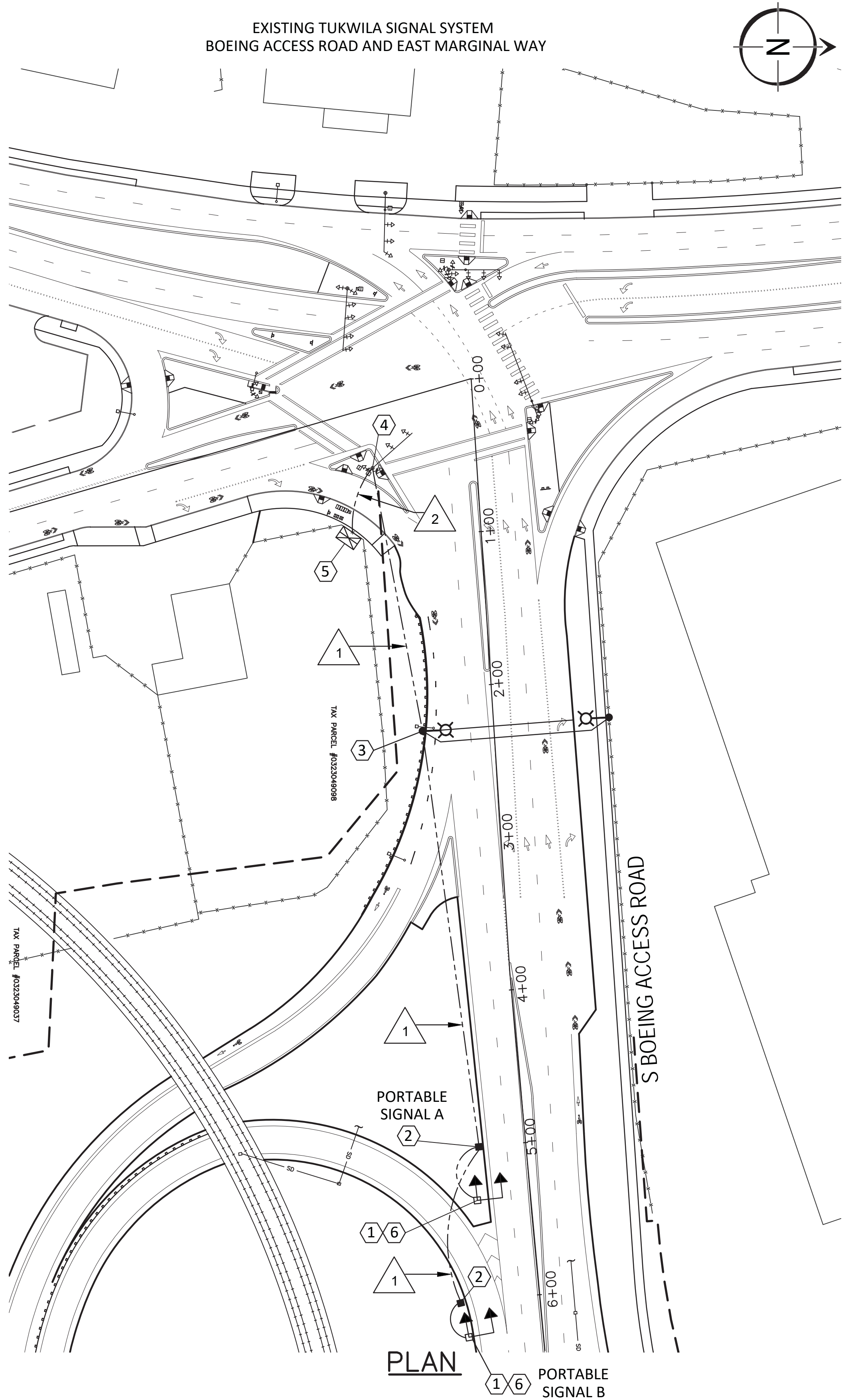

OVERHEAD SIGN PATCHES

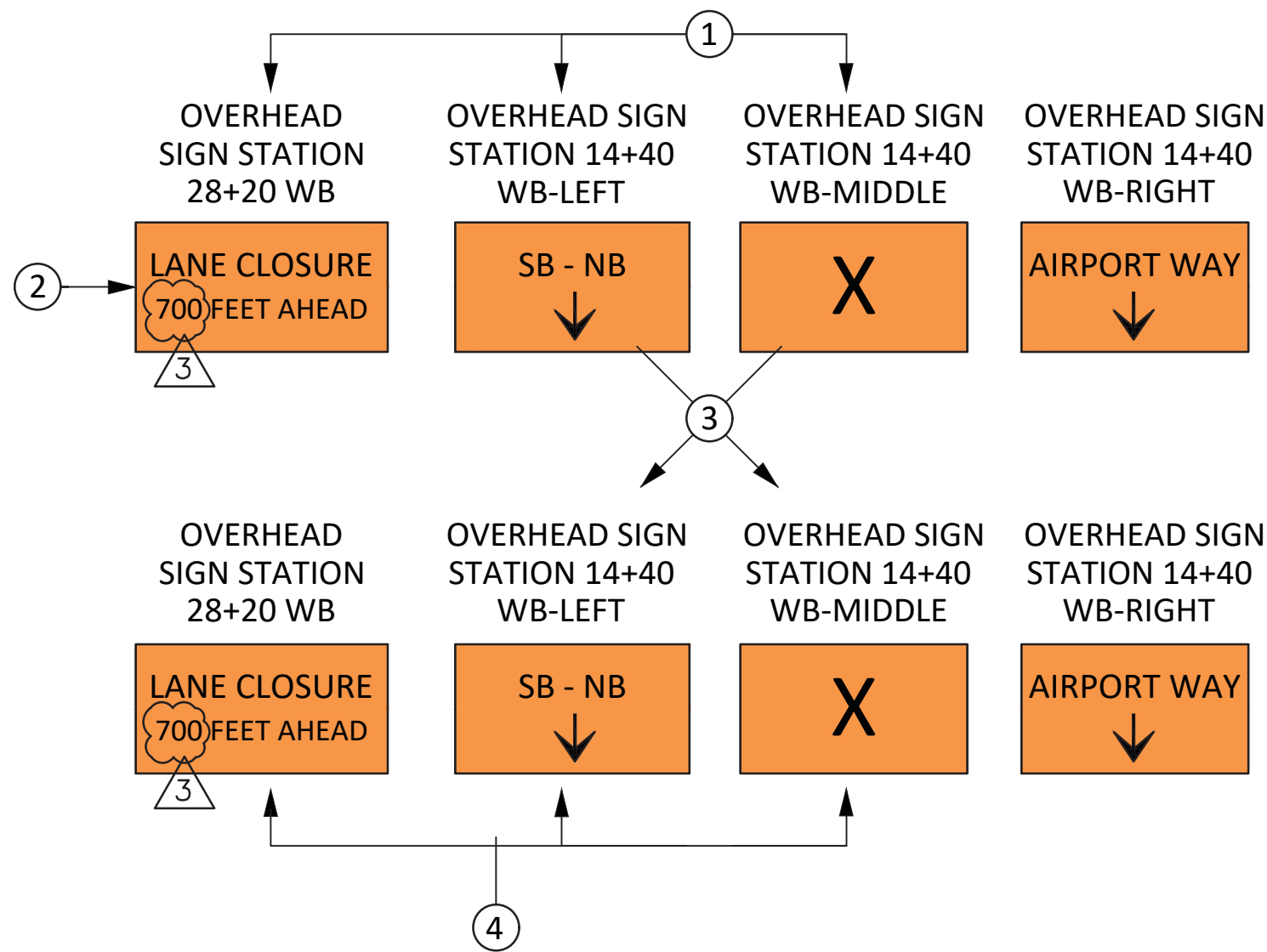

PORTABLE SIGNAL A & B SCHEDULE

DAY OF WEEK	BEGIN	END	COMMENT
M-T-W-TH-F	600	900	R-Y-G
M-T-W-TH-F	1500	1800	R-Y-G
SAT	NA	NA	R-Y-G
SUN	NA	NA	R-Y-G
OTHER TIMES	YELLOW	FLASH	SIGNAL A
OTHER TIMES	RED	FLASH	SIGNAL B

ELECTRICAL LEGEND

- 1 #19 4/C SIGNAL INTERCONNECT, SELF SUPPORTING
- 2 #19 4/C SIGNAL INTERCONNECT

OVERHEAD SIGN PATCH C-NOTES

- CREATE AND INSTALL ATTACHABLE SIGN TO DISPLACE EXISTING INFORMATION ON SIGN. MATCH SIGN SIZE AND LETTER SIZE SUITABLE FOR VISIBILITY.
- PLACE SIGN PATCH AS REQUIRED DURING NIGHT TIME HOURS PRIOR TO OPENING DETOUR ALIGNMENT.
- REPOSITION SIGN PATCH AS DETOUR STAGING REQUIRES.
- REMOVE SIGN PATCH DURING NIGHT TIME HOURS PRIOR TO IMPLEMENTING NORMAL TRAFFIC PATTERNS.

ELECTRICAL CONSTRUCTION NOTES

- INSTALL PORTABLE TEMPORARY TRAFFIC CONTROL SIGNAL AT LOCATIONS SHOWN ON SHEETS C4 AND C5.
- INSTALL TEMPORARY 25 FT WOOD POLE WITH AERIAL FEED TO NEXT POLE AND SIGNAL LEVEL CABLE TO NEARBY PORTABLE SIGNAL.
- ATTACH AERIAL SELF SUPPORTING CABLE TO EXISTING SIGN AND LIGHTING POLE.
- ATTACH AERIAL SELF SUPPORTING CABLE TO EXISTING SIGNAL POLE AND EXTEND CABLE INTO WIRE ENTRANCE AND FEED TO CONTROLLER CABINET.
- CONNECT THE CABLE TO THE LOGIC OUTPUT OF PHASE 3 GREEN WITH ANY NECESSARY GROUND.
- PORTABLE SIGNAL NEEDS TO READ THE PHASE 3 GREEN AS THE PERMITTED INTERVAL FOR PERMITTING PORTABLE SIGNAL B TO BE GREEN WITH DETECTED VEHICLES AND PORTABLE SIGNAL A TO HOLD RED.
- SEE PORTABLE SIGNAL OPERATION THIS SHEET.

PORTABLE SIGNAL OPERATION

- PORTABLE SIGNAL B WILL BE THE MASTER OVER PORTABLE SIGNAL A.
- THE INTERSECTION AT E MARGINAL WAY WILL SEND THE GREEN OUTPUT SIGNAL LEVEL VOLTAGE AS A CLOSED RELAY FOR THE PHASE 3 OUTPUT (NB PHS) AS AN INITIATION START OF GREEN FOR PORTABLE SIGNAL B WITH A HOLD ON THE GREEN UNTIL THE TERMINATION OF THE CLOSED RELAY.
- AT TERMINATION OF THE GREEN FOR PHASE 3 THE RELAY WILL OPEN AND RECALL OF GREEN WILL OCCUR ON THE PORTABLE SIGNAL A CAUSING THE PORTABLE SIGNAL B TO SEQUENCE TO RED.
- PORTABLE SIGNAL A WILL REST IN GREEN UNTIL PORTABLE SIGNAL B AGAIN RECEIVES A CLOSED RELAY SIGNAL TO ACTIVATE THE GREEN ON PORTABLE SIGNAL B.
- THE TIME CLOCKS CONTROLLING ACTIVE SIGNAL DISPLAYS WILL SERVE TO PLACE PORTABLE SIGNAL A IN FLASHING YELLOW AND PORTABLE SIGNAL BE TO FLASH IN RED AT ALL TIMES ACTIVE SIGNALIZATION IS NOT CALLED FOR.
- THE ENGINEER WILL DIRECT THE TIME FOR THE CLOCKS TO CALL FOR ACTIVE DISPLAY OF COLORS AT THE PORTABLE SIGNALS. THE INITIAL SETTINGS WILL CONFORM TO THE TIMES SHOWN ON THE PLANS UNDER PORTABLE SIGNAL A & B SCHEDULE.
- A FORM OF DETECTION CONSISTING OF A WIRELESS MAGNETIC PUCK WILL BE CONNECTED TO THE DETECTION INPUT FILE OF PORTABLE SIGNAL B. ALTERNATIVE TYPE OF DETECTION WILL BE CONSIDERED FOR APPROVAL.
- THE CONTRACTOR WILL REMAIN THE OWNER OF THE DETECTION DEVICE AND NO FURTHER COMPENSATION WILL BE CONSIDERED.

CALL 48 HOURS
BEFORE YOU DIG
COMMON GROUND
ALLIANCE
811

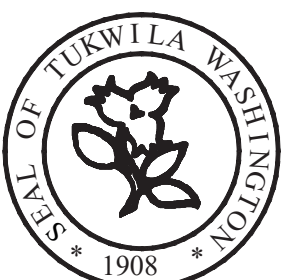

PUBLIC WORKS DEPT.

*ENGINEERING*STREETS*WATER*SEWER*PARKS*BUILDING*

	By	Date
Designed	JDK	
Drawn	DJJ	
Checked		
Proj Eng		
Proj Dir		
Field Bk #		

TRANTECH
Engineering LLC

365 118th Ave. SE, Suite 100
Bellevue, Washington 98005
Phone: 425.453.5545

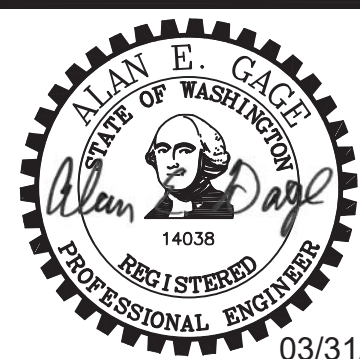

**S. BAR OVER AIRPORT WAY
BRIDGE SEISMIC RETROFIT**

**OVERHEAD SIGN PATCHES
AND SIGNAL COORDINATION**

3	3/31/20	ADDENDUM # 3
No.	Date	Revisions

C9

12 of 23

File No. C3 & C9.dwg

Scale NTS

Date DEC. 2019

SEC.3, T.23N., R.4E.,WM

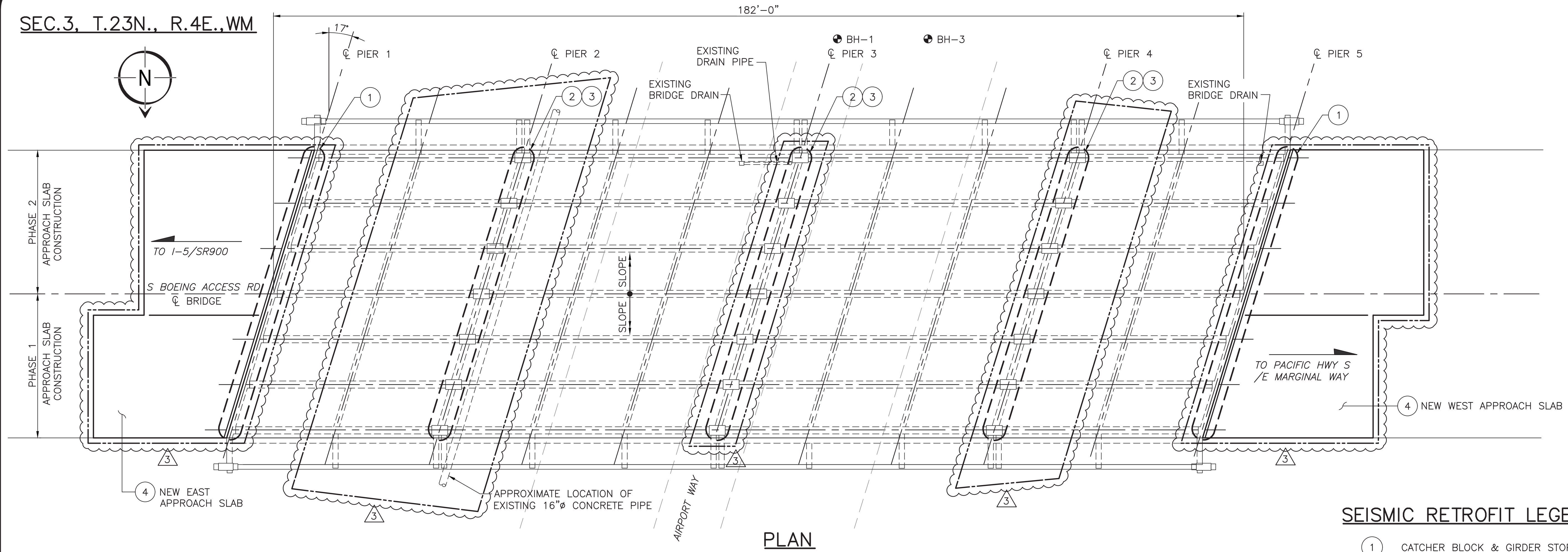

SEISMIC RETROFIT LEGEND

- 1 CATCHER BLOCK & GIRDER STOP
- 2 NEW CONCRETE BOLSTERS
- 3 NEW STEEL COLUMN JACKETS
- 4 NEW APPROACH SLAB
- PROPOSED WORK AREA
- PROPOSED LIMITS OF SHORING AND EXCAVATION

NOTES

- PIER 1 TO PIER 5 ARE LABELED EAST TO WEST. INSPECTION REPORT LABELS PIER 1 TO PIER 5 WEST TO EAST.
- SOILS SHALL BE SLOPED NO STEEPER THAN 1.5H:1.0V WITHOUT SHORING TO PROVIDE WORKER ACCESS.
- MAINTAINING SUITABLE SLOPING AND SHORING IS THE RESPONSIBILITY OF THE CONTRACTOR.
- WHERE SLOPES WILL BE BACKFILLED, IT IS RECOMMENDED THEY BE TERRACED IN ACCORDANCE WITH SECTION 2-03.3(14).
- IT IS RECOMMENDED THAT COMPACTION SLOPES BE PERFORMED IN ACCORDANCE WITH METHOD C OF SECTION 2-03.3(14)C.

ELEVATION

LOOKING SOUTH

BRIDGE NUMBER — TUKxNx11

CALL 48 HOURS BEFORE YOU DIG COMMON GROUND ALLIANCE 811

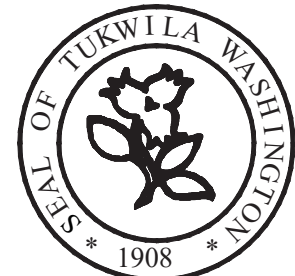

PUBLIC WORKS DEPT.

ENGINEERING STREETS* WATER* SEWER* PARKS* BUILDING*

	By	Date
Designed	JDK	
Drawn	DJJ	
Checked		
Proj Eng		
Proj Dir		
Field Bk #		

TRANTECH Engineering LLC

365 118th Ave. SE, Suite 100
Bellevue, Washington 98005
Phone: 425.453.5545

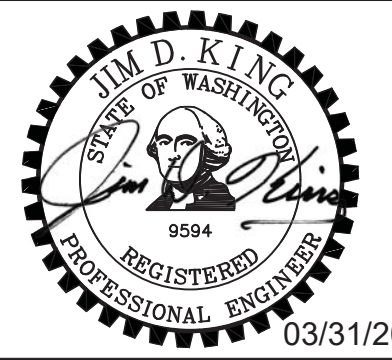

S. BAR OVER AIRPORT WAY
BRIDGE SEISMIC RETROFIT

BRIDGE PLAN & ELEVATION

3	3/31/20	ADDENDUM # 3
No.	Date	Revisions

S1

13 of 23

File No. S1.dwg

Scale NTS

Date DEC. 2019

J:\jensen 03/30/20 8:44pm - P:\2018\2018029 - Tukwila BAR_Airport Way Bridge Seismic Project\000 CAD\010 Drawing\C-Structural Sheet\S3-S11.dwg

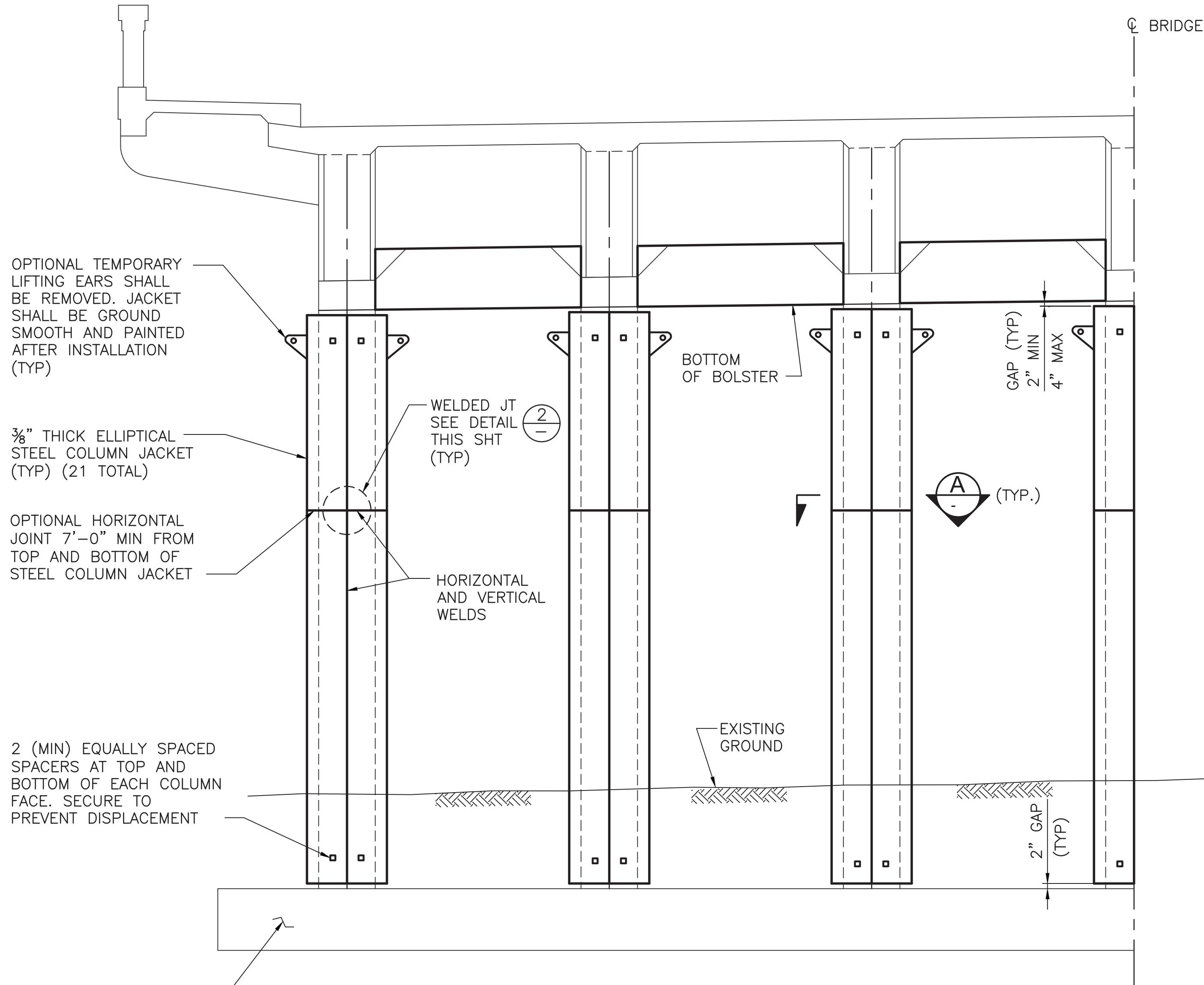

STEEL COLUMN JACKET ELEVATION AT PIER 2, 3 & 4

PIER 4 SHOWN, PIER 2 AND 3 SIMILAR
LOOKING PARALLEL TO ϕ ROADWAY

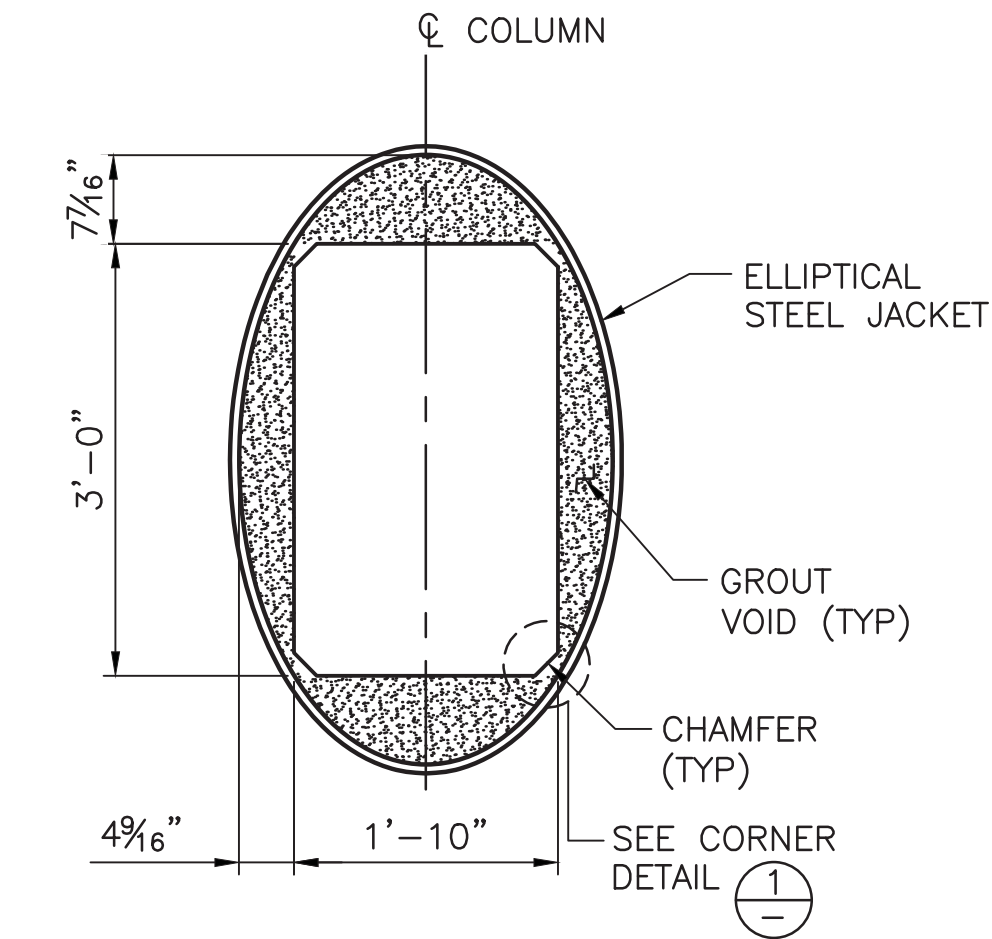

SECTION A

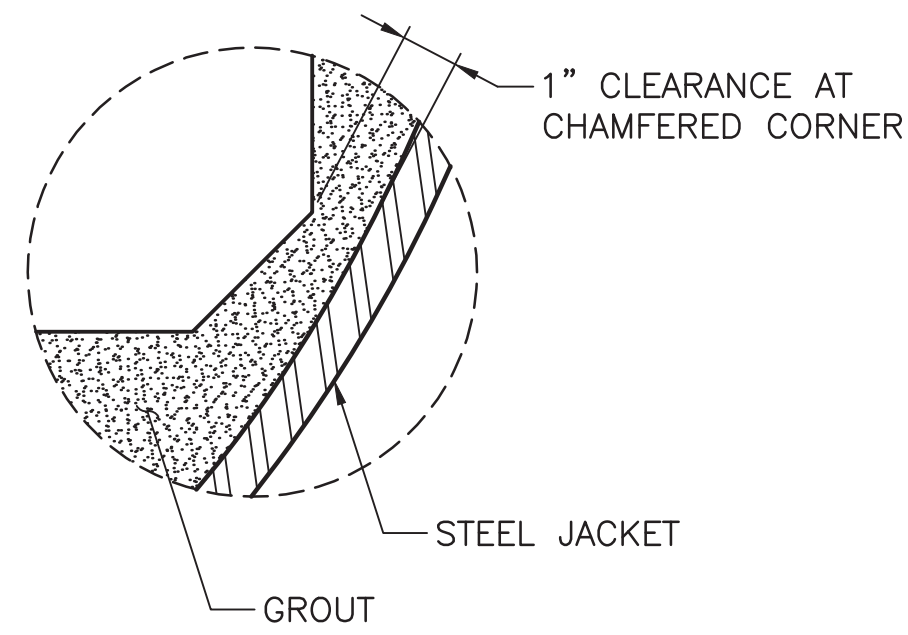

CORNER DETAIL 1
TYPICAL EACH CORNER

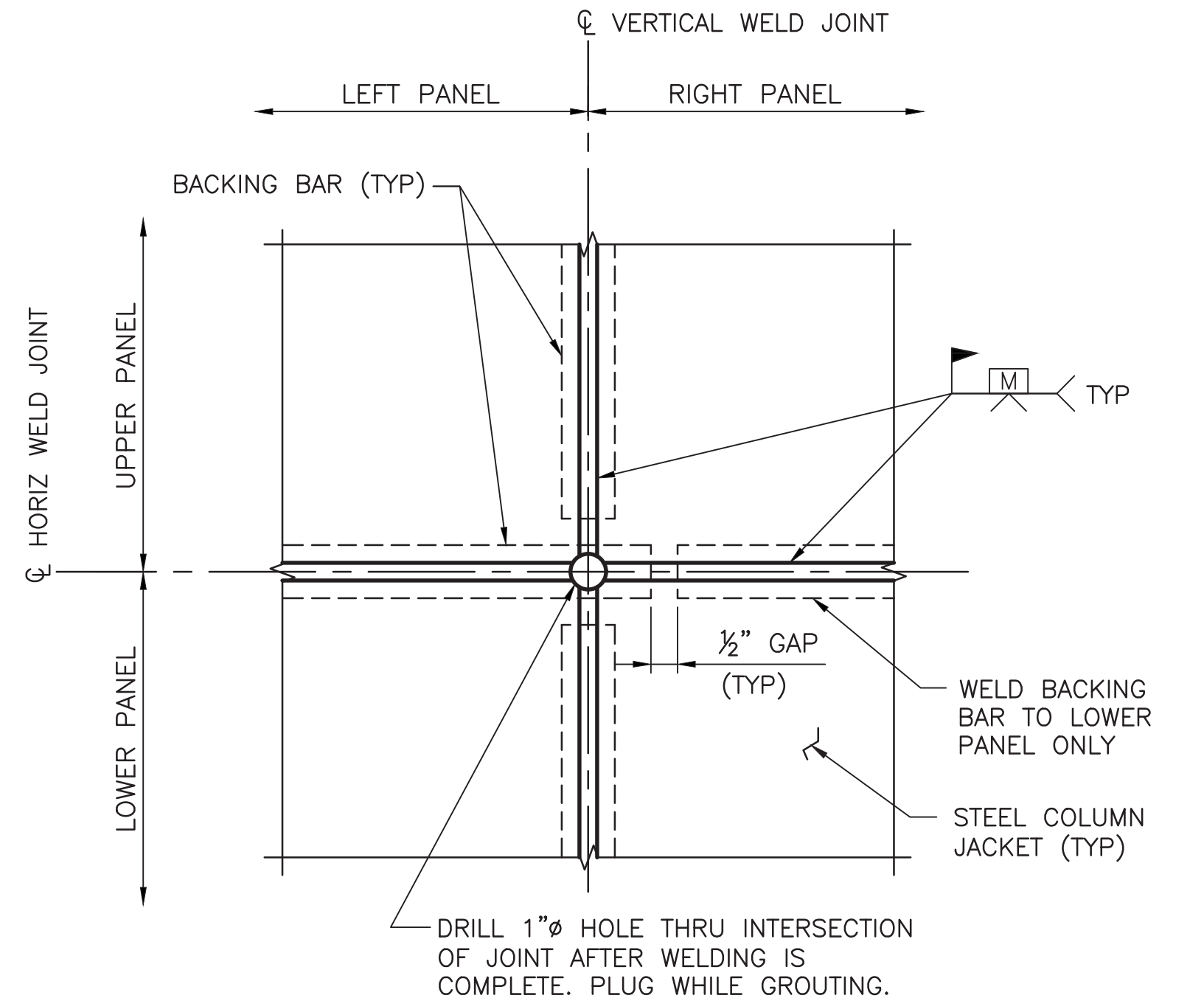

STEEL JACKET WELD DETAIL 2

NOTES:

1. INJECTION NOZZLES AS REQUIRED BY SPECIAL PROVISION, SHALL BE PROVIDED ON STEEL COLUMN JACKET AND SHALL BE REMOVED, GROUND FLUSH AND PAINTED FOLLOWING COMPLETION OF GROUTING OPERATION.
2. ALL VOIDS BETWEEN STEEL COLUMN JACKET AND EXISTING COLUMN SURFACE SHALL BE FILLED WITH CEMENT GROUT. GROUTING SHALL BE DONE FROM THE BOTTOM UP IN ACCORDANCE WITH THE SPECIAL PROVISIONS.
3. THE LOCATION AND NUMBER OF VERTICAL AND HORIZONTAL WELDS SHALL BE DETERMINED BY THE CONTRACTOR AND SUBJECT TO THE APPROVAL OF THE ENGINEER. THE LOCATION OF COLUMN JACKET WELDS IS FOR ILLUSTRATION. SHIP WELDS ARE NOT ALLOWED.
4. EXPOSED COLUMN REINFORCING BARS SHALL BE CLEANED PRIOR TO INSTALLING STEEL COLUMN JACKETS.
5. CONTRACTOR SHALL NOT DAMAGE THE EXISTING CONCRETE PIPE ADJACENT TO PIER 2 FOOTING AT ALL TIMES DURING CONSTRUCTION.
6. EXISTING DRAIN PIPE MOUNTED ON PIER 3 COLUMN SHALL BE REMOVED AND REPLACED WITH NEW DRAIN PIPE AFTER THE CONSTRUCTION OF COLUMN JACKETING AND CROSS BEAM STRENGTHENING IS COMPLETED.
7. COLUMN CONCRETE REPAIR WORK SHALL BE COMPLETED PRIOR TO INSTALLING STEEL COLUMN JACKETS.

CALL 48 HOURS
BEFORE YOU DIG
COMMON GROUND
ALLIANCE
811



PUBLIC WORKS DEPT.

*ENGINEERING*STREETS*WATER*SEWER*PARKS*BUILDING*

	By	Date
Designed	JDK	
Drawn	DJJ	
Checked		
Proj Eng		
Proj Dir		
Field Bk #		

TRANTECH
Engineering LLC

365 118th Ave. SE, Suite 100
Bellevue, Washington 98005
Phone: 425.453.5545

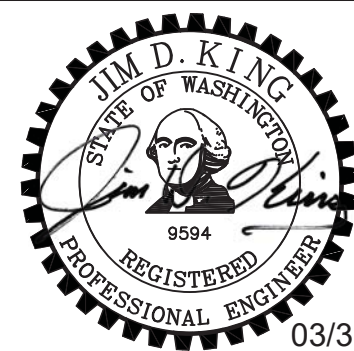

03/31/20

**S. BAR OVER AIRPORT WAY
BRIDGE SEISMIC RETROFIT
COLUMN JACKETING DETAILS 1**

No.	Date	Revisions
3	5/31/20	ADDENDUM # 3

S6

18 of 23

File No. S3-S11.dwg

Scale NTS

Date DEC. 2019

ADDENDUM NO. 2

City of Tukwila, Washington S Boeing Access Road over Airport Way Bridge Seismic Retrofit Project

City Project No.: 91310407

DATE OF ADDENDUM ISSUE: March 18, 2019
DATE OF BID OPENING: April 7, 2020

NOTE TO ALL PLANHOLDERS:

This Addendum No. 2, containing the following revisions, additions, deletions, and/or clarifications, is hereby made a part of the Plans and Contract Provisions (Contract Documents) for the above-named project. Bidders shall take this Addendum into consideration when preparing and submitting their bids.

Bidders shall acknowledge receipt and acceptance of this Addendum No. 2 in the space provided on the Proposal Signature Sheet or by signing in the space provided below and submitting the signed addendum with the bid package. Failure to provide this written acknowledge may result in disqualification of the Bidder's submittal.

PROPOSAL

1. Page I-1: CALL FOR BIDS is replaced with the following:

NOTICE IS HEREBY GIVEN that sealed bids will be received by the City of Tukwila, Washington at the office of the City Clerk, in Tukwila City Hall, 6200 Southcenter Boulevard, Tukwila, Washington 98188, up to the hour of **9:30 a.m. on Tuesday, April 7, 2020**. Bids will be opened and read aloud in at 10:00 a.m. on Tuesday, April 7, 2020. Bidders have the opportunity to access the bid opening via Skype, please dial (253) 292-9750, Conference ID: 898726483 #.

2. Proposal Pages P-2 through P-3:

DELETE Pages P-2 through P-3 and REPLACE with the attached Pages P-2 through P-3. The attached sheets include the following revisions:

- Added Bid Item 17 – Shoring or Extra Excavation Cl. A
- Revised Numbering of Bid Items 17 through 29

ALL OTHER REQUIREMENTS OF THE CONTRACT DOCUMENTS REMAIN IN EFFECT.

Bidders shall acknowledge receipt and acceptance of this Addendum No. 2 in the space provided on the Proposal Signature Sheet or by signing in the space provided below and submitting the signed addendum with the bid package. Failure to provide this written acknowledge may result in disqualification of the Bidder's submittal.

Sincerely,



Hari Ponnekanti, P.E.

xc: City Clerk
Construction Manager
File: 91310407

Addendum No. 2
March 18, 2020
Page 1 of 2

City of Tukwila
City Engineer

Receipt acknowledge, and conditions agreed to this _____ day of _____, 2019

Bidder _____
Signature

S BOEING ACCESS ROAD OVER AIRPORT WAY BRIDGE SEISMIC RETROFIT PROJECT - SCHEDULE A

Project No. 91310407

Note: Unit prices for all items, all extensions, and the total amount bid must be shown. Where conflict occurs between the unit price and the total amount specified for any item, the unit price shall prevail, and totals shall be corrected to conform thereto. **For Schedule A, include applicable Sales Tax in the various Unit and Lump Sum prices.**

Item No.	Item Description	Quantity	Unit	Unit Price	Amount
BRIDGE					
1.	Mobilization	1	LS		
2.	Structure Surveying	1	LS		
3.	Type B Progress Schedule	1	LS		
4.	Unexpected Site Changes	Est	FA	\$25,000.00	\$25,000.00
5.	Resolution of Utility Conflicts	Est	FA	\$30,000.00	\$30,000.00
6.	As-Built Recording	1	LS		
7.	Contractor's Daily Diary	1	LS		
8.	Reimbursement for Third Party Damage	Est	FA	\$25,000.00	\$25,000.00
9.	SPCC Plan	1	LS		
10.	Portable Illumination	4	EA		
11.	Contractor Provided Uniformed Police Officers	120	HR		
12.	Traffic Control Supervisor	1	LS		
13.	Temporary Erosion & Sediment Control and Water Pollution Prevention (including SWPPP Implementation)	1	LS		
14.	Project Temporary Traffic Control	1	LS		
15.	Removal of Structures and Obstructions	1	LS		
16.	Structure Excavation Class A Incl. Haul	200	CY		
17.	Shoring or Extra Excavation Cl. A	1	LS		
18.	Crushed Surfacing Base Course	30	TON		
19.	Work Platform and Containment System	1	LS		
20.	Conc. Class 4000 for Bridge	28	CY		
21.	St. Reinf. Bar for Bridge	3900	LB.		
22.	Expansion Joint System Compression Seal – Superstr.	115	LF		
23.	Bridge Approach Slab	342	SY		
24.	Transverse Stop Bearing	16	EA		
25.	Epoxy Dowels	580	EA		
26.	Column Jacketing	1	LS		
27.	Drain Pipe 4 In. Diam.	70	LF		

ROADWAY					
28.	FA-Site Cleanup of Bio. and Physical Hazards	Est	FA	\$15,000.00	\$15,000.00
29.	Roadside Cleanup	Est	FA	\$15,000.00	\$15,000.00
30.	Property Restoration	Est	FA	\$15,000.00	\$15,000.00

Schedule A Total \$ _____
TOTAL BID PRICE \$ _____

ADDENDUM NO. 1

City of Tukwila, Washington S Boeing Access Road over Airport Way Bridge Seismic Retrofit Project

City Project No.: 91310407

DATE OF ADDENDUM ISSUE: March 11, 2019
DATE OF BID OPENING: March 24, 2020

NOTE TO ALL PLANHOLDERS:

This Addendum No. 1, containing the following revisions, additions, deletions, and/or clarifications, is hereby made a part of the Plans and Contract Provisions (Contract Documents) for the above-named project. Bidders shall take this Addendum into consideration when preparing and submitting their bids.

Bidders shall acknowledge receipt and acceptance of this Addendum No. 1 in the space provided on the Proposal Signature Sheet or by signing in the space provided below and submitting the signed addendum with the bid package. Failure to provide this written acknowledge may result in disqualification of the Bidder's submittal.

CLARIFICATION

1. Advertisement in *The Seattle Times* and the *Seattle Daily Journal of Commerce*:

The advertisement in *The Seattle Times* and the *Seattle Daily Journal of Commerce* states that the Work is required to be performed within 300 calendar days. The correct timeline for the Work to be performed is 170 working days as stated in the bid package posted on Builders Exchange.

Please note, that the correct language is 170 working days and not 300 calendar days.

PROPOSAL

2. Page I-2: 1. Pre-Bid Conference is replaced with the following:

A pre-bid conference will be held at Tukwila Public Works Department, 6300 Southcenter Boulevard, Suite 100, Tukwila, Washington on Monday, March 16, 2020 at 10:00 a.m. Bidders also have the opportunity to attend the meeting via Skype. To access the meeting via Skype, please dial (253) 292-9750, Conference ID: 147445958. All potential bidders are strongly encouraged to attend or call in. This will be your opportunity to ask direct questions related to the project. Information from the pre-bid conference may not necessarily be made available to bidders who do not attend. The Engineer will transmit to all prospective Bidders of record (registered with Builders Exchange) such addenda as Engineer considers necessary in response to questions arising at the conference. Oral statements may not be relied upon and will not be binding or legally effective.

ALL OTHER REQUIREMENTS OF THE CONTRACT DOCUMENTS REMAIN IN EFFECT.

Bidders shall acknowledge receipt and acceptance of this Addendum No. 1 in the space provided on the Proposal Signature Sheet or by signing in the space provided below and submitting the signed addendum with the bid package. Failure to provide this written acknowledge may result in disqualification of the Bidder's submittal.

Sincerely,



Hari Ponnekanti, P.E.
City of Tukwila
City Engineer

Receipt acknowledge, and conditions agreed to this _____ day of _____, 2019

Bidder _____
Signature

**CITY OF TUKWILA
CALL FOR BIDS**

NOTICE IS HEREBY GIVEN that sealed bids will be received by the City of Tukwila, Washington at the office of the City Clerk, in Tukwila City Hall, 6200 Southcenter Boulevard, Tukwila, Washington 98188, up to the hour **of 9:30 a.m. on Tuesday, March 24, 2020**. Bids will be opened and publicly read aloud at 10:00 a.m. on Tuesday, March 24, 2020 for:

**S BOEING ACCESS ROAD OVER AIRPORT WAY BRIDGE SEISMIC RETROFIT PROJECT:
PROJECT NO. 91310407**

The Work to be performed within **300** calendar days from the date of Notice to Proceed consists of furnishing all materials, equipment, tools, labor, and other work or items incidental thereto for:

Construction of approximately 400 linear feet of street improvements within the right-of-way of S Boeing Access Road and Airport Way S, including but not limited to construction of new approach slabs, catcher blocks, girder stops, concrete bolsters, and steel column jackets at the S Boeing Access Road Over Airport Way Bridge and other work necessary to complete the Work as specified and shown in the Contract Documents.

Each bid shall be in accordance with the bid documents available free of charge on-line through Builders Exchange of Washington, Inc. at <http://www.bxwa.com>. Click on: "bxwa.com", "Posted Projects"; Public Works"; "City of Tukwila", and "Project Bidding". Bidders are encouraged to "Register as a Bidder" in order to receive automatic e-mail notification of addenda and to be placed on the "Bidders List". This service is provided free of charge to Prime Bidders, Subcontractors and Vendors bidding this project. Contact Builders Exchange of Washington at (425) 258-1303, should you require further assistance. Informational copies of any available maps, plans, specifications, and subsurface information are on file for inspection in the office of the Tukwila City Engineer, at the Public Works Department.

All bid proposals shall be submitted according to the Information for Bidders and be accompanied by a bid proposal deposit in the form of a cash deposit, certified or cashier's check, postal money order, or surety bond made payable to the City of Tukwila, for a sum not less than five percent (5%) of the amount of such bid, including sales tax. Should the successful bidder fail to enter into such contract and furnish satisfactory payment and performance bonds within the time stated in the specifications, the bid deposit/bond shall be forfeited to the City of Tukwila.

The City of Tukwila in accordance with Title VI of the Civil Rights Act of 1964, 78 Stat. 252, 42 U.S.C. 2000d to 2000-4 and Title 49, Code of Federal Regulations, Department of Transportation, Subtitle A, Office of the Secretary, Part 21, Nondiscrimination in Federally- Assisted programs of the Department of Transportation issued pursuant to such Act, hereby notifies all bidders that it will affirmatively ensure that in any contract entered into pursuant to this advertisement, disadvantaged business enterprises as defined at 49 CFR Part 26 will be afforded full opportunity to submit bids in response to this invitation and will not be discriminated against on the grounds of race, color, national origin, or sex in consideration for an award.

The City reserves the right to reject any and all bids or waive any informalities in the bidding and make the award as deemed to be in the best interest of the City.

CITY OF TUKWILA, Christy O'Flaherty, MMC, Records Governance Manager/City Clerk

Published Seattle Times: March 3, 2020 and March 10, 2020
Published Daily Journal: March 3, 2020 and March 10, 2020