



City of Tukwila Transportation and Infrastructure Services Committee

- ❖ Tosh Sharp, Chair
- ❖ Mohamed Abdi
- ❖ Kate Kruller

Distribution: K. Kruller C. Hougardy T. Sharp H. Ponnekanti S. Kim (email) G. Lerner (email)	City Attorney (email) Clerk File Copy Place pkt pdf on SharePoint Z Trans & Infra Agendas email cover to: F. Ayala, A. Le, C. O'Flaherty, A. Youn, B. Saxton, S. Norris, L. Humphrey
---	---

AGENDA

MONDAY, MARCH 6, 2023 – 5:30 PM

HYBRID MEETING – ONSITE AND VIRTUAL

DUWAMISH CONFERENCE ROOM, 6300 BUILDING, 2ND FLR

MS Teams: [Click here to join the meeting](#)

Virtual Meeting - Members of the public may listen by dialing 1-253-292-9750 and entering conference ID 439818817#

Item	Recommended Action	Page
1. PRESENTATIONS		
2. BUSINESS AGENDA		
a) Test-to-Fit Update (B. Miles)	a) Discussion only	Pg. 1
b) Public Works Shops Maintenance & Engineering Building (PW-MEB) Proj. – Amendment No.1 (B. Miles)	b) Forward to the 03/20/23 Regular Consent Agenda	Pg. 23
c) 2023 Annual Overlay Program, Engineering Services Contract – Amendment No.1 (J. Hartley)	c) Forward to the 03/20/23 Regular Consent Agenda	Pg. 29
d) 2021 Annual Small Drainage Program Project Completion & Acceptance (S. Edquid)	d) Forward to the 03/20/23 Regular Consent Agenda	Pg. 37
e) Surface Water Fund – Chinook Wind Extension OSRC Grant Application (B. Robinson)	e) Committee approval	Pg. 41
f) Transportation Element Comprehensive Plan – Safe Streets & Roads for All Grant Award (B. Robinson)	f) Forward to the 03/20/23 Regular Consent Agenda	Pg. 43
g) Allentown Truck Reroute EIS Outreach Update (M. Hafis)	g) Discussion only	Pg. 45
3. MISCELLANEOUS		

Next Scheduled Meeting: March 20, 2023

TUKWILA PUBLIC WORKS

Maintenance and Engineering Building

Test-to-Fit Phase March 6, 2023



Safe • Efficient • Functional • Forward-looking

1. Consolidate all Public Works functions to one location.
2. Provide a safe environment for employees and visitors. Support employee well-being.
3. Convey the Department's values to its customers and employees.
4. Provide a resilient facility that can function following a natural disaster event
5. Be stewards of the environment
6. Reduce ongoing maintenance of facilities and realize value in leasing or selling underutilized properties.



S 112th St

SCL Easement
(leased)

SCL Easement (will be city owned)

Tukwila Intl Blvd (Arterial)

East Marginal Way S (Arterial)

Lot Size
3.95 acres

Lot Size
6.9 acres

Duwamish River

**Tukwila Public Works
M&E Building**

March 6, 2023

Miller Hayashi Architects

Goal: Provide a safe environment for employees and visitors and improve employee well being

- **Improve entrances and intersections for safe traffic flow**
- **New dedicated truck entrances separate from new visitor entrance**
- **Adequate turning radius for largest trucks**
- **Clearly identified pedestrian circulation**
- **Secure fencing with controlled entrances**
- **Site Lighting throughout (with particular attention to 24/7 operations)**
- **Security cameras and site lines for supervision**

Goal: Provide a resilient facility that will last and can function following a natural disaster event

- Site is situated above the 500 year flood plane.
- Invest in structure designed to 'essential facility' standards
- Provide emergency power generation.
- Provide on-site solar power system or plan infrastructure to support future solar power.
- Evaluate potential for on-site energy storage capacity.

Goal: Convey the Department's values to its customers and employees.

- Invest in technologically advanced, industry leading, forward- looking facilities
- Plan capacity to meet future program needs
- Display for Public Works achievements
- Building embodies the Public Works vision

Goal: Stewards of the environment

- Energy efficient systems
- Staff training on system operation
- High performance building envelope
- Consider geothermal energy and solar power
- Thoughtful material selection (from structural system to finishes)
- Reduce impervious surfaces
- Treat stormwater before discharging
- Restore habitat along Duwamish River

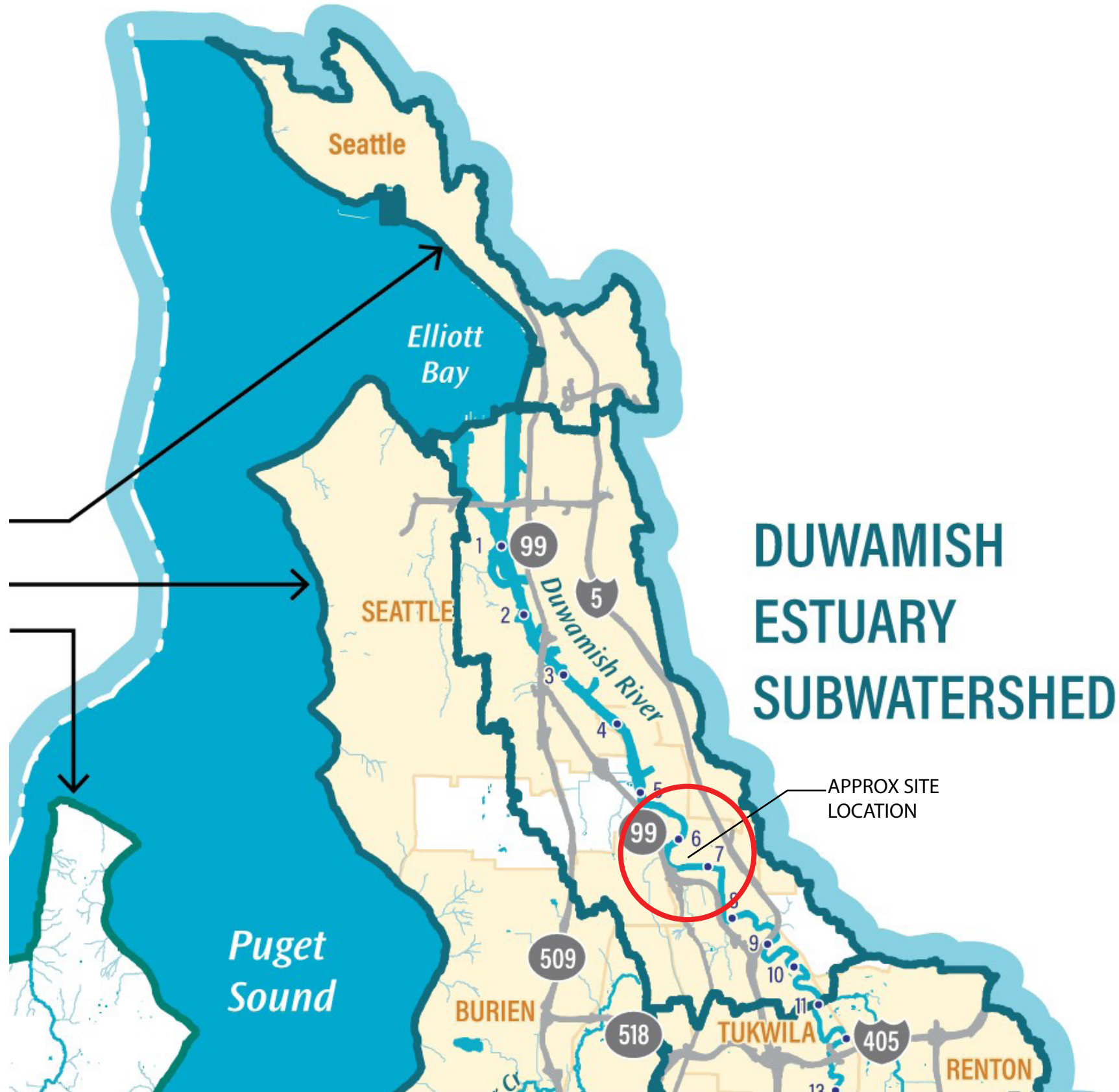

SALMON REARING HABITAT

The site has potential to provide shallow water rearing habitat for juvenile salmonids which is critical to increasing salmonid survival and restoring this key species to the river.



Excerpt from Green/Duwamish River Watershed; Salmon Habitat Plan 2021

**Tukwila Public Works
M&E Building**

March 6, 2023

Miller Hayashi Architects

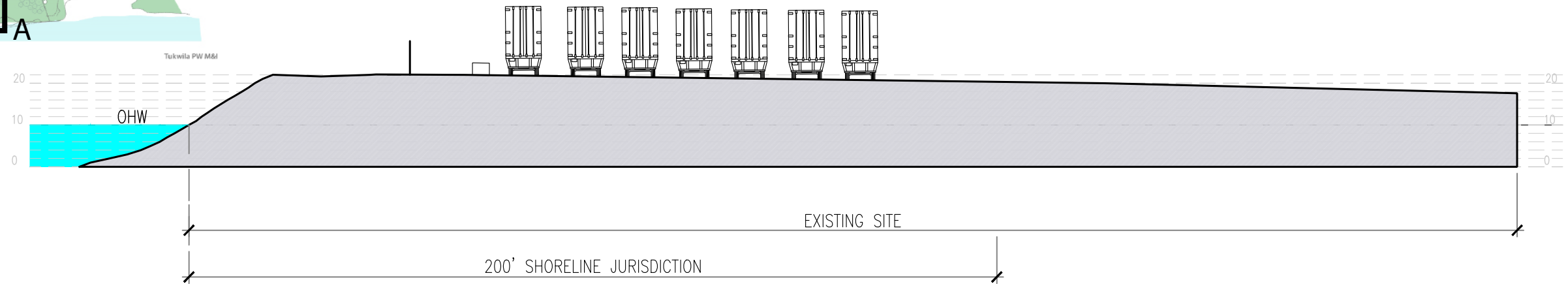
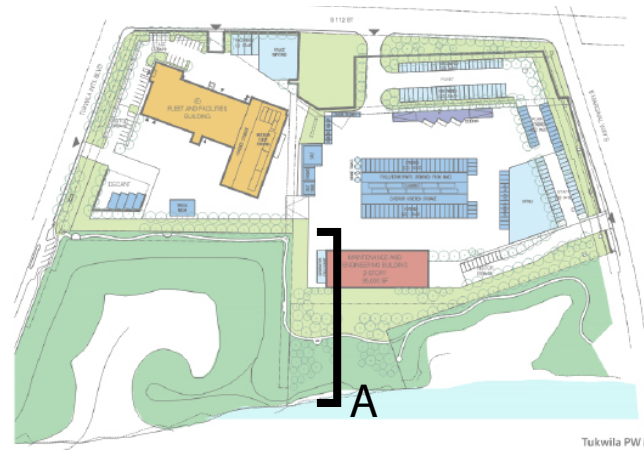

SECTION A: EXISTING SITE SECTION THROUGH RESTORATION PARCEL

SCALE: 1:30

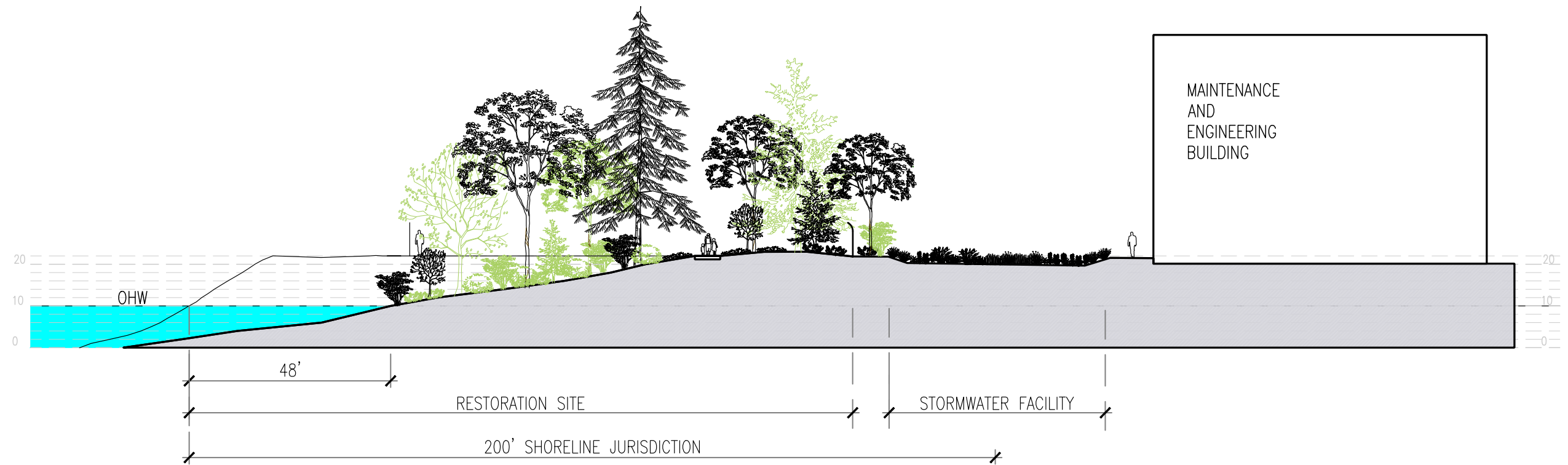

SECTION A': VIEW WEST FROM RESTORATION SITE

SCALE 1:30

**Tukwila Public Works
M&E Building**

March 6, 2023

Miller Hayashi Architects

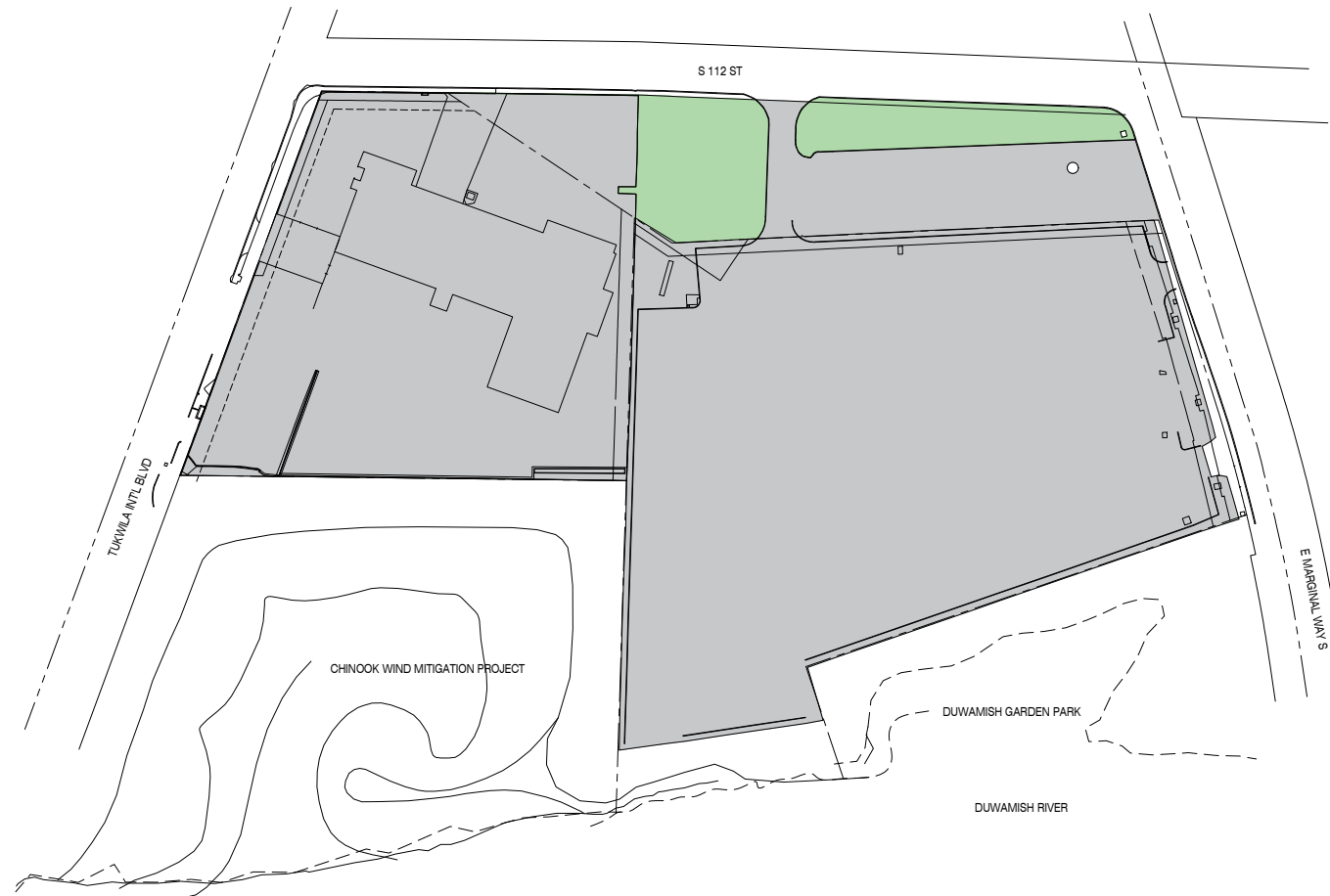

93% Impervious Surface
EXISTING

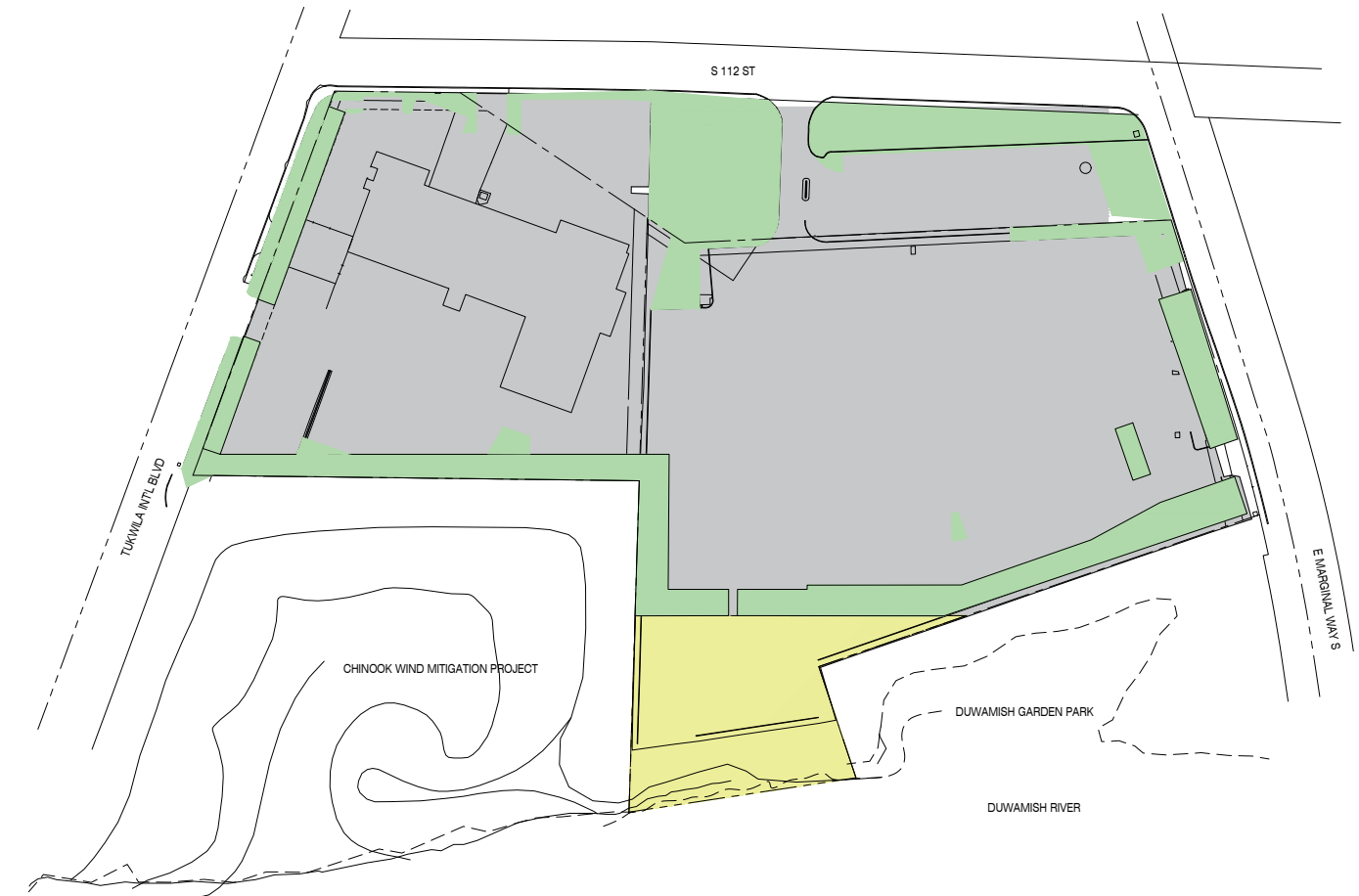

70% Impervious Surface
TEST-FIT CONCEPT

Goal: Reduce cost related to ongoing maintenance of facilities and realize value in leasing or selling under utilized properties.

- Durable finishes (easy to clean, water resistant and slip resistant)
- Infrastructure for future expansion
- Flexible, adaptable spaces
- Durable paving surfaces to reduce future maintenance
- Life cycle cost analysis for systems selection

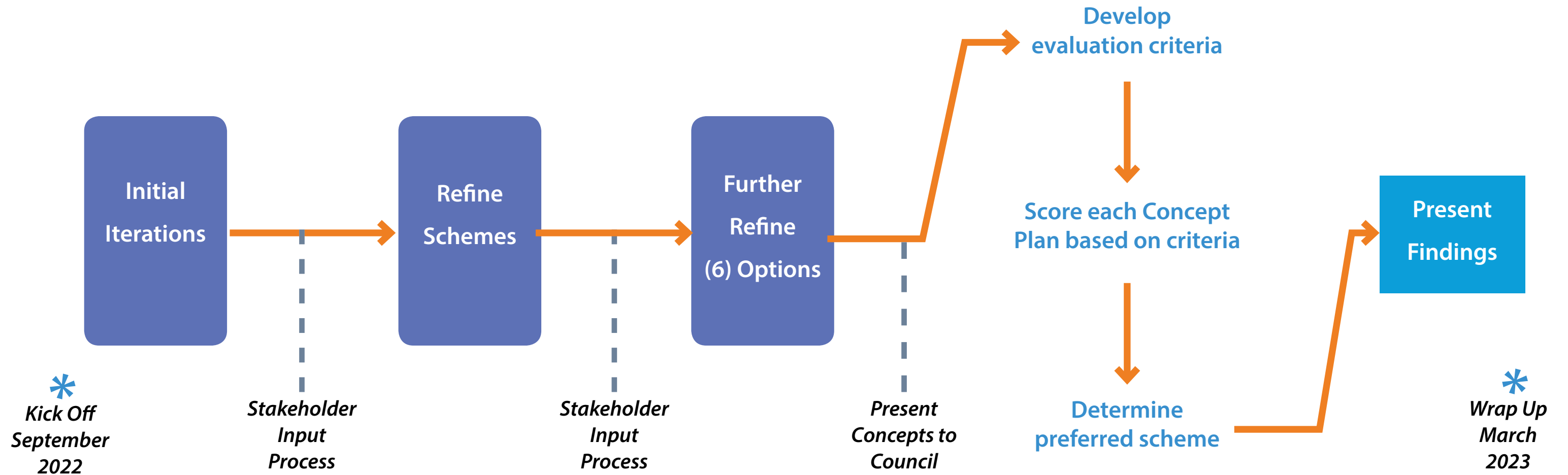

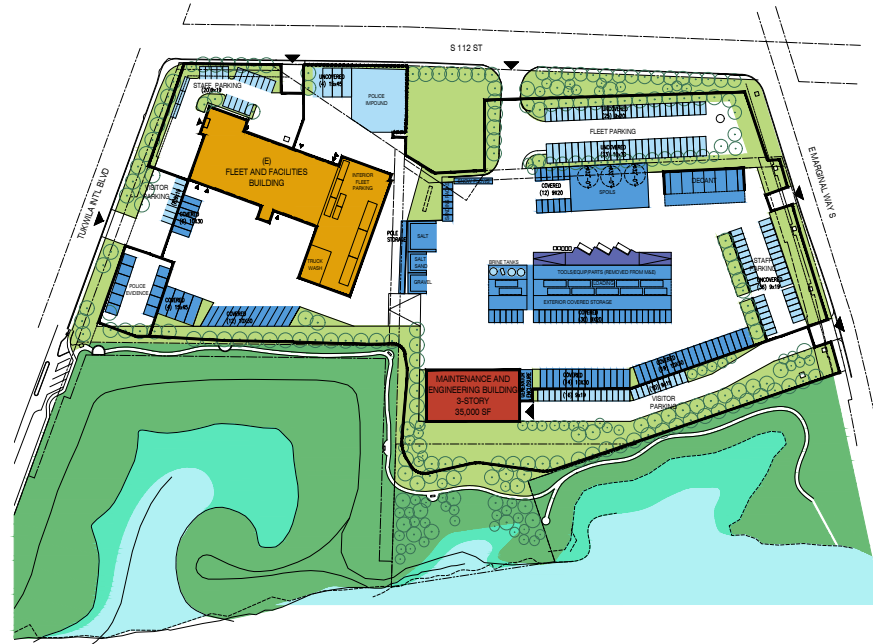

SCHEME A

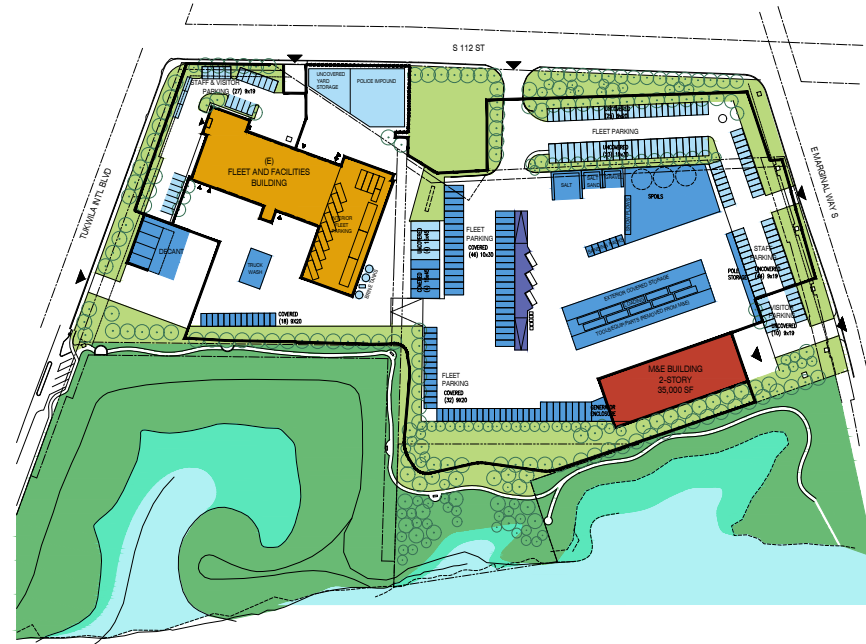

SCHEME B



SCHEME C

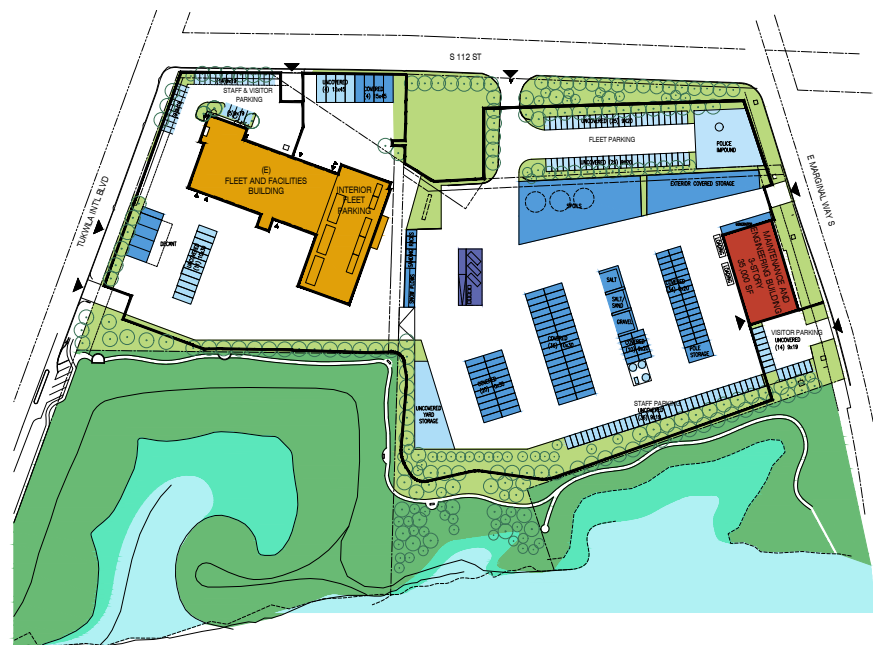

SCHEME D



SCHEME E

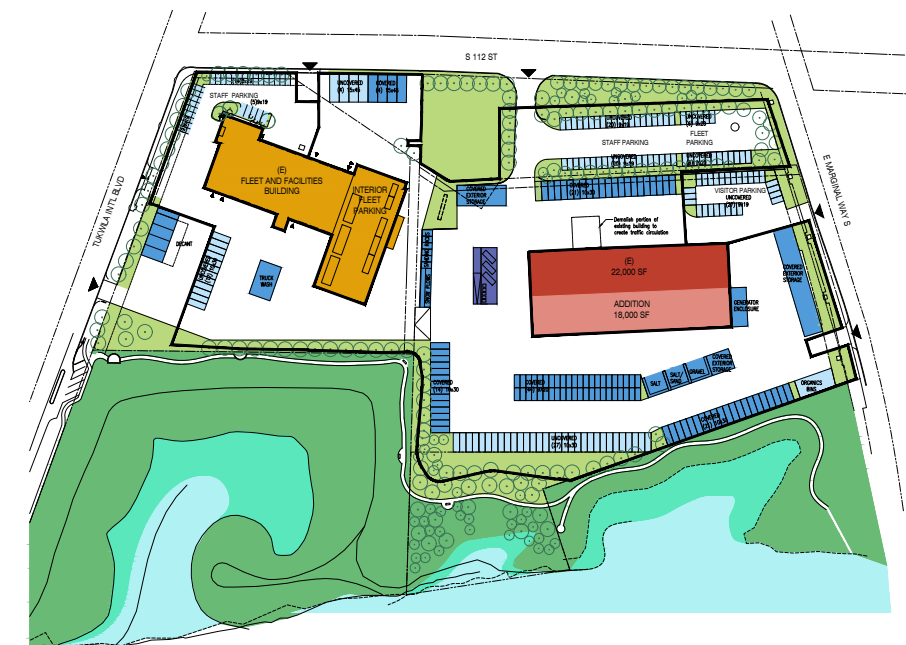

SCHEME F

Tukwila Public Works
M&E Building

March 6, 2023

Miller Hayashi Architects

ID #	Criteria Description
"Big Picture" Criteria (pass/fail)	
1.1	Provides for Department of Ecology waiver requirements
1.2	Provides for code required stormwater facilities
1.3	Located above 500 year flood plane
1.4	Provides for future capacity
Public Works Staff Input	
2.0	Public Works Staff Preferences & Recommendations
Program Elements and Flow	
2.1	Public Works site program elements provided
2.2	Public Works covered parking provided
2.3	Public Works uncovered parking provided
2.4	Decant facility located adjacent to Spoils
2.5	Accommodates Drive Through Tool Storage
2.6	Accommodates Drive Through Dumpster Platform
2.7	Police Evidence Provided
2.8	Police Impound Provided
Campus, Access, Security, and Identity	
Building location allows for M&E visitor parking to be separated from	
3.1	staff parking
3.2	F&F visitor parking separated from staff parking
3.3	Improves entrance from Tukwila Int'l Blvd
3.4	Provides for new security fence
3.5	Provides for new site lighting and security cameras
3.6	Efficient walking route between F&F and M&E buildings
3.7	Efficient walking distance from M&E to site program
3.8	Building location high-vis to the public
3.9	Building location takes advantage of amenity view to river
3.10	Utilizes existing driveway locations at E Marginal Way S
Environment and Sustainability	
4.1	Building orientation optimized for passive solar access
4.2	Opportunity for solar panels over covered parking or roof
4.3	Opportunity for EV charging infrastructure
4.4	Reduces impervious surfaces
4.5	Habitat and trail connection to adjacent restoration areas

EVALUATION CRITERIA

ID #	Criteria Description	Importance
"Big Picture" Criteria (pass/fail)		
1.1	Provides for Department of Ecology waiver requirements	Essential
1.2	Provides for code required stormwater facilities	Essential
1.3	Located above 500 year flood plane	Essential
1.4	Provides for future capacity	Essential
Public Works Staff Input		
2.0	Public Works Staff Preferences & Recommendations	1.00
Program Elements and Flow		
2.1	Public Works site program elements provided	1.00
2.2	Public Works covered parking provided	1.00
2.3	Public Works uncovered parking provided	1.00
2.4	Decant facility located adjacent to Spoils	1.00
2.5	Accommodates Drive Through Tool Storage	0.75
2.6	Accommodates Drive Through Dumpster Platform	0.75
2.7	Police Evidence Provided	0.50
2.8	Police Impound Provided	0.50
Campus, Access, Security, and Identity		
Building location allows for M&E visitor parking to be separated from		
3.1	staff parking	1.00
3.2	F&F visitor parking separated from staff parking	1.00
3.3	Improves entrance from Tukwila Int'l Blvd	1.00
3.4	Provides for new security fence	1.00
3.5	Provides for new site lighting and security cameras	1.00
3.6	Efficient walking route between F&F and M&E buildings	0.75
3.7	Efficient walking distance from M&E to site program	0.75
3.8	Building location high-vis to the public	0.50
3.9	Building location takes advantage of amenity view to river	0.50
3.10	Utilizes existing driveway locations at E Marginal Way S	0.50
Environment and Sustainability		
4.1	Building orientation optimized for passive solar access	1.00
4.2	Opportunity for solar panels over covered parking or roof	1.00
4.3	Opportunity for EV charging infrastructure	1.00
4.4	Reduces impervious surfaces	0.75
4.5	Habitat and trail connection to adjacent restoration areas	0.50

Criteria Weighted by Importance

- "Most Important" x1.00**
- "Very Important" x0.75**
- "Somewhat Important" x0.50**

**Tukwila Public Works
M&E Building**

March 6, 2023

Miller Hayashi Architects

Example

	Scheme A	Scheme B	
Criteria 1	2	3	Initial Score
Criteria 2	3	2	
Initial Scores	5	5	← Tie
Criteria 1 (x 1.0)	2 x 1.0 = 2	3 x 1.0 = 3	Weighted Score
Criteria 2 (x 0.5)	3 x 0.5 = 1.5	2 x 0.5 = 1	
Weighted Score	3.5	4	

Criteria Weighted by Importance

- “Most Important” x1.00
- “Very Important” x0.75
- “Somewhat Important” x0.50

Possible scores applied to criteria

- 3 = Excellent
- 2 = Good
- 1 = Fair
- 0 = Poor / Not Provided

Criteria ID #	Criteria Description	Criteria Importance	Concept A		Concept B		Concept C		Concept D		Concept E		Concept F	
			Initial Score	Weighted Total	Initial Score	Weighted Total	Initial Score	Weighted Total	Initial Score	Weighted Total	Initial Score	Weighted Total	Initial Score	Weighted Total
"Big Picture" Criteria (pass/fail)														
1.1	Provides for Department of Ecology waiver requirements	Essential	✓		✓		✓		✓		✓		✓	
1.2	Provides for code required stormwater facilities	Essential	✓		✓		✓		✓		✓		✗	
1.3	Located above 500 year flood plane	Essential	✓		✓		✓		✓		✓		✓	
1.4	Provides for future capacity	Essential	✓		✓		✓		✓		✓		✗	
Public Works Staff Input														
2.0	Public Works Staff Preferences & Recommendations	1.00	3	3	2	2	0	0	0	0	1	1	0	0
Program Elements and Flow														
2.1	Public Works site program elements provided	1.00	3	3	3	3	3	3	3	3	3	3	1	1
2.2	Public Works covered parking provided	1.00	3	3	3	3	3	3	3	3	3	3	3	3
2.3	Public Works uncovered parking provided	1.00	3	3	3	3	3	3	3	3	3	3	3	3
2.4	Decant facility located adjacent to Spoils	1.00	3	3	0	0	0	0	0	0	2	2	0	0
2.5	Accommodates Drive Through Tool Storage	0.75	3	2.25	2	1.5	0	0	0	0	3	2.25	0	0
2.6	Accommodates Drive Through Dumpster Platform	0.75	3	2.25	2	1.5	0	0	0	0	3	2.25	0	0
2.7	Police Evidence Provided	0.50	2	1	0	0	0	0	0	0	0	0	0	0
2.8	Police Impound Provided	0.50	2	1	2	1	2	1	1	0.5	2	1	0	0
Campus, Access, Security, and Identity														
3.1	Building location allows for M&E visitor parking to be separated from staff parking	1.00	3	3	3	3	1	1	3	3	3	3	2	2
3.2	F&F visitor parking separated from staff parking	1.00	3	3	1	1	0	0	0	0	3	3	0	0
3.3	Improves entrance from Tukwila Int'l Blvd	1.00	3	3	3	3	3	3	3	3	3	3	3	3
3.4	Provides for new security fence	1.00	3	3	3	3	3	3	3	3	3	3	3	3
3.5	Provides for new site lighting and security cameras	1.00	3	3	3	3	3	3	3	3	3	3	3	3
3.6	Efficient walking route between F&F and M&E buildings	0.75	2	1.5	1	0.75	1	0.75	0	0	3	2.25	1	0.75
3.7	Efficient walking distance from M&E to site program	0.75	3	2.25	3	2.25	3	2.25	2	1.5	0	0	1	0.75
3.8	Building location high-vis to the public	0.50	2	1	2	1	1	0.5	1	0.5	3	1.5	0	0
3.9	Building location takes advantage of amenity view to river	0.50	3	1.5	3	1.5	0	0	0	0	3	1.5	0	0
3.10	Utilizes existing driveway locations at E Marginal Way S	0.50	3	1.5	3	1.5	0	0	0	0	3	1.5	3	1.5
Environment and Sustainability														
4.1	Building orientation optimized for passive solar access	1.00	3	3	2	2	2	2	0	0	1	1	3	3
4.2	Opportunity for solar panels over covered parking or roof	1.00	3	3	3	3	3	3	3	3	3	3	3	3
4.3	Opportunity for EV charging infrastructure	1.00	3	3	3	3	3	3	3	3	3	3	3	3
4.4	Reduces impervious surfaces	0.75	3	2.25	3	2.25	2	1.5	2	1.5	3	2.25	1	0.75
4.5	Habitat and trail connection to adjacent restoration areas	0.50	3	1.5	3	1.5	3	1.5	3	1.5	3	1.5	3	1.5
Subtotal Weighted Score			57		46.75		34.5		32.5		50		32.25	
Weighted Ranking			1st		3rd		4th		5th		2nd		6th	



Tukwila Public Works
M&E Building

March 6, 2023
Miller Hayashi Architects

COUNCIL APPROVAL PROCESS

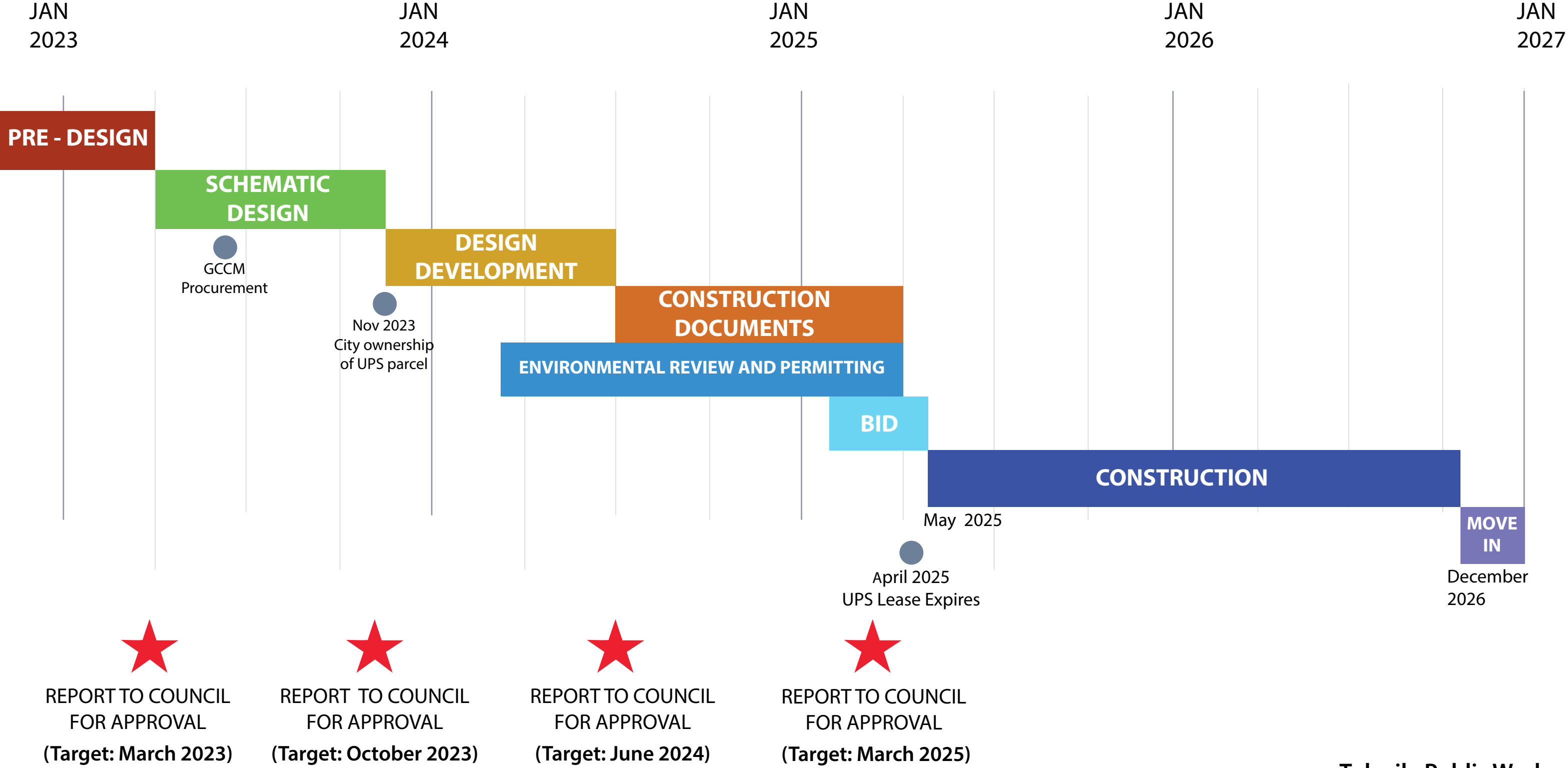

Tukwila Public Works M&E Building

March 6, 2023
Miller Hayashi Architects

CONCEPTUAL "ALL IN" MASTER PLAN COST

West Site Preparation, Demolition, Grading, Paving, Utilities (3.95 acres)	\$ 3,949,000
West Site Structures (covered parking, police evidence, truck wash)	\$ 2,700,000
East Site Preparation, Demolition, Grading, Paving, Utilities (6.90 acres)	\$15,271,000
East Site Structures (covered parking, spoils, salt/sand/gravel)	\$ 4,924,000
Maintenance & Engineering Building	\$16,445,000
Tool Storage Building	\$ 1,248,000
Shoreline Restoration	\$ 1,528,000
Decant Facility	\$ 770,000
<hr/>	
Sub-Total Construction Cost	\$46,835,000
Escalation to Jan 2026 <i>(at 7% for the first year and compounded at 4.5% per year thereafter)</i>	\$ 7,678,000
<hr/>	
Construction Cost including escalation	\$54,513,000
Project Related Costs	\$29,352,000
<hr/>	
Master Plan Conceptual Project Cost	\$83,865,000

**Tukwila Public Works
M&E Building**

March 6, 2023

Miller Hayashi Architects



Tukwila Public Works Operations Campus, Phase 2

MARCH 6, 2023

TRANSPORTATION AND INFRASTRUCTURE SERVICES

Next Steps

- **March 13, Committee of the Whole: Briefing to Full Committee**
- **TBD, TIS: Contract for Design**
- **TBD, COW: Contract for Design**
- **TBD, Regular Council: Authorize Design Contract**
- **TBD, City Council: Schematic Design Check In, Updated Costs**
- **November 1, 2023, City Takes ownership of east parcel.**
- **TBD, City Council: Design Development, Updated Costs**
- **March 2025, City Council: Design Development, Construction Documents, Final Cost Estimates, Go to Bid.**



INFORMATIONAL MEMORANDUM

TO: **Transportation and Infrastructure Committee**
 FROM: **Brandon Miles, Property Management Lead**
 CC: **Mayor Ekberg**
 DATE: **February 28, 2023**
 SUBJECT: **Public Works Shops Maintenance & Engineering Building(PW-MEB) Project
 Project No.: 92230601
 Project Management – Shiels Obletz Johnsen, Inc – Amendment No 1**

ISSUE

Execute Amendment No 1 to contract 22-119 with Shiels Obletz Johnsen, Inc (SOJ) to provide continued project management services for Public Works Maintenance & Engineering Building Project during the architect and engineering firm’s “Test to Fit Site and Program Analysis” and procurement of owner’s consultants. The original contract had estimated completion of this phase of work at the end of December, 2022 and it is now expected to be extended into April, 2023.

BACKGROUND

The City will receive full ownership of the Eastern Parcel on November 1, 2023. It is recommended to begin preparing now for the construction of the structures on this site and especially those structures that will be located within the shoreline jurisdiction buffer areas – thereby securing the City’s full potential for buildable areas. As project design, permitting and bidding process can take up to two years on a substantial development of a new building, it is recommended that the Public Works Utilities and Street Administration building (which is planned in the protected area) design process begin as soon as possible.

The City is still considering the full project cost and a financing strategy for the project. A key decision point is the total design cost for the project. Staff would like to have SOJ procure cost for consultants in order to get an updated design cost for the next phase, should the City Council provide authorization to move from the “test to fit” phase to the design phase.

DISCUSSION

SOJ has provided a proposal to manage and oversee the remainder of “Test to Fit Site and Program Analysis” phase and the procurement of owner’s consultants for the PW-MEB project. Note, approving this amendment will not obligate the City to move forward with design or construction.

FISCAL IMPACT

The expenditures associated with these tasks are anticipated and are included in the council approved project budget. SOJ has provided a proposed amount of \$39,660 to perform the services in their contract amendment scope of work. Their total not to exceed contract amount will now be \$78,238.

SOJ Contract #22-120	
Original Amount	\$38,578.00
Amendment No 1	\$39,660.00
New Contract Total	\$78,238.00

The table below shows the total Test-to-Fit costs. The proposed amendment cost will be coming from the Contingency (Highlighted in the table below), and therefore we are still included in the City Council approved budget of \$350,000.

Full Test-to-Fit Analysis Costs		
<i>Contract Title</i>	<i>Firm</i>	<i>Cost</i>
Test-to-fit Design	Miller Hayashi	\$188,727.00
	Miller Hayashi (Amendment #1)	\$14,610
Geotech Exploration	Langan	\$36,600.00
Surveying	David Evans & Associates	\$25,000.00
Project Management	Shiels Oblatz Johnsen	\$38,578.00
	Shiels Oblatz Johnsen (Amendment #1)	\$39,660.00
	Total:	\$343,175.00
<i>Management Reserve/Contingency</i>	<i>As of February 27, 2023</i>	<i>\$46,485.00</i>
<i>Remaining Contingency After Amendment</i>	<i>Remaining Management Reserve Contingency After SOJ Amendment,</i>	<i>\$6,825.00</i>

RECOMMENDATION

Approve the project management contract amendment for Shiels Oblatz Johnsen to oversee the remainder of the Test-to-Fit Analysis and aid in the procurement of the owner’s consultants for the Tukwila M&E Building Project. SOJ will also be able to assist the City in examining possible phasing to spread out project costs over a longer period. The proposed amendment would be placed on the March 20 consent agenda.

Alternatives

- The Council could authorize only the work of SOJ to get the City through the remaining test to fit analysis and defer obtaining consultant estimates until after the City Council makes a decision on the construction of the Public Works Campus, Phase 2. This would be approximately \$33,90. The project team is trying to hit a specific construction window, with work commencing on the site on May 1, 2025. If we delay getting estimates for the consultant work, it would delay the City’s project and the City would likely miss it’s construction window. Staff is estimating that for every one month delay it could increase the project cost by \$320,000 per month in cost escalation.

ATTACHMENTS:

- Proposed Shiels Oblatz Johnsen Contract Amendment No. 1 and Proposal.



City of Tukwila

6200 Southcenter Boulevard, Tukwila WA 98188

Agreement Number: 22-120(a)

CONTRACT FOR SERVICES

Amendment No. 1

Between the City of Tukwila and Shiels Oblatz Johnsen, Inc.

That portion of Contract No. 22-120 between the City of Tukwila and Shiels Oblatz Johnsen, Inc. is hereby amended as follows:

Section 1 Project Designation: The Consultant is retained by the City to perform Project Management services in connection with the project titled Tukwila Public Works Shops Maintenance & Engineering Building Project.

Section 2 Scope of Services: The Consultant agrees to perform the services, identified on Exhibit "A" attached hereto, including the provision of all labor, materials, equipment and supplies.

Section 4 Payment: The Consultant shall be paid by the City for completed work and for services rendered under this Agreement as follows:
Payment for the work provided by the Consultant shall be made as provided on Exhibit "A" attached hereto, provided that the total amount of payment to the Consultant shall not exceed \$78,238.00 (including estimated expenses) without express written modification of the Agreement signed by the City. The total amount for this amendment is \$39,660.

All other provisions of the contract shall remain in full force and effect.

Dated this _____ day of _____, 2023.

CITY OF TUKWILA

CONTRACTOR

Allan Ekberg, Mayor

DocuSigned by:
Brad Tong
A41BEDB9A160463

Brad Tong, President

ATTEST/AUTHENTICATED

APPROVED AS TO FORM

Christy O'Flaherty, MMC, City Clerk

Office of the City Attorney



February 13, 2023

Hari Ponnekanti
Director of Public Works
6200n Southcenter Blvd.
Tukwila WA 98188

Project: Tukwila Public Works Shops Maintenance & Engineering Building Project

Subject: Proposal for Amendment No 1 to Contract #22-120, SOJ Project Management Services for Tukwila Public Works Maintenance & Engineering Building Project

Dear Hari:

SOJ is please to submit our proposal to continue to oversee and assist with management of the test-to-fit process, council presentations and to help the City of Tukwila procure the owner's consultants for the Tukwila Public Works Shops Maintenance & Engineering Building Project.

Fee

\$39,660 (including \$1,500 of reimbursable expenses) for continued assistance with the management of the test-to-fit process and the procurement of owner's consultants on the Public Works Shops Maintenance & Engineering Building Project.

Duration

We are forecasting this proposal to cover our efforts from February 2023 through the end of April 2023.

Scope of Services

- Overseeing the test-to-fit scope of work.
- Attend weekly meetings with Architect.
- Assist with council presentation preparation and meeting attendances
- Procurement of owner consultants
- Update Owner with status reports

We appreciate your consideration of the above and look forward to your response.

Sincerely,

A handwritten signature in blue ink that reads "Justine Kim".

Justine Kim
Partner / SOJ
Cc: File

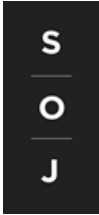

Public Works Shops Maintenance & Engineering Building Oversight - Amendment No 1 2/13/2023

	2023\$ Rates	February	March	April		Total Hrs
--	--------------	----------	-------	-------	--	-----------

Rates are 2023\$

Justine Kim Est. Hours Billing Rate: \$265/hour	\$ 265	28	28	28		84	\$22,260
Matt Strutynski Est. Hours Billing Rate: \$105/hour	\$ 105	20	20	20		60	\$6,300
Yu-Ann Youn Est. Hours Billing Rate: \$80/hour	\$ 80	40	40	40		120	\$9,600

Equivalent FTE: **\$38,160**

Reimbursable Expenses 500 500 500 \$1,500

Total for Amendment No 1: **\$39,660**



INFORMATIONAL MEMORANDUM

TO: **Transportation & Infrastructure Services Committee**
 FROM: **Hari Ponnekanti, Public Works Director/City Engineer**
 BY: **Josh Hartley, Public Works Deputy Director Transportation**
 CC: **Mayor Allan Ekberg**
 DATE: **March 3, 2023**
 SUBJECT: **2023 Annual Overlay Program - Engineering Services Contract**
Project No. 92210301
Contract No. 23-012, Amendment No. 1

ISSUE

Execute Amendment No. 1 to Contract No. 23-012, with KPG Psomas, Inc. (KPG), to include the 119th St. Pedestrian Crossing design and construction management services into the 2023 Annual Overlay Program contract.

BACKGROUND

Every year, Public Works (PW) issues a construction project to grind and overlay several blocks of roadways in the City of Tukwila. The annual overlay program is intended to preserve and maintain the street structure in a safe and useable state by resurfacing before failure, which also minimizes costs. Before work can commence, an engineer of record is required to prepare, design, and manage construction of the project. KPG provides a unique blend of knowledge and understanding of the City's overlay program that provides efficiency and benefits which cannot be matched at this time by any other firm. KPG has also performed very well in providing construction management services.

DISCUSSION

As part of the program described above, PW has a grant that funds the design and construction of a raised crosswalk located on 42nd. Ave. S and S. 119th St. that will provide a safer, more accessible pedestrian crossing. PW included this design into the overlay program to ensure that it is constructed timely. As a standalone project, the 119th pedestrian crosswalk could result on little to zero construction bids. By including it in the overlay program, the scope of work is bundled with other work and becomes more attractive to prospective bidders. KPG has provided an amendment, scope of work, and fee estimate to complete the design of the S. 119th crosswalk and advertise for construction bids.

FINANCIAL IMPACT

	<u>KPG Contract</u>	<u>Fund Source</u>	<u>Budget</u>
Original Contract (Overlay)	\$149,824.00	Overlay CIP	\$150,000.00
Amendment 1 (119 th Crosswalk)	<u>\$52,254.00</u>	TIB Grant	<u>175,000.00</u>
Total Contract Amount:	\$202,078.00		\$325,000.00

RECOMMENDATION

Approve Amendment No. 1 to Contract No. 23-012 for KPG on the 2023 Annual Overlay Program and consider this item on the Consent Agenda at the March 13, 2023, Council Meeting.

ATTACHMENTS:

S. 119th Pedestrian Crossing CIP Page
KPG 2023 Overlay Consultant Contract - Amendment 1 Proposal

CITY OF TUKWILA CAPITAL PROJECT SUMMARY

2023 to 2028

PROJECT: **S 119th St Bridge/ 42nd Ave S Raised Crosswalk and RRFB** Project No. 92210301

DESCRIPTION: Install raised crosswalk, curb bulbs, and a Rectangular Rapid Flashing Beacon on 42nd Ave S at the intersection of the S 119th street pedestrian bridge.

JUSTIFICATION: Enhance safety for pedestrians crossing at S 119th Street/42nd Ave S and encourages transportation choices for the neighborhood.

STATUS:

MAINT. IMPACT: New crosswalk and pedestrian flashing beacon will need to be maintained.

COMMENT: Residential improvements and traffic calming features to reduce speeds and improve pedestrian and bicycle safety. Grants submitted to WSDOT and TIB for 2023/2024 funding.

FINANCIAL (in \$000's)	Through Estimated									TOTAL
	2021	2022	2023	2024	2025	2026	2027	2028	BEYOND	
EXPENSES										
Design			30							30
Land (R/W)										0
Const. Mgmt.			35							35
Construction			185							185
TOTAL EXPENSES	0	0	250	0	0	0	0	0	0	250
FUND SOURCES										
Proposed Grant			175							175
Awarded Grant										0
Mitigation Expected										0
103 Fund Balance	0	0	75	0	0	0	0	0	0	75
TOTAL SOURCES	0	0	250	0	0	0	0	0	0	250

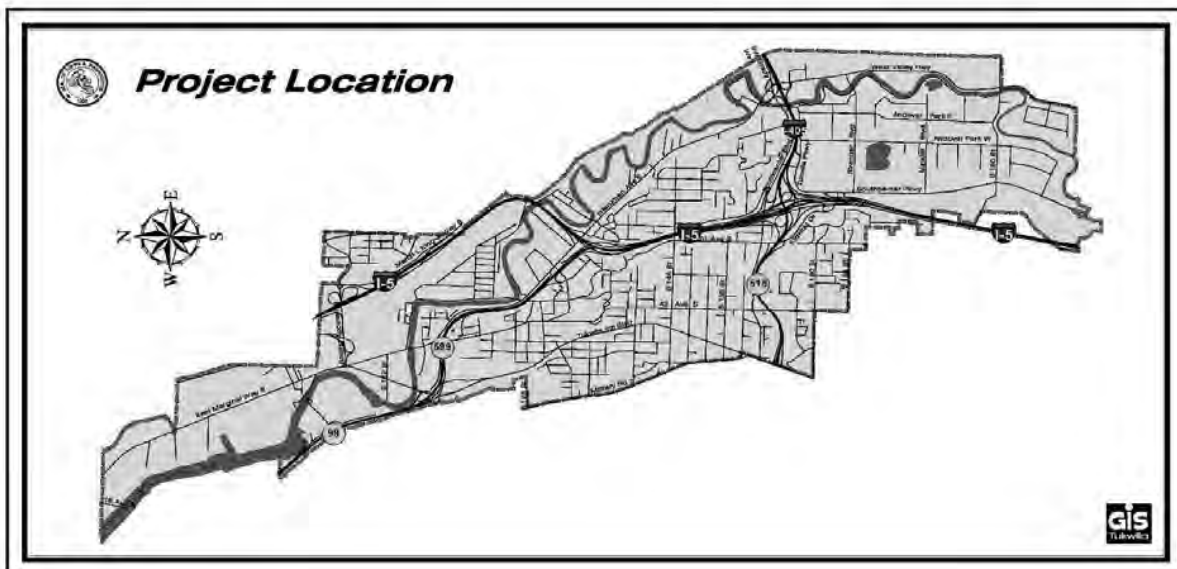



City of Tukwila

6200 Southcenter Boulevard, Tukwila WA 98188

Agreement Number:

CONTRACT FOR SERVICES

Amendment # 1

Between the City of Tukwila and KPG Psomas Inc.

That portion of Contract No. _____ between the City of Tukwila and _____
KPG Psomas Inc. is hereby amended as follows:

Section 2, Scope of Services, shall be amended with the following:

The Consultant agrees to provide the services in accordance with the scope of work included in the attached Exhibit A.

Section 4, Payment, shall be amended as follows:

An estimated budget for work provided by Consultant is included as Exhibit B, provided that the total amount of payment to the consultant under this agreement shall not exceed **\$202,078.00** (Orig PSA \$149,824.00 + this Amend 1 for \$52,254.00) without express written modification of the Agreement signed by the City.

All other provisions of the contract shall remain in full force and effect.

Dated this _____ day of _____, 20_____.

CITY OF TUKWILA

CONTRACTOR

Allan Ekberg, Mayor



Printed Name: Nelson Davis, Vice President

ATTEST/AUTHENTICATED

APPROVED AS TO FORM

Christy O'Flaherty, MMC, City Clerk

Office of the City Attorney

EXHIBIT A
City of Tukwila
2023 Overlay Program
Scope of Work
Amendment #1 – S 119th St Pedestrian Crossing
February 2023

The Consultant shall prepare final Plans, Specifications and Estimates for the S 119th St Pedestrian Crossing at the S 119th Pedestrian Bridge and 42nd Ave S located in the Allentown Neighborhood. The Plans will not be incorporated into the 2023 Overlay Program construction documents. This contract assumes that the design and construction are being implemented with monies received from the Transportation Improvement Board (TIB), WSDOT Pedestrian and Bicycle grant, and City funds as needed. All project provisions from the Original Scope of work shall apply. The below assumptions, deliverables, and scope shall supplement the original scope and apply to the S 119th St Location:

Deliverables

- 30% review submittal with Plans and Estimate (electronic copies)
- 90% review submittal with Plans, Specifications, and Estimate (electronic copies)
- Routing of Plans to utilities for review and comment
- Bid Documents and Engineer's Estimate.
- WSDOT Coordination and Documentation
- SEPA Permit
- DAHP Consultation
- Shoreline Permit

Assumptions for the S 119th St Pedestrian Crossing

- This will be a stand alone construction project and contract documents will be developed in a manner to solicit bids.
- This contract will utilize WSDOT Pedestrian / Bicycle Program Funds
- City will facilitate all coordination with granting agency.
- Full topographic survey will be completed by the consultant for the project location.
- Rapid Rectangular Flashing Beacons (RRFBs) will be of the solar power system type.
- City will provide and communicate updates to affected residents at this location.
- The consultant shall budget for attendance of up to two Allentown Meetings at the Tukwila Community Center.
- The site location will be separate bidding schedule for construction (Schedule B).

- Only surface utilities requiring adjustment to grade will be shown.
- Drainage Modifications may be required
- Lane widths and channelization types shall be replaced in kind unless otherwise decided upon in collaboration with the City.
- Driveways that are disturbed will be restored with like pavement.
- It is assumed there will be approximately eight (8) plan sheets at 1"=20' scale full size (22" X 34"), 1"=40' at reduced scale (11" X 17").
- Drainage & Water Quality Reports will not be required.
- SEPA documentation will be filled out by the consultant and submitted and administered by the City . No additional environmental permitting will be required by the consultant.
- Shoreline permit will be filled out by the consultant and submitted and administered by the City.
- DAHP EZ-01 form will be filled out and submitted by the Consultant on behalf of the City.
- Geotechnical exploration and/or investigation will not be required.
- Maximum Extent Feasible Documentation is not included in this scope of work
- Consultant shall not be responsible for printing and supplying City or Contractor with hard copies of plans and specifications at interim submittals or contract award.

SCOPE OF WORK

TASK 1 – Project Management

1.1 The Consultant shall provide continuous project management and administration for the duration of the Project. (Estimate 6 months).

- Hold project coordination meetings with the City to update progress and review submittals. Assume (6) meetings.
- The Consultant shall provide monthly status reports and billings.
- The Consultant shall provide independent QA/QC reviews by senior in-house staff of all deliverables prior to submittal to the City.

TASK 2 – Survey and Base mapping

2.1 Provide ground based topographic surveys to generate basemaps at a 1"= 20' scale and digital terrain model (DTM) in AutoCAD format of the project limits described above. Field survey shall pick up curbs, edges of gutter pan, drainage/sanitary sewer structures to include pipe diameters, grate and invert elevations, the next connecting drainage/sanitary sewer structure situated beyond the above-described mapping areas, water appurtenances to include valves, meters and hydrants, fences, utility surface features, field markings of existing utilities identified previous to the survey by a sub-contracted locate company, buildings/structure faces, building awnings, traffic and business signs, striping and trees.

One-foot contours will be generated from the DTM. Vertical datum is assumed to be NAVD 88.

TASK 3 – Design

3.1 The Consultant shall prepare 30% Plans and Estimate for the S 119th St Pedestrian crossing.

3.2 The Consultant shall prepare 90%, and Final Plans . The anticipated plan sheets include:

- Cover (1 sheet)
- Survey Control (1 sheet)
- Site Preparation Plan (1 sheet)
- Proposed Improvement Plan (1 sheet)
- Raised Crosswalk Detail Plan (1 sheet)
- RRFB Details (1 sheet)
- Traffic Control Plans (2 sheets)

TOTAL: (8 sheets)

3.3 The Consultant shall calculate quantities and prepare Engineers Estimate of Probable Construction Cost for in preparation for the bid documents and bid proposal.

3.4 The Consultant shall prepare the Contract Specification per 2023 WSDOT Standard Specifications for the 90% Review Submittal and the Bid Documents.

3.5 The consultant shall attend up to one community meetings at the TCC to provide project update on the S 119th St Pedestrian Crossing

TASK 4 – WSDOT and Permitting Coordination

4.1 The Consultant shall coordinate design approval and construction documents with the funding agencies for grant funding compliance.

4.2 The Consultant shall assist the City in preparation of the following permits:

- SEPA
- Shoreline Management
- DAHP EZ-01 Form

Deliverables

- 30% Plans
- 30% Cost Estimate
- 90% & Final Plans
- 90% & Final Cost Estimate
- 90% & Final Contract documents including site specific Special Provisions
- WSDOT Coordination
- Permitting

EXHIBIT B
PRIME CONSULTANT COST COMPUTATIONS

Client: City of Tukwila
Project 2023 Overlay Program
Amendment #1

DATE: 2/3/2023

Task No.	Task Description	Labor Hour Estimate									Total Hours and Labor Fee Estimate by Task	
		Principal	Senior Engineer	Project Engineer II	Project Engineer I	Design Engineer	Survey Manager	Survey Crew I (W/Equip)	Project Surveyor	Office Admin		
		285	215	175	149	133	251	205	164	103	Hours	Fee
Task 1 Project Management												
1.1	Project Management	4		20						8	32	\$ 5,464.00
	Task Total	4	0	20	0	0	0	0	0	8	32	\$ 5,464.00
Task 2 Survey and Basemapping												
2.1	Field Sruvey and Prepare Basemap						2	4	4		10	\$ 1,978.00
	Task Total	0	0	0	0	0	2	4	4	0	10	\$ 1,978.00
Task 3 Final Design												
3.1	Prepare 30% Plans		16	4	16	16					52	\$ 8,652.00
3.2	Prepare 90% Plans		8	8	20	16					52	\$ 8,228.00
3.3	Preapre 30%, 90%, Final Cost Estimates		12	12	20	12					56	\$ 9,256.00
3.4	Prepare 90% & Final Contract Documents	2	12	24							38	\$ 7,350.00
3.5	Community Meeting Preparation and Attendance	2		4							6	\$ 1,270.00
	Task Total	4	48	52	56	44	0	0	0	0	204	\$ 34,756.00
Task 4 WSDOT & Permitting Coordination												
4.1	WSDOT and TIB Coordination	4		16	8						28	\$ 5,132.00
4.2	Permitting	4		8	16						28	\$ 4,924.00
	Task Total	8	0	24	24	0	0	0	0	0	56	\$ 10,056.00
	Total Labor Hours and Fee	16	48	96	80	44	2	4	4	8	302	\$ 52,254.00
												Total Estimated Budget \$ 52,254.00



INFORMATIONAL MEMORANDUM

TO: **Transportation and Infrastructure Services Committee**
 FROM: **Hari Ponnekanti, Public Works Director**
 BY: **Sherry Edquid, Project Manager**
 CC: **Mayor Ekberg**
 DATE: **March 3, 2023**
 SUBJECT: **Surface Water Fund - 2021 Annual Small Drainage Program**
Project No. 92141201, Contract No. 21-138
Project Completion and Acceptance

ISSUE

Accept construction contract as complete and authorize release of retainage.

BACKGROUND

The Small Drainage Program constructs drainage projects throughout the City that are too large for city staff to complete, but are smaller than a typical capital improvement project. The 2021 Annual Small Drainage Program provided drainage improvements at these seven locations:

- | | |
|----------------------------|--------------------------------|
| 1) S. 124 th St | 5) S 166 th Ln |
| 2) 42 nd Ave S | 6) 48 th & 49 Ave S |
| 3) Thorndyke | 7) 57 th Ave S |
| 4) Klickitat Dr | |

DISCUSSION

The Notice to Proceed for Contract Number 21-138 with Titan Earthwork, LLC was issued on September 13, 2021 and construction was physically completed on January 22, 2022. COVID-19 related issues delayed final payment and subsequently closeout of this contract.

FINANCIAL IMPACT

The 2021 construction budget approved by Council was \$801,047.50, including a 10% contingency. Total project expenses were \$764,469.10, which is \$36,578.40 under budget. A retainage bond was held for this project.

	<u>Expenses</u>
Construction Contract Amount	\$728,225.00
Contingency (10%)	72,822.50
Overage/(Underage)	<u>(36,578.40)</u>
Total Expenses	\$764,469.10

RECOMMENDATION

Council is being asked to formally accept the 2021 Annual Small Drainage Program with Titan Earthwork, LLC. in the amount of \$764,469.10 as complete and authorize the release of retainage bond subject to standard claim and lien release procedures, and to consider this item on the Consent Agenda at the March 20, 2023 Regular Council Meeting.

Attachments: 2021 Small Drainage CIP
Notice of Completion, Contract #21-138

CITY OF TUKWILA CAPITAL PROJECT SUMMARY

2021 to 2026

PROJECT: Annual Small Drainage Program

Project No. 9xx41201
81241207

DESCRIPTION: Select, design, and construct small drainage projects throughout the City.

JUSTIFICATION: Provide drainage corrections for existing/ongoing drainage problems throughout the City, including culvert replacements, drain extensions, and pavement upgrades.

STATUS: Projects for this annual program are taken from Small Drainage Project List.

MAINT. IMPACT: Reduces maintenance.

COMMENT: Ongoing project, only one year shown in first column. Construction expenses may occur over two calendar years.

FINANCIAL (in \$000's)	Through Estimated									TOTAL
	2019	2020	2021	2022	2023	2024	2025	2026	BEYOND	
EXPENSES										
Design	74	92	100	100	100	100	110	110	80	866
Const. Mgmt.	40	68	100	100	100	100	110	110	80	808
Construction	108	515	700	700	700	700	750	750	513	5,436
TOTAL EXPENSES	222	675	900	900	900	900	970	970	673	7,110
FUND SOURCES										
Awarded Grant										0
Proposed Grant	65									65
Mitigation Actual										0
Mitigation Expected										0
Utility Revenue	157	675	900	900	900	900	970	970	673	7,045
TOTAL SOURCES	222	675	900	900	900	900	970	970	673	7,110

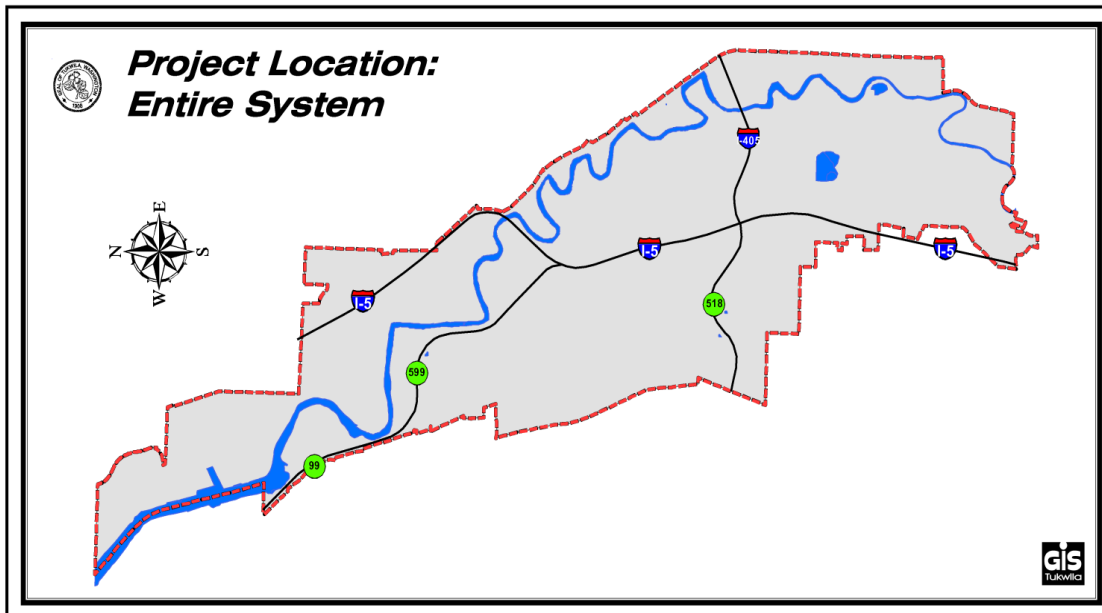



NOTICE OF COMPLETION OF PUBLIC WORKS CONTRACT

Department Use Only	
Assigned to:	Date Assigned:

Date 12/22/2022	Form Version Original	Revision Reason
-----------------	-----------------------	-----------------

Awarding Agency Information		Prime Contractor Information	
Name TUKWILA, CITY OF	UBI 179000208	Name TITAN EARTHWORK LLC	UBI 602605763
Address 6300 S CENTER BLVD #101 TUKWILA,WA-98188		Address 1585 Valentine Ave SE Pacific,WA-98047	
Email Address sherry.edquid@tukwilawa.gov		Email Address nick.seeley@titaneearth.com	
Contact Name SHERRY EDQUID	Phone 206-431-1065 x_____	Contact Name TITAN EARTHWORK LLC	Phone 253-255-4308

Project Information			
Project Name 2021 Small Drainage Program		Contract # 92041201	Affidavit ID 1108644
Jobsite Address 9 locations throughout the City of Tukwila			
Date Awarded 08/16/2021	Date Work Commenced 09/11/2021	Date Work Completed 05/18/2022	Date Work Accepted 05/18/2022
Federally Funded Transportation Project <i>If yes, attach Contract Bond Statement.</i> <input checked="" type="checkbox"/>			
Bond Waived?	Retainage Waived?	Subcontractors Used? <i>If yes, complete Addendum A.</i> <input checked="" type="checkbox"/>	
Detailed Description of Work Completed Drainage improvements at up to nine (9) locations, all within the City of Tukwila. Specific tasks may include storm conveyance installation, installation of HDPE pipe on slope, CIPP storm pipe lining, removing and protecting trees, utility adjustments, property restoration and other work in accordance with the plans, provisions and specifications.			

DOR Tax Information			
<i>*Right-click on the total field and select Update Field to auto-calculate.</i>			
Contract Amount	\$728,225.00	Liquidated Damages	\$ 0.00
Additions (+)	\$36,244.10	Amount Disbursed	\$764,469.10
Reductions (-)	\$ 0.00	Amount Retained	\$ 0.00
Sub-Total*	\$764,469.10	Other	\$ 0.00
Sales Tax Amount	\$ 0.00	Sales Tax Rate <i>If multiple rates, attach a list.</i>	0.00%
TOTAL*	\$764,469.10	TOTAL*	\$764,469.10
<i>These two totals must be equal.</i>			

Apprentice Utilization Information	
Was Apprentice Utilization Required? <i>If yes, complete this entire section.</i> <input type="checkbox"/>	Engineer's Estimate \$ 0.00
Utilization % 9.77%	Was a Good Faith Effort approved?

Comments

The Disbursing Officer must submit this completed notice immediately after acceptance of the work done under this contract. NO PAYMENT SHALL BE MADE FROM THE RETAINED FUNDS until receipt of all release certificates and affidavits.

Submitting Form: Submit the completed form by email to all three agencies below.



Addendum A: Please List all Subcontractors and Sub-tiers Below

This addendum can be submitted in other formats.

Provide known affidavits at this time. No L&I release will be granted until all affidavits are listed.

Subcontractor's Name:	UBI Number: (Required)	Affidavit ID*
BARRETT'S TRUCKING	604030289	1092223
BECKER BLACKTOP LLC	603135627	1082240
BEN'S DOZER SERVICES INC	601432463	1091457
CALIBER CONCRETE CONST INC	601156625	1101461
DARAMOLA INC	604285334	1101179
ESM CONSULTING ENGINEERS	601799377	1091393
INSITUFORM TECHNOLOGIES LLC	601880220	1104639
MILES SAND & GRAVEL COMPANY	171004760	1096615
OLSON BROTHERS PRO-VAC LLC	602170975	1091991
OLSON BROTHERS PRO-VAC LLC	602170975	1093590
VENTILATION POWER CLEANING INC	578089188	1093013



INFORMATIONAL MEMORANDUM

TO: **Transportation and Infrastructure Services Committee**
 FROM: **Hari Ponnekanti, Public Works Director/ City Engineer**
 BY: **Brittany Robinson, Public Works Grant Analyst**
 CC: **Mayor Ekberg**
 DATE: **March 3, 2023**
 SUBJECT: **Surface Water Fund – Chinook Wind Extension**
Project No. 92341202
King County Open Spaces River Corridors Grant Application

ISSUE

Approve a King County Open Spaces River Corridors (OSRC) grant application for the Chinook Wind Extension Project.

BACKGROUND

Following the Public Works Facility Preferred Master Plan (2019) and the Duwamish Gardens Opportunities for Expansion Concept Plan (2013), this project will develop connecting shoreline habitat and the 'missing trail link' between Duwamish Gardens and Chinook Wind within recently acquired City property.

DISCUSSION

On January 31, 2023, King County opened their call for OSRC projects. The OSRC program goal is to deliver projects that help restore the natural functions of rivers and the benefits they provide to our environment and communities. The grant deadline is March 15, 2023.

FISCAL IMPACT

The City plans to request \$280,000 from the King County OSRC for the design on the Chinook Wind Extension Project. The grant application requires a 20% local city match of \$70,000. The project CIP budget, which comes from the utility fund, is sufficient to cover the cost of the match.

	<u>Grant Award</u>	<u>Fund Source</u>	<u>2023 Budget</u>
OSRC Grant	\$ 280,000	Project CIP	\$150,000
Required Match	<u>70,000</u>		
Total	\$ 350,000		

RECOMMENDATION

Committee is being asked to approve a King County OSRC grant application in the amount of \$280,000 for the Chinook Wind Extension Project.

Attachment: 2023 CIP Page 87

CITY OF TUKWILA CAPITAL PROJECT SUMMARY

2023 to 2028

PROJECT: Chinook Wind Extension

Project No. 92341202

DESCRIPTION:

Following the Public Works Facility Preferred Master Plan (2019) and the Duwamish Gardens Opportunities for Expansion Concept Plan (2013), this project will develop connecting shoreline habitat and the 'missing trail link' between Duwamish Gardens and Chinook Wind within recently acquired City property.

JUSTIFICATION:

This is a Tier 1 project in the WRIA 9 Salmon Recovery Plan, fulfilling a core recovery strategy of restoring, protecting and enhancing estuary habitat in the Duwamish River. The trail connection has been discussed in the community for many years and is anticipated to be part of larger, popular shoreline trail.

STATUS:

City takes ownership of the site in 2023.

MAINT. IMPACT:

Passive park elements and restoration plantings will require additional maintenance.

COMMENT:

Grant funding is anticipated to support this project.

FINANCIAL (in \$000's)	Through		Estimated								BEYOND	TOTAL
	2021	2022	2023	2024	2025	2026	2027	2028				
EXPENSES												
Design			150	150	50						350	
Land (R/W)											0	
Monitoring											0	
Const. Mgmt.							160				160	
Construction				0		900					900	
TOTAL EXPENSES	0	0	150	150	50	1,060	0	0	0	0	1,410	
FUND SOURCES												
Awarded Grant											0	
Proposed Grant				150		500					650	
Mitigation Actual											0	
Mitigation Expected											0	
Utility Revenue	0	0	150	0	50	560	0	0	0	0	760	
TOTAL SOURCES	0	0	150	150	50	1,060	0	0	0	0	1,410	

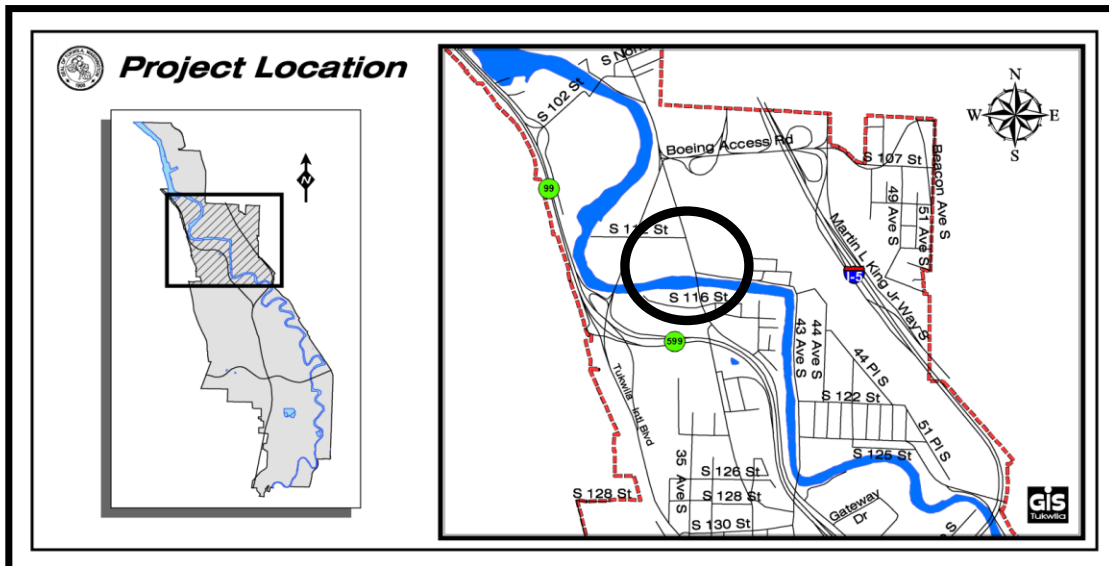



INFORMATIONAL MEMORANDUM

TO: **Transportation and Infrastructure Services Committee**
 FROM: **Hari Ponnekanti, Public Works Director/ City Engineer**
 BY: **Brittany Robinson, Grant Analyst**
 CC: **Mayor Allan Ekberg**
 DATE: **March 3, 2023**
 SUBJECT: **Transportation Element Comprehensive Plan**
Project No. 82010405
Safe Streets & Roads for All Program Grant Application

ISSUE

Accept a Safe Streets & Roads for All (SS4A) program grant award for \$200,000 to develop a Road Safety Plan as part of the Transportation Element of the Comprehensive Plan.

BACKGROUND

On May 2, 2022, Council approved a contract with Fehr & Peers to update the City’s Transportation Element of the Comprehensive Plan. Included in the scope of work is the development of a Road Safety Plan, which is necessary for Tukwila to adopt to remain competitive for future grants, as well as comply with the State’s Target Zero campaign to reduce accidents.

On August 1, 2022, Council authorized staff to submit an application to the SS4A program to fund the development of a city-wide Road Safety Plan. The SS4A program funds projects that significantly reduce or eliminate roadway fatalities and serious injuries through safety action plan development and implementation focused on all users.

DISCUSSION

The City of Tukwila was notified on January 1, 2023 that we received the full grant award for \$200,000 to develop a Road Safety Plan component of the Transportation Element. The grant contract is still being developed, but staff will submit it to the City Attorney for review prior to submitting it to the Mayor for signature. By approving the award now, it will allow staff to move forward with the Road Safety Plan quickly once the contract is received.

FINANCIAL IMPACT

The City has been awarded \$200,000 from the SS4A program. A local City match of \$50,000 is required. The project budget is sufficient to cover the match requirement, which will be provided through Concurrency Test Fees. As the Transportation Element is required by the Department of Community Trade and Economic Development, this grant will significantly lessen the financial burden of the on the general fund.

Road Safety Plan Cost Estimate

SS4A Grant Award	\$200,000
City Match (Concurrency Fees)	<u>50,000</u>
Total	\$250,000

RECOMMENDATION

Council is being asked to accept a Safe Streets & Roads for All (SS4A) program grant award for the Road Safety Plan component of the Transportation Element of the Comprehensive Plan in the amount of \$200,000 and consider this item on the Consent Agenda at the March 20, 2023 Regular Council Meeting.

Attachment: 2023 CIP, page 18

CITY OF TUKWILA CAPITAL PROJECT SUMMARY

2023 to 2028

PROJECT: **Transportation Element of Comprehensive Plan** Project No. 72010405

DESCRIPTION: Update Transportation Element of the Comprehensive Plan to include updated traffic model and street network plan.

JUSTIFICATION: Growth Management Act transportation concurrency and traffic impact mitigations need updated traffic and capital planning. Adoption by 2024 required by Community Trade and Economic Development (CTED).

STATUS: Update every 8 years. Transportation Element will be coordinated with updates to Comprehensive Plan by the Department of Community Development. Next update is scheduled for 2024. (Updated with extended time due to COVID impacts)

MAINT. IMPACT: None.

COMMENT: An update to the Transit Plan and incorporation of the Walk and Roll Plan (non-motorized) are included in the Transportation Element of the Comp Plan update. Also included is a Road Safety Plan.

FINANCIAL (in \$000's)	Through Estimated									TOTAL	
	2021	2022	2023	2024	2025	2026	2027	2028	BEYOND		
EXPENSES											
Design		396	300							650	1,346
Land (R/W)											0
Const. Mgmt.											0
Construction											0
TOTAL EXPENSES	0	396	300	0	0	0	0	0	0	650	1,346
FUND SOURCES											
Awarded Grant											0
Proposed SS4A Grant			240								240
Mitigation											0
Impact Fees											0
Concurrency Fees	0	396	60	0	0	0	0	0	0	650	1,106
TOTAL SOURCES	0	396	300	0	0	0	0	0	0	650	1,346

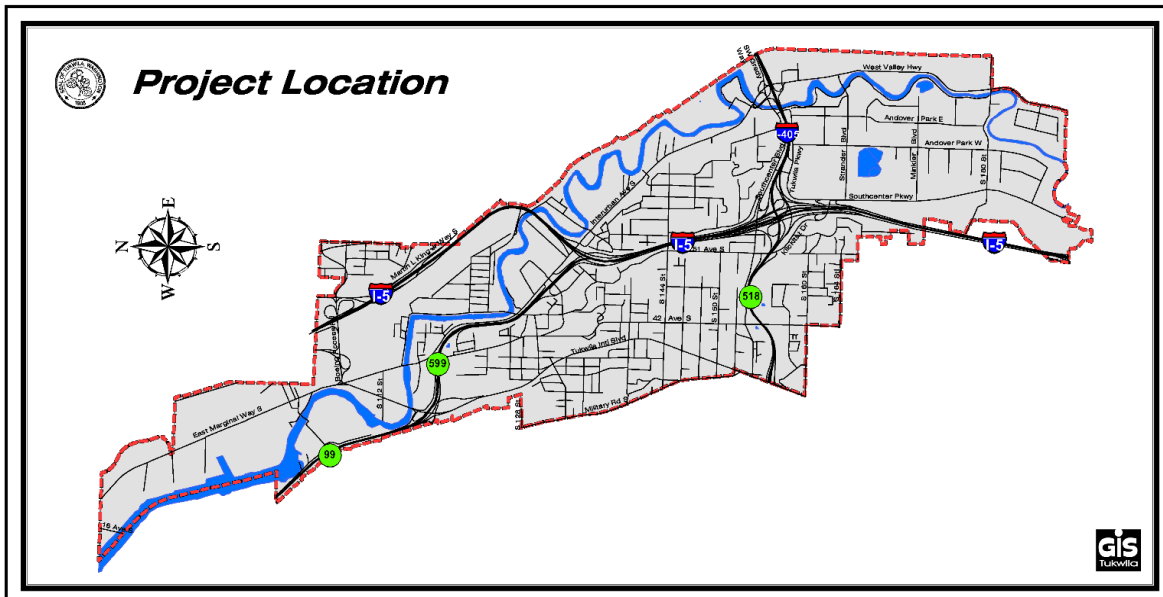



INFORMATIONAL MEMORANDUM

TO: **Transportation and Infrastructure Services Committee**
FROM: **Hari Ponnekanti, Public Works Director/City Engineer**
BY: **Mark Hafs, EIS Project Director**
DATE: **March 3, 2023**
SUBJECT: **Allentown Truck Reroute EIS**
Project No. 92110405
Outreach Update

ISSUE

Provide an update on the Allentown Truck Reroute EIS scoping process and outreach.

BACKGROUND

Truck Traffic accessing the Burlington Northern Santa Fe Railroad (BNSF) multi-modal facility causes adverse effects in the Allentown community such as noise, vibration, vehicle emissions, surface water pollution, and unsafe conditions for pedestrians and bicyclists.

An EIS is required by the State Environmental Policy Act (SEPA). It will help identify potential alternatives, determine how they might impact the project area and the people in it, and select alternatives that best achieve project goals. The process is focused on making project decision open and transparent, and ensuring that documents prepared as part of the EIS are clear and understandable to members of the public and stakeholders who want to review and comment on project planning and design.

In 2021, Council voted to fund an EIS that would consider alternative routes that would reduce the level of impacts of truck traffic in Allentown.

DISCUSSION

The first step of the EIS process is to gather feedback from residents, businesses, and the greater community to learn about their needs, desires, and concerns, and places and things in the project area that they value and want to protect.

A Determination of Scoping Notice begins a 30-day public comment period during which residents, stakeholders, and agencies comment on potential truck reroute alternatives and what they believe the EIS should be analyzing. The 30-day comment period for the scoping notice and determination of significance began on February 14, 2023 and an open house was held on February 28, 2023, at 5:30 pm, at the Tukwila Community Center to provide residents and other stakeholders an opportunity to provide public comment in-person.

Public comment can still be provided by email at AllentownTruckReRoute@TukwilaWA.gov or via a survey that can be mailed to the City. The survey can be found on the project website at www.TukwilaWA.gov/Allentown. Public and stakeholder comments are due by 5:00 p.m., March 15, 2023.

At the end of the scoping period, our consultant team at HDR will take the community feedback they've gotten and use it to help narrow down the alternatives to be further studied. Throughout the EIS process, City staff and HDR will continue to have forums for community input as initial draft alternatives are being considered, including a second open house where the community will have a chance to look at and comment on the project engineers' initial draft for truck reroute alternatives.

FINANCIAL IMPACT

	<u>Cost Estimate</u>	<u>Consultant Budget</u>
HDR Contract	\$ 796,274.00	\$1,000,000.00
Expended to date	<u>10,595.06</u>	
Remaining	\$ 785,678.94	

RECOMMENDATION

Discussion only.

ATTACHMENT: 2023 CIP, Page11
Project Schedule
Environmental Review Process Handout

CITY OF TUKWILA CAPITAL PROJECT SUMMARY

2023 to 2028

PROJECT: Allentown Truck Reroute

Project No. 92110405

DESCRIPTION: Preparation of an Environmental Impact Statement (EIS) that will consider rerouting the freight truck traffic that currently uses surface streets in Tukwila’s Allentown neighborhood to access BNSF Railway Company’s South Seattle Intermodal Facility.

JUSTIFICATION: The City has committed to addressing the Allentown community’s ongoing concerns about the adverse effects of truck traffic from BNSF’s intermodal facility on the Allentown neighborhood – e.g. noise, vibration, truck emissions, and the safety of pedestrians and bicyclists.

STATUS: In 2021, City Council allocated \$1.2 Million for the EIS. Using that budget, the City hired a project manager, who has reviewed documentation from the City’s past truck reroute efforts for Allentown, established a working relationship with the Allentown community, and coordinated the hiring of a consultant team. Consultant work on the project is expected to begin in October of 2022, and will take approximately 18 to 24 months to complete.

MAINT. IMPACT: Because the project is an environmental study, no maintenance impacts are expected.

COMMENT: The project has been coordinated with other City efforts in Allentown, including the 42nd Ave. S Bridge replacement, the Allentown traffic calming project, and overlay work. Discussion of these efforts has been included in regular community engagement meetings at the TCC to ensure a regular flow of information to Allentown residents and businesses, and to encourage public buy-in of City projects.

FINANCIAL (in \$000's)	Through Estimated									TOTAL
	2021	2022	2023	2024	2025	2026	2027	2028	BEYOND	
EXPENSES										
Design	-	300	900							1,200
Land (R/W)										0
Const. Mgmt.										0
Construction										0
TOTAL EXPENSES	0	300	900	0	0	0	0	0	0	1,200
FUND SOURCES										
Awarded Grant										0
Proposed Grant										0
Mitigation Actual BNSF										0
Mitigation Expected										0
Council Allocation	0	300	900	0	0	0	0	0	0	1,200
TOTAL SOURCES	0	300	900	0	0	0	0	0	0	1,200

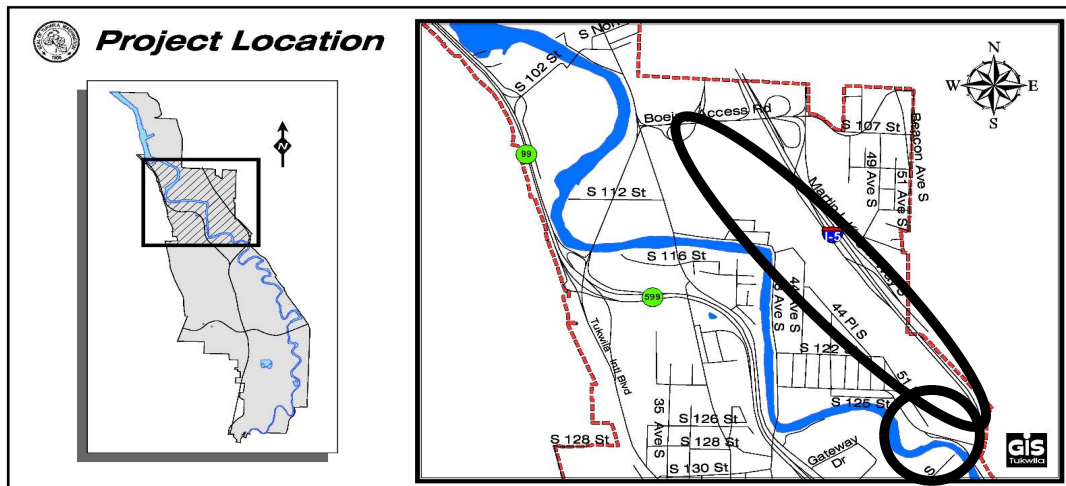

Project Schedule- Allentown EIS





ALLENTOWN TRUCK REROUTE PROJECT ENVIRONMENTAL REVIEW PROCESS

FREQUENTLY ASKED QUESTIONS:

How can community members be involved in this process?

Leave a scoping comment! The formal EIS scoping comment period is **February 14, 2023 to March 15, 2023**.

During this time, we invite you to share your input on what issues and alternatives we should analyze in the EIS. There are multiple ways to provide a comment:

In-person – Submit your comment in-person during today’s community meeting.

Submit an online comment form on our project website.

Email your comment to AllentownTruckReRoute@TukwilaWA.gov.

Mail your comment to Mark Hafs
6300 Southcenter Blvd. Suite 200
Tukwila, WA 98188

Mailed comments must be postmarked by March 15, 2023

Can I submit more than one scoping comment?

Yes, submit your scoping comments between February 14, 2023 and March 15, 2023.

Does the City of Tukwila have a preferred alternative to reroute traffic?

The City has no preferred option for alternative access to BNSF’s facility.

Will we hear updates while the Draft EIS is being produced?

Yes, periodic updates will be issued via the project update email. You can join the project email list on our website. Scan the QR code on the front cover.

Does the EIS only analyze current alternatives, or will new alternatives be considered?

Previously considered alternatives as well as new alternatives are up for consideration in the Draft EIS. Alternatives will be determined through a two-step scoping process. During the first scoping period, which will occur from February 14, 2023 to March 15, 2023, we are asking for input on ideas for alternatives to be considered in the EIS. A second scoping period, which is expected around May 2023, will request input on the proposed set of alternatives. Following the second scoping period, the final set of alternatives will be developed for inclusion in the Draft EIS.

Are other agencies, like King County, Sound Transit, etc., notified about the scoping process?

The scoping notice has been advertised in the Seattle Times and published in the Washington State Environmental Policy Act (SEPA) Register. It has also been distributed to select agencies who might have an interest in the project.

How is the Environmental Impact Statement (EIS) being funded?

City funds will cover the cost of the EIS.

OVERVIEW

The City of Tukwila is preparing an Environmental Impact Statement (EIS) to evaluate alternatives to reroute existing BNSF truck traffic in Allentown

An EIS is a process to evaluate potential effects that a proposal may have on the built and natural environment. The first step in the EIS is called scoping. Scoping is where we ask you to share your input on what issues and alternatives should be analyzed in the EIS. Per State Environmental Protection Act (SEPA) guidelines, all formal comments must be **written and submitted within the formal scoping comment period**.



The formal EIS scoping comment period is February 14th through March 15th. Here are ways you can provide input:

COMMENT OPTIONS



In-person – Submit your comment in-person during today’s community meeting.



Submit an online comment form on our project website.



Email your comment to AllentownTruckReRoute@TukwilaWA.gov.



Mail your comment to Mark Hafs
6300 Southcenter Blvd. Suite 200,
Tukwila, WA 98188

Mailer comments must be postmarked by March 15, 2023

Scan QR code to learn more and leave a comment!



PURPOSE AND NEED

The purpose and need for this project is to develop an alternative route to the BNSF Intermodal Facility in Allentown to improve livability and safety in Allentown, without compromising the operations of the intermodal facility.

PROJECT HISTORY

- BNSF's South Seattle Intermodal Facility is located on the east side of the Allentown neighborhood. For many years, trucks traveling to and from the BNSF facility have accessed it mainly via a route that uses 42nd Ave. S (over the 42nd Ave. S Bridge) and S 124th Street.
- In 2015, the City undertook a study to find a new truck route that would reduce the impacts of trucks in Allentown. The *BNSF Railway Intermodal Facility Access Study* was completed in late 2016.
- The study proposed four alternative truck routes that would not travel through Allentown, and one alternative that considered the impacts of leaving the current truck route in place.
- As part of the study, the City held open houses where the public gave input about the needs of the Allentown community and commented on the proposed truck route alternatives.
- Using the 2016 study as a starting point, the City will now prepare an environmental impact statement (EIS) which will take a more in-depth look at the truck route options identified in the 2016 study, and update the study's findings to include today's conditions, improved project understanding, and additional community input.
- Moving forward with work on the EIS, the City is committed to clear and open communication with the public – of its findings, its intentions, and its actions.

EIS PROCESS

WE ARE HERE

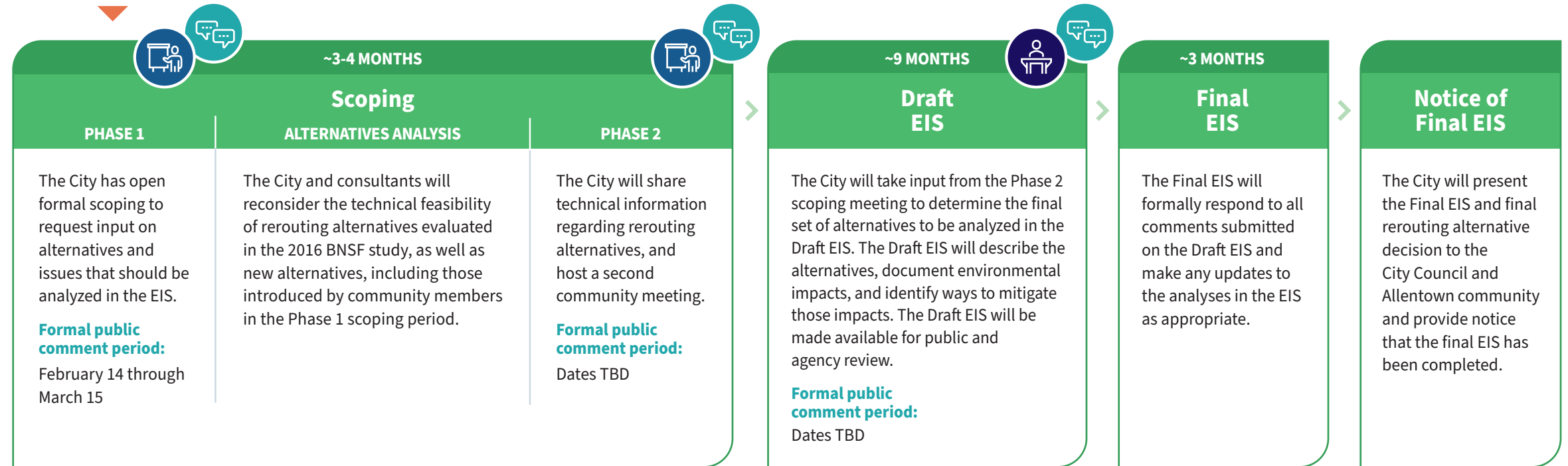

STUDY AREA



TOPICS CURRENTLY BEING CONSIDERED

- ✓ **PHYSICAL ENVIRONMENT**
Climate, geology, soil type and distribution, groundwater characteristics, air quality, and noise levels
- ✓ **BIOLOGICAL ENVIRONMENT**
Location and distribution of flora and fauna, wildlife characteristics
- ✓ **SOCIO-ECONOMIC AND HEALTH CONDITIONS**
Demography, culture, heritage sites, social and health status of the people and their environment

WHAT MAKES A GOOD EIS COMMENT?

- Tell us about resources you'd like to protect and valuable sites in your community
- Be specific about issues and locations
- Write legibly
- All EIS comments must be written

All formal comments received during the formal comment period will be documented. The formal EIS scoping comment period is February 14, 2023 to March 15, 2023.

Share your input on what issues and alternatives should be analyzed in the EIS by March 15th.

